



# TANDEMBOX

Deluxe Metal Drawer System

[blum.com](https://blum.com)

 **blum**<sup>®</sup>



# One system. Countless possibilities.

This metal box system opens a world of design possibilities. The gray sides of TANDEMBOX can attach to any style front, giving cabinets their own unique look. With a variety of different applications from top and deep drawers to sink solutions, TANDEMBOX can accommodate all areas of the kitchen.

Our tried-and-tested TANDEMBOX drawers open smoothly and gently, even fully loaded. Full extension runners make finding what you need easier, and drawers close softly with our integrated BLUMOTION soft close technology.





## Contents

### TANDEMBOX

|    |   |
|----|---|
| 4  | Testing Standards                                 |
| 5  | Easy Adjustments                                  |
| 6  | Design and Features                               |
| 7  | Additional Information                            |
| 8  | Program Overview                                  |
| 10 | Using the Catalog                                 |
| 11 | Drawer Assembly                                   |
| 12 | M Height Drawer                                   |
| 16 | B Height with Single Gallery                      |
| 20 | D Height with Single Gallery                      |
| 24 | M Height Interior Roll-out                        |
| 28 | D Height with Single Gallery Interior<br>Roll-out |
| 32 | Dual Sink Drawer                                  |
| 34 | Waste/recycle Set                                 |
| 36 | Assembly Aids                                     |
| 40 | Machines  |
| 42 | Accessories                                       |
| 46 | ORGA-LINE   |
| 48 | Part Number Index                                 |



### ANSI/BHMA Testing Standards

What is shown in the brochure is based on ANSI/BHMA standards.

- 100 lb static, 90 lb dynamic for TANDEMBOX 578 series

### Blum's Testing Standards

Blum, Inc. is ISO 9001 certified, which means that you can be assured of consistent quality in every Blum product. All Blum runners must pass these tests without showing a measurable reduction in performance or deviation in adjustment position. Testing standards vary between products and applications.

All Blum runners meet or exceed ANSI/BHMA 156.9 grade 1 requirements.

Contact your local Blum representative for more details.

#### Dynamic wear test

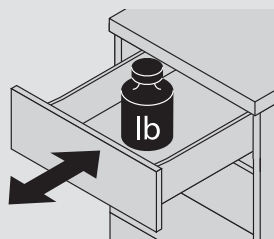

100,000 open/close cycles with a total load of 75 lb on TANDEMBOX 378 drawer.

#### Static load test

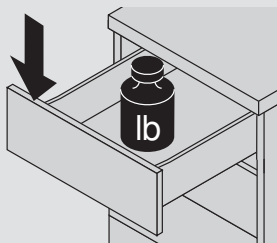

10 times for 10 seconds each time when completely extended, 66 lb is applied to the corner of the drawer front of a fully loaded drawer.

#### Side pressure test

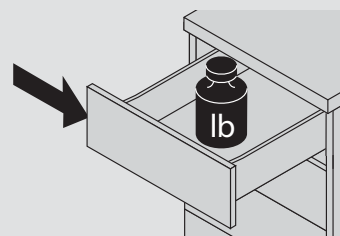

10 times for 10 seconds each time when completely extended, 44 lb is applied to the side of the drawer front of a fully loaded drawer.



### General Information

All Blum hardware undergoes strict quality control procedures through all stages of production. Blum hardware is designed for cabinets and cabinet components made from wood, melamine or MDF. Careful attention must be paid to installation and operating instructions when using Blum hardware (see catalogs and instruction sheets for all technical information). The manufacturer must decide on the screws or attachment methods to suit the material being used (i.e. wood, melamine, etc.). The hardware must not be exposed to acidic or corrosive materials (i.e. some household cleaning solutions). To ensure that Blum hardware functions correctly, it must be kept clean and undamaged. For any additional information please contact your Blum representative. Anyone selling Blum hardware must ensure that their customer is aware of any relevant information given in this catalog. Care and cleaning – use a clean damp cloth.

### Conditions of Sale and Delivery

All deliveries and services are based on the "general conditions of sale" which are available upon request. The technical presentations and dimensions in illustrations are non-binding. We reserve the right to make changes to specifications at any time. We do not accept any responsibility for any errors which may occur in the production of this catalog.



### Easy Adjustment with Just A Few Turns

One of the many benefits of the TANDEMBOX system is the fully integrated three-dimensional adjustment mechanism. Height, side and front removal can be made easily through the opening in the drawer side beneath the cover cap.

For drawers with gallery rails, tilt adjustment can be achieved by an adjustment at the end of the rail. Additionally, the drawer front can also be removed quickly with just a turn.

### Adjustment for TANDEMBOX – M and Gallery Drawers

#### Height Adjustment

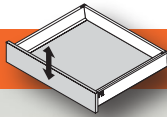

#### Tilt Adjustment

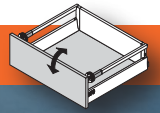

#### Side Adjustment

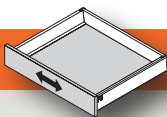

#### Front Removal

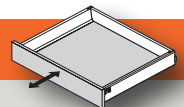

**Elegant Drawer Side Finish**

The drawer sides are available in a stylish gray finish, which include color coordinated cover caps.

**BLUMOTION**

All TANDEMBOX profiles have integrated BLUMOTION soft close technology, creating an unsurpassed opening and closing experience. BLUMOTION adapts to different weights and closing forces to give a smooth and silent close every time. Whether it is a small top drawer or a wide deep drawer, BLUMOTION guarantees the soft close you have come to expect from Blum.

**SERVO-DRIVE**

SERVO-DRIVE is an opening feature for TANDEMBOX. Drawers open automatically with just a touch of the drawer front or with a light pull of the handle. This unique feature is based on an electrical drive unit that, once activated, opens the drawer for you. For ordering information please visit [blum.com](https://blum.com) to download the SERVO-DRIVE brochure (LIT.SDR1000).





### Online Resource for Planning

#### Easy Planning

Blum offers many online tools to help you with your kitchen planning and ordering. Online Product Configurator (OPC) offers a parts list and planning information based on your specifications. Once complete, your results can then be exported to a shareable document.

OPC is easily accessible on our website at [blum.com/configurator](https://blum.com/configurator)



### Connect With Us on Social Media

Be sure to connect with us on social media for additional resources for information regarding tips on installation, maximizing storage space, new products and other news and events going on inside Blum.

Find us by searching "Blum Inc" in the search bar.

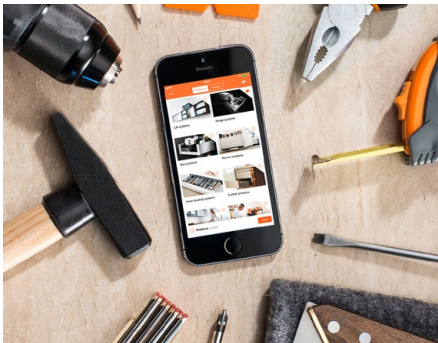

### EASY ASSEMBLY App

The Blum EASY ASSEMBLY App makes assembling and installing Blum products easy.

With a quick download on your mobile device, Blum's EASY ASSEMBLY App is a helpful reference tool that uses instruction sheets and videos to clearly show step-by-step directions for every product. Whether you are in the cabinet shop or on the jobsite, the EASY ASSEMBLY App is at your fingertips whenever you need it.

### M Height

pages 12 - 15



### D Height with Single Gallery

pages 20 - 23



### B Height with Single Gallery

pages 16 - 19



### D Height with Single Gallery Interior Roll-out

pages 28 - 31



### M Height Interior Roll-out

pages 24 - 27



## Special Applications

### Dual Sink Drawer

pages 32 - 33



### Waste/recycle Set with SERVO-DRIVE

pages 34 - 35







**TANDEMBOX**



## Using the Catalog

## Application Page

Provides details of the application and an overview of the parts that make up the drawer.

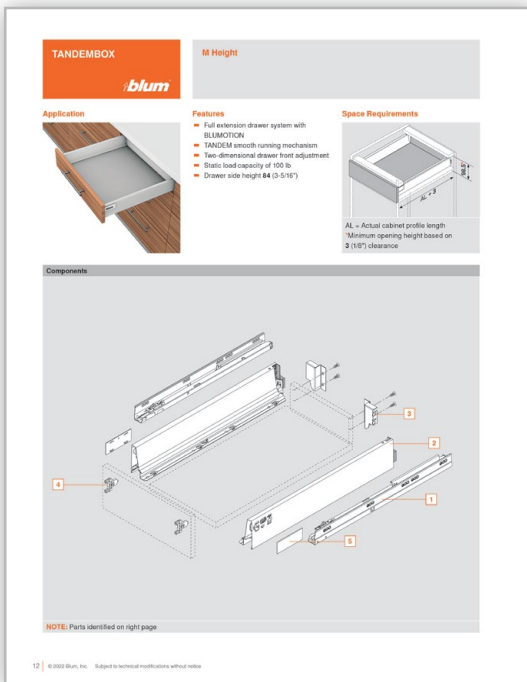

## Required Parts

Contains all necessary components with part numbers listed to order the drawer.

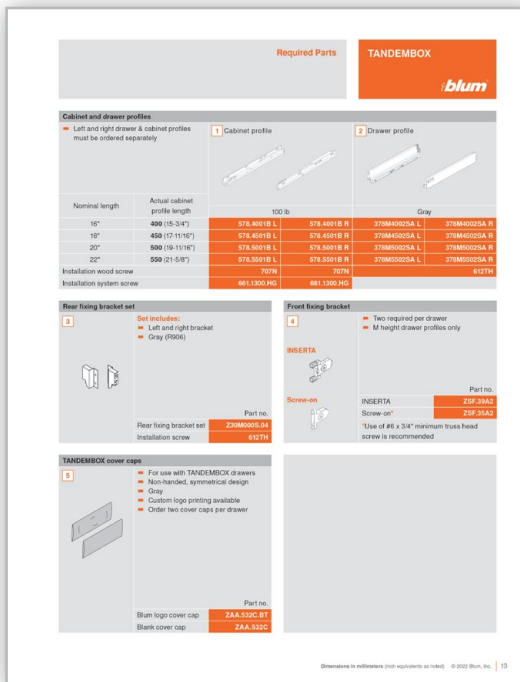

## Installation Dimensions

Cabinet profile installation and cutting dimensions for the bottom and back of the drawer.

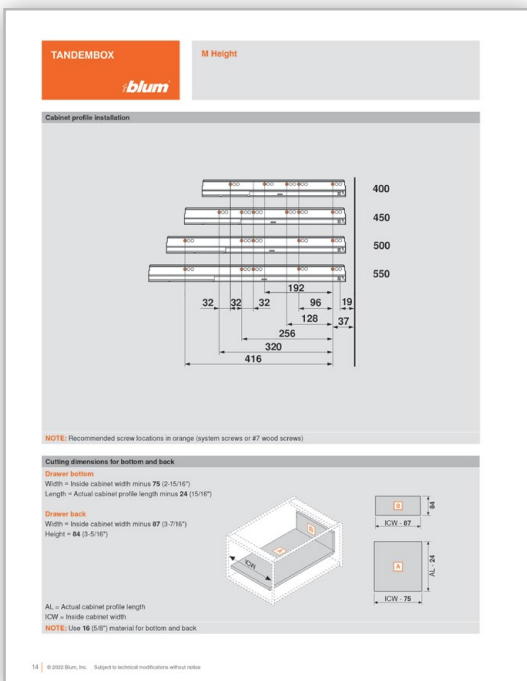

## Specifications

Front and rear fixing bracket installation specifications.

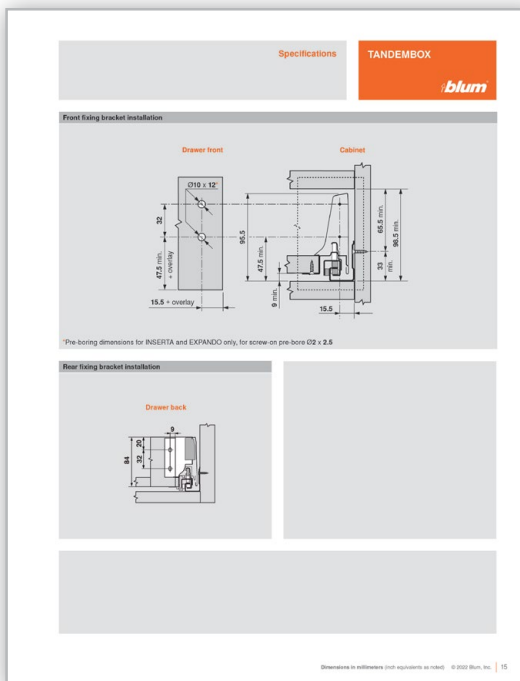



## Step 1

### Measure inside cabinet width

Use inside cabinet width (ICW) to calculate the drawer bottom and back dimensions. Formulas are found on the specification page of each application.

#### M height example:

- A** Drawer bottom: Width = Inside cabinet width minus **75** (2-15/16")  
Length = Actual cabinet profile length minus **24** (15/16")
- B** Drawer back: Width = Inside cabinet width minus **87** (3-7/16")  
Height = **84** (3-5/16")

**NOTE:** Minimum inside cabinet width = **125** (4-15/16")

Use **16** (5/8") material for drawer bottom and back

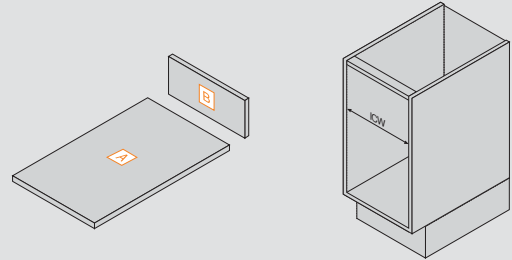

## Step 2

### Attach drawer back

Rear fixing brackets are attached with #6 x 1/2" truss head screws (612TH). The drawer back, with rear fixing brackets attached, snaps into the rear of both drawer profiles.

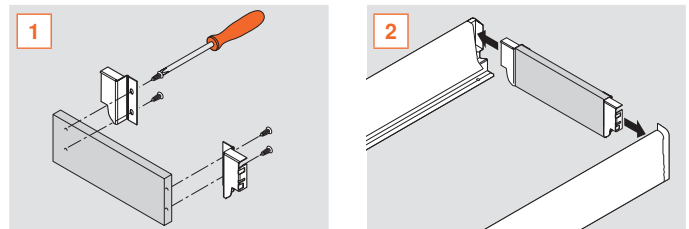

## Step 3

### Slide drawer bottom into drawer sides

The drawer bottom slides into the drawer profiles.

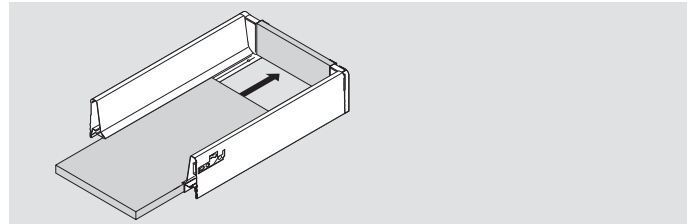

## Step 4

### Attach drawer front

Follow the installation drawing for locating hole positions for front fixing brackets (and optional gallery rods if used) and pre-bore the necessary INSERTA Ø10 x 12 holes (screw-on versions also available). Attach front fixing brackets and snap drawer front onto drawer.

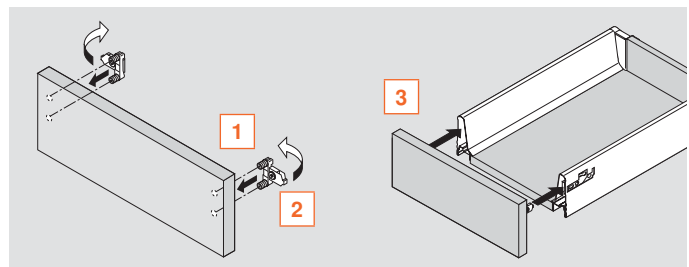

## Step 5

### Attach drawer bottom with screws

Push the drawer bottom flush with the front of the drawer. Pre-bore and attach with wood screws (612TH).

Attach cover caps to drawer side.

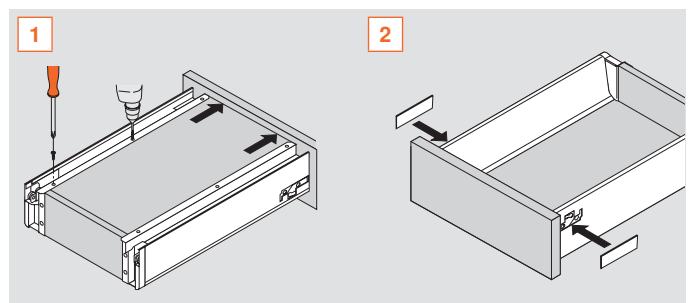

# TANDEMBOX



## M Height

### Application



### Features

- Full extension drawer system with BLUMOTION
- TANDEM smooth running mechanism
- Two-dimensional drawer front adjustment
- Static load capacity of 100 lb
- Drawer side height 84 (3-5/16")

### Space Requirements

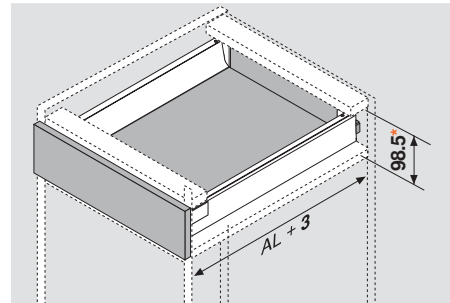

AL = Actual cabinet profile length  
 \*Minimum opening height based on  
 3 (1/8") clearance

### Components

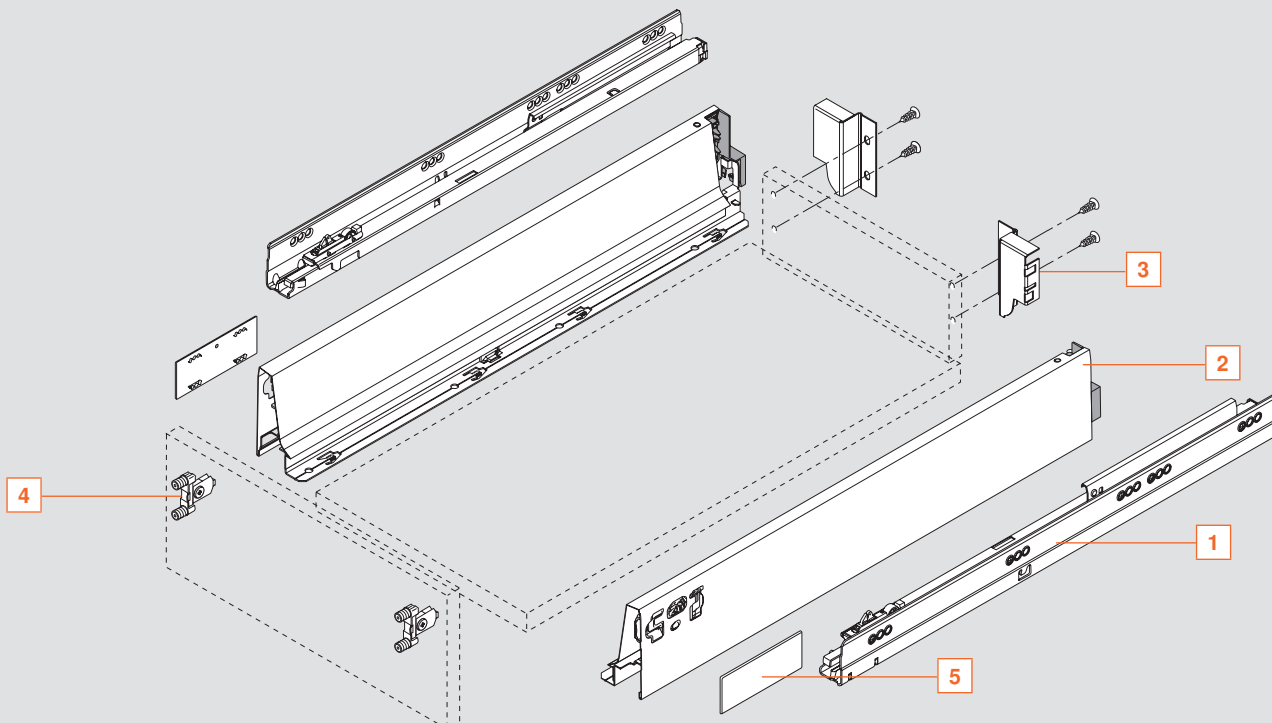

**NOTE:** Parts identified on right page



## Required Parts

## TANDEMBOX



### Cabinet and drawer profiles

- Left and right drawer & cabinet profiles must be ordered separately

#### 1 Cabinet profile

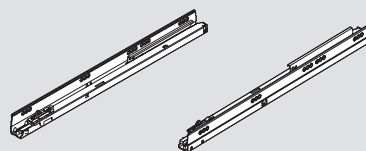

100 lb

#### 2 Drawer profile

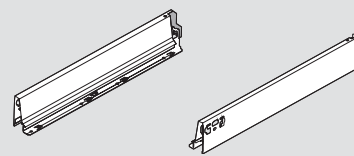

Gray

| Nominal length            | Actual cabinet profile length | 100 lb      |             | Gray         |              |
|---------------------------|-------------------------------|-------------|-------------|--------------|--------------|
| 16"                       | 400 (15-3/4")                 | 578.4001B L | 578.4001B R | 378M4002SA L | 378M4002SA R |
| 18"                       | 450 (17-11/16")               | 578.4501B L | 578.4501B R | 378M4502SA L | 378M4502SA R |
| 20"                       | 500 (19-11/16")               | 578.5001B L | 578.5001B R | 378M5002SA L | 378M5002SA R |
| 22"                       | 550 (21-5/8")                 | 578.5501B L | 578.5501B R | 378M5502SA L | 378M5502SA R |
| Installation wood screw   |                               | 707N        | 707N        | 612TH        |              |
| Installation system screw |                               | 661.1300.HG | 661.1300.HG |              |              |

### Rear fixing bracket set

3

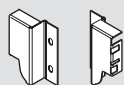

#### Set includes:

- Left and right bracket
- Gray (R906)

Part no.

Rear fixing bracket set **Z30M000S.04**

Installation screw **612TH**

### Front fixing bracket

4

#### INSERTA



#### Screw-on



- Two required per drawer
- M height drawer profiles only

Part no.

INSERTA **ZSF.39A2**

Screw-on\* **ZSF.35A2**

\*Use of #6 x 3/4" minimum truss head screw is recommended

### TANDEMBOX cover caps

5

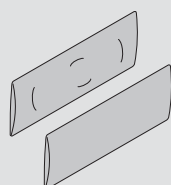

- For use with TANDEMBOX drawers
- Non-handed, symmetrical design
- Gray
- Custom logo printing available
- Order two cover caps per drawer

Part no.

Blum logo cover cap **ZAA.532C.BT**

Blank cover cap **ZAA.532C**

Cabinet profile installation

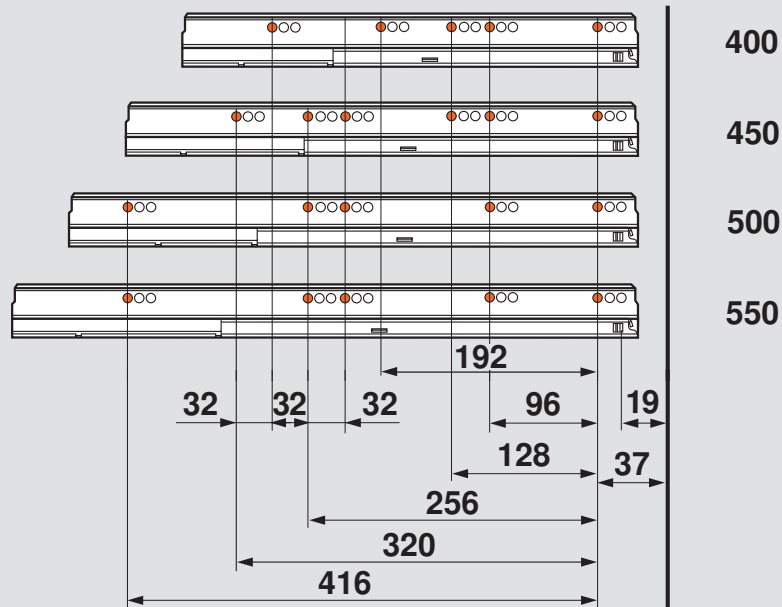

**NOTE:** Recommended screw locations in orange (system screws or #7 wood screws)

Cutting dimensions for bottom and back

**Drawer bottom**

Width = Inside cabinet width minus **75** (2-15/16")

Length = Actual cabinet profile length minus **24** (15/16")

**Drawer back**

Width = Inside cabinet width minus **87** (3-7/16")

Height = **84** (3-5/16")

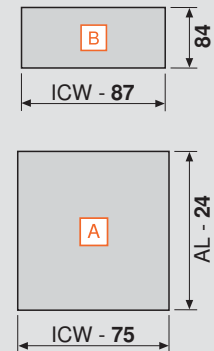
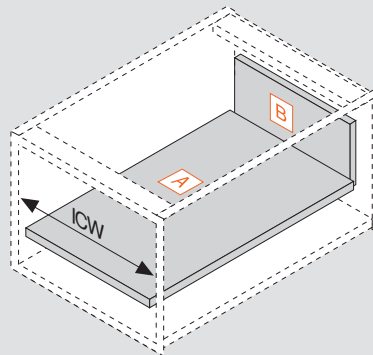

AL = Actual cabinet profile length

ICW = Inside cabinet width

**NOTE:** Use **16** (5/8") material for bottom and back

## Front fixing bracket installation

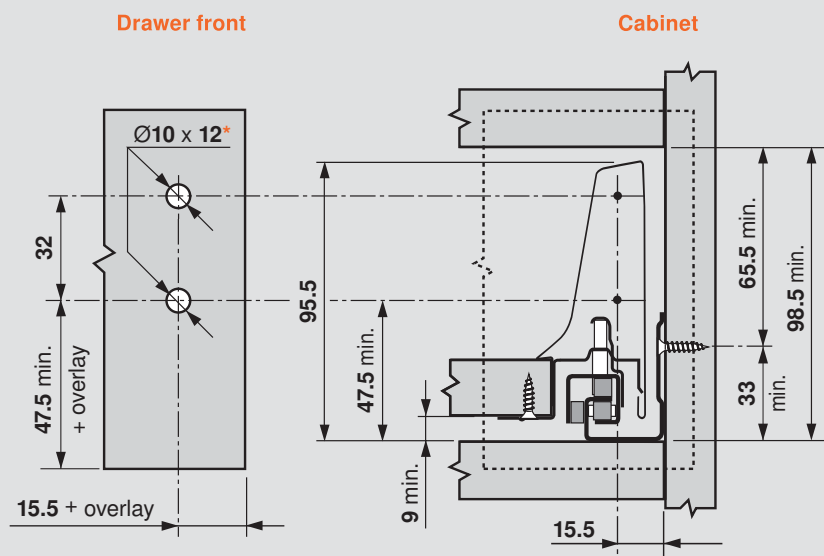

\*Pre-boring dimensions for INSERTA and EXPANDO only, for screw-on pre-bore Ø2 x 2.5

## Rear fixing bracket installation

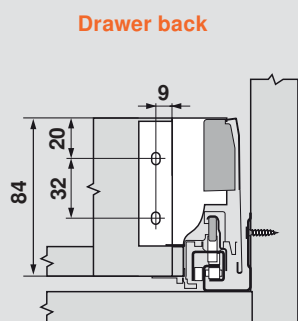



# TANDEMBOX



## B Height with Single Gallery

### Application

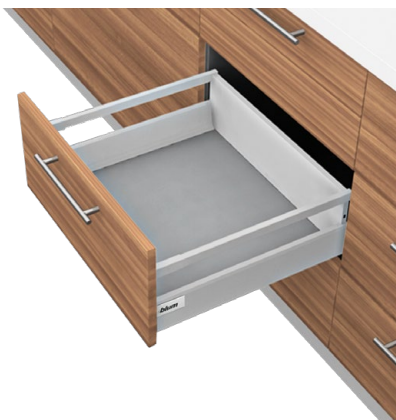

### Features

- Full extension drawer system with BLUMOTION
- TANDEM smooth running action
- Three-dimensional drawer front adjustment
- Static load capacity of 100 lb
- Drawer side height 146 (5-3/4")

### Space Requirements

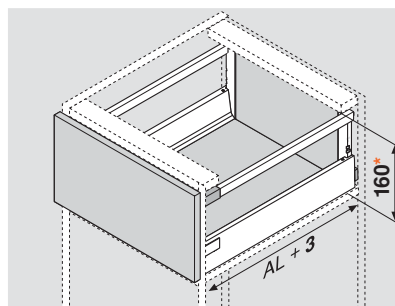

AL = Actual cabinet profile length

\*Minimum opening height based on 3 (1/8") clearance

### Components

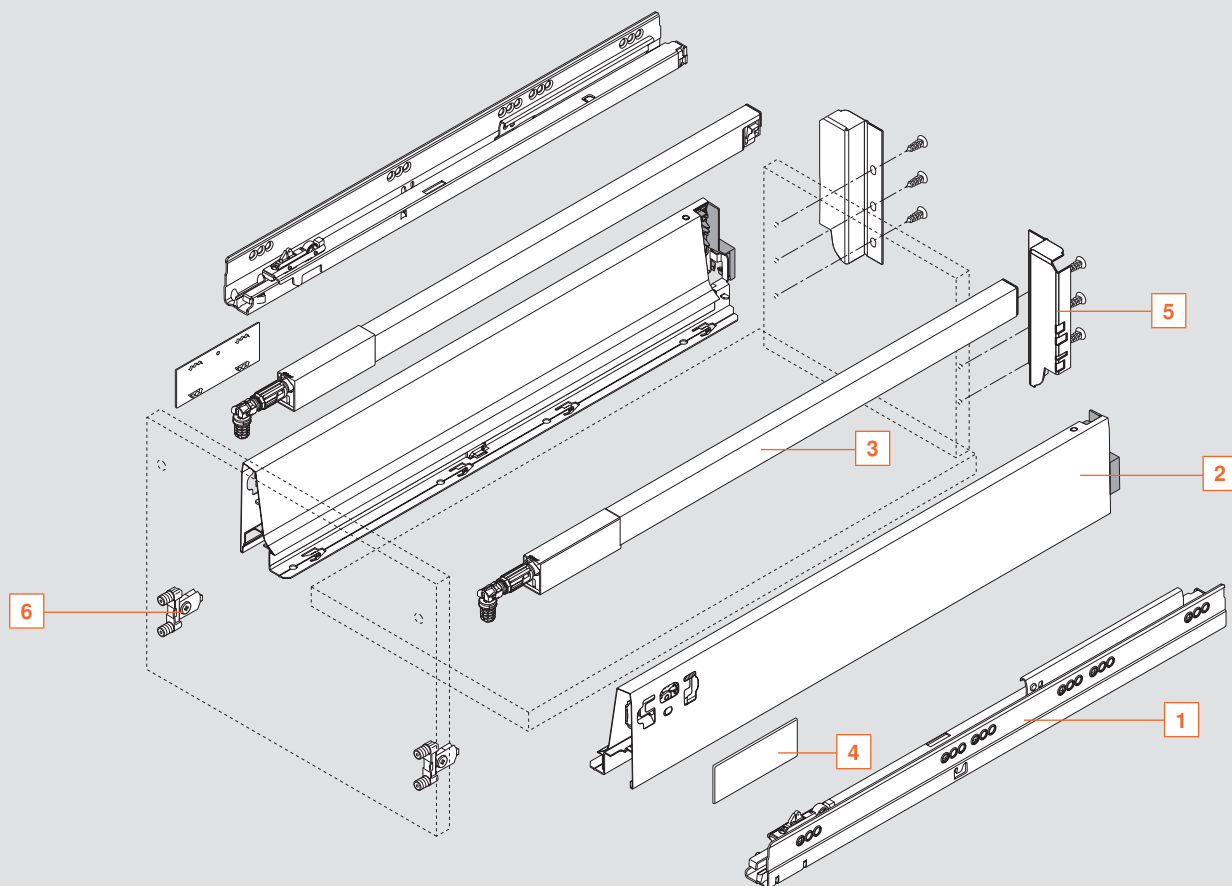

**NOTE:** Parts identified on right page

## Required Parts

## TANDEMBOX



### Cabinet and drawer profiles

- Left and right drawer & cabinet profiles must be ordered separately

#### 1 Cabinet profile

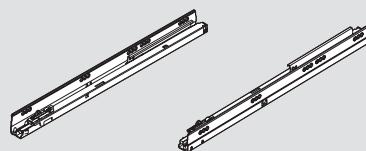

100 lb

#### 2 Drawer profile

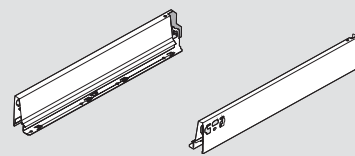

Gray

| Nominal length            | Actual cabinet profile length | 100 lb      |             | Gray         |              |
|---------------------------|-------------------------------|-------------|-------------|--------------|--------------|
| 16"                       | 400 (15-3/4")                 | 578.4001B L | 578.4001B R | 378M4002SA L | 378M4002SA R |
| 18"                       | 450 (17-11/16")               | 578.4501B L | 578.4501B R | 378M4502SA L | 378M4502SA R |
| 20"                       | 500 (19-11/16")               | 578.5001B L | 578.5001B R | 378M5002SA L | 378M5002SA R |
| 22"                       | 550 (21-5/8")                 | 578.5501B L | 578.5501B R | 378M5502SA L | 378M5502SA R |
| Installation wood screw   |                               | 707N        | 707N        | 612TH        |              |
| Installation system screw |                               | 661.1300.HG | 661.1300.HG |              |              |

### Top gallery rails

3

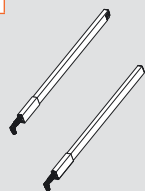

- Left and right gallery rails must be ordered separately

| Actual cabinet profile length | Gray          |               |
|-------------------------------|---------------|---------------|
| 400 (15-3/4")                 | ZRG.337RSIC L | ZRG.337RSIC R |
| 450 (17-11/16")               | ZRG.387RSIC L | ZRG.387RSIC R |
| 500 (19-11/16")               | ZRG.437RSIC L | ZRG.437RSIC R |
| 550 (21-5/8")                 | ZRG.487RSIC L | ZRG.487RSIC R |

### TANDEMBOX cover caps

4

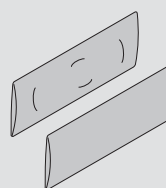

- For use with TANDEMBOX drawers
- Non-handed, symmetrical design
- Gray
- Custom logo printing available
- Order two cover caps per drawer

| Part no.            |             |
|---------------------|-------------|
| Blum logo cover cap | ZAA.532C.BT |
| Blank cover cap     | ZAA.532C    |

### Rear fixing bracket set

5

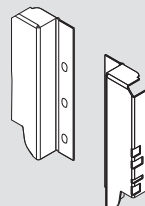

#### Set includes:

- Left and right bracket
- Gray (R906)

| Part no.                |             |
|-------------------------|-------------|
| Rear fixing bracket set | Z30B000S.04 |
| Installation screw      | 612TH       |

### Front fixing bracket

6

#### INSERTA



#### Screw-on



- Two required per drawer
- For use with M height drawer profiles only

| Part no.  |          |
|-----------|----------|
| INSERTA   | ZSF.39A2 |
| Screw-on* | ZSF.35A2 |

\*Use of #6 x 3/4" minimum truss head screw is recommended

Cabinet profile installation

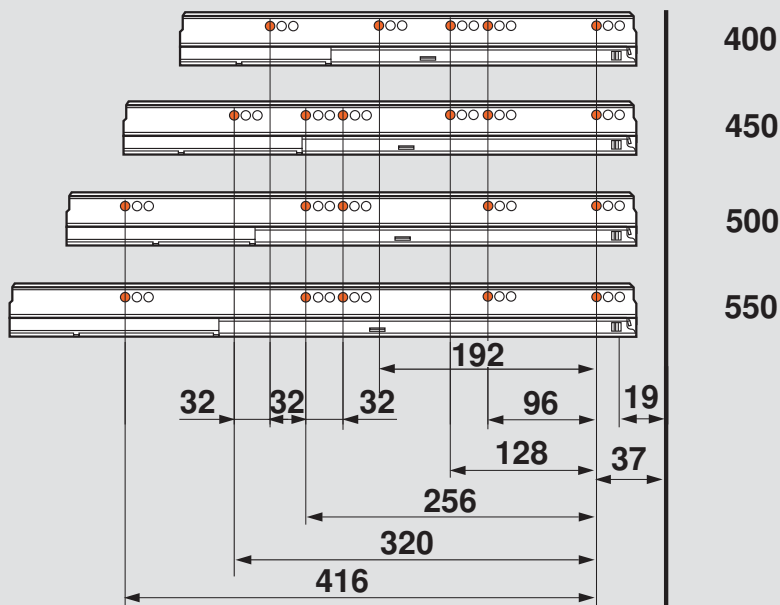

**NOTE:** Recommended screw locations in orange (system screws or #7 wood screws)

Cutting dimensions for bottom and back

**Drawer bottom**

Width = Inside cabinet width minus **75** (2-15/16")

Length = Actual cabinet profile length minus **24** (15/16")

**Drawer back**

Width = Inside cabinet width minus **87** (3-7/16")

Height = **135** (5-5/16")

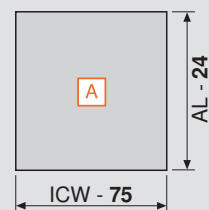
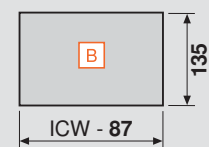
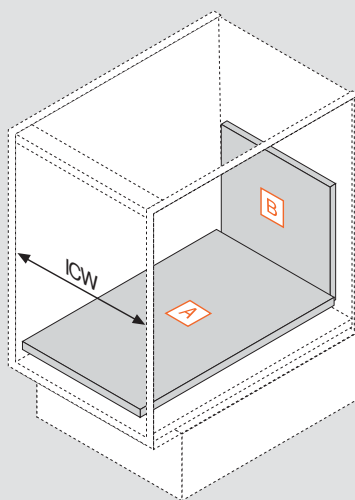

AL = Actual cabinet profile length

ICW = Inside cabinet width

**NOTE:** Use **16** (5/8") material for bottom and back



## Front fixing bracket installation

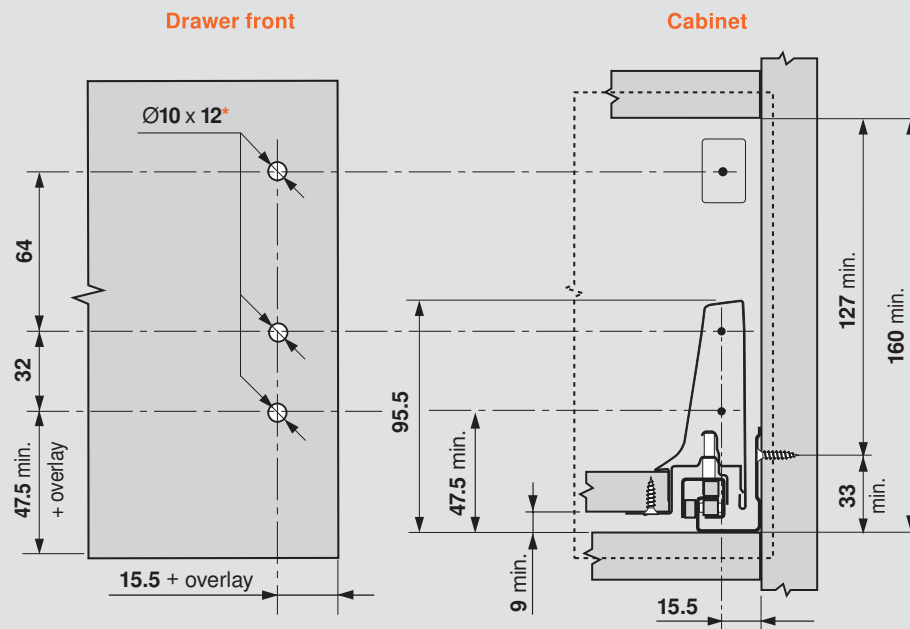

\*Pre-boring dimensions for INSERTA and EXPANDO only, for screw-on pre-bore  $\text{Ø}2 \times 2.5$

## Rear fixing bracket installation

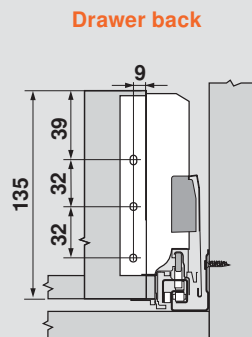

# TANDEMBOX



## D Height with Single Gallery

### Application



### Features

- Full extension drawer system with BLUMOTION
- TANDEM smooth running action
- Three-dimensional drawer front adjustment
- Static load capacity of 100 lb
- Drawer side height **207** (8-1/8")

### Space Requirements

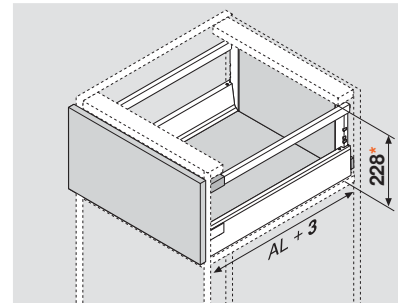

AL = Actual cabinet profile length  
 \*Minimum opening height based on  
**3** (1/8") clearance

### Components

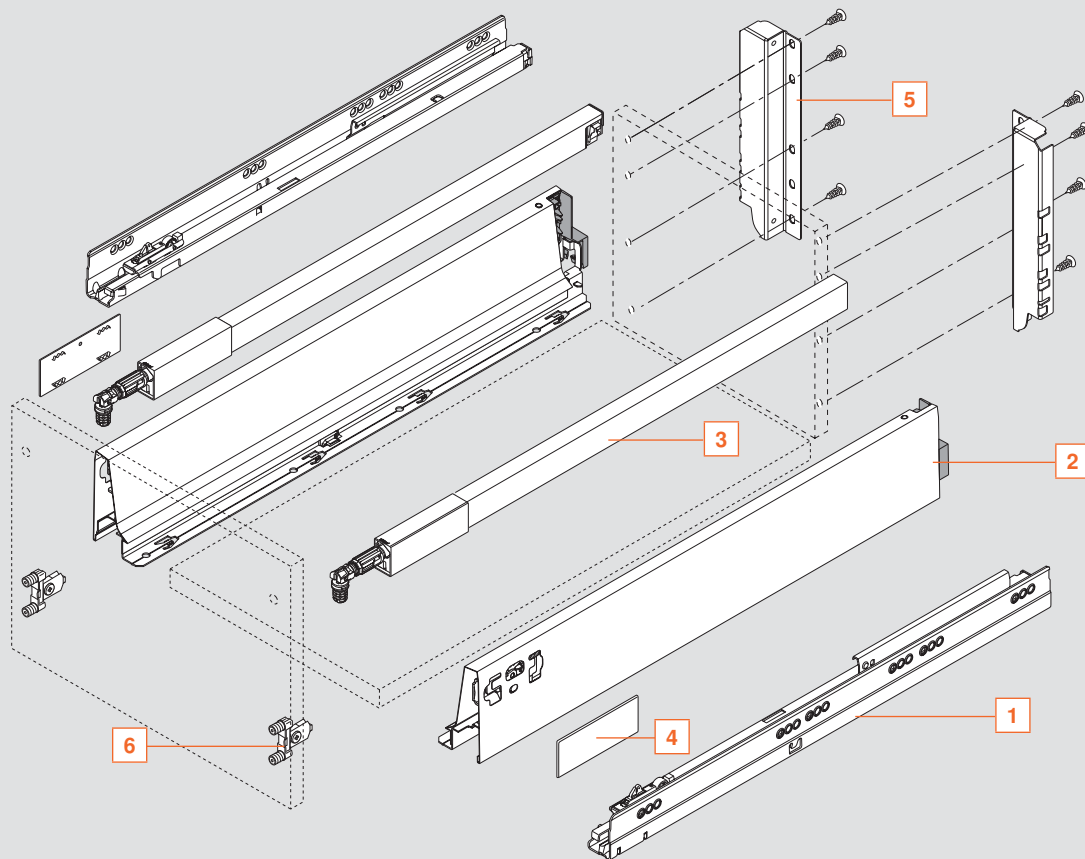

**NOTE:** Parts identified on right page

## Required Parts

## TANDEMBOX



### Cabinet and drawer profiles

- Left and right drawer & cabinet profiles must be ordered separately

#### 1 Cabinet profile

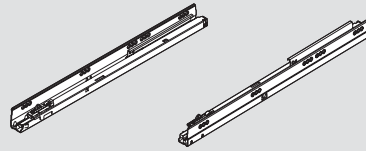

#### 2 Drawer profile

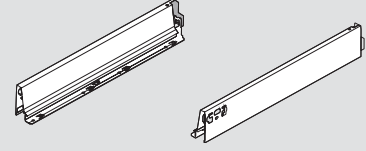

| Nominal length            | Actual cabinet profile length | 100 lb      |             | Gray         |              |
|---------------------------|-------------------------------|-------------|-------------|--------------|--------------|
| 16"                       | 400 (15-3/4")                 | 578.4001B L | 578.4001B R | 378M4002SA L | 378M4002SA R |
| 18"                       | 450 (17-11/16")               | 578.4501B L | 578.4501B R | 378M4502SA L | 378M4502SA R |
| 20"                       | 500 (19-11/16")               | 578.5001B L | 578.5001B R | 378M5002SA L | 378M5002SA R |
| 22"                       | 550 (21-5/8")                 | 578.5501B L | 578.5501B R | 378M5502SA L | 378M5502SA R |
| Installation wood screw   |                               | 707N        | 707N        | 612TH        |              |
| Installation system screw |                               | 661.1300.HG | 661.1300.HG |              |              |

### Top gallery rails

- Left and right gallery rails must be ordered separately

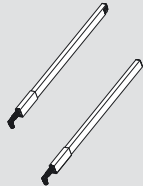

| Actual cabinet profile length | Gray          |               |
|-------------------------------|---------------|---------------|
| 400 (15-3/4")                 | ZRG.337RSIC L | ZRG.337RSIC R |
| 450 (17-11/16")               | ZRG.387RSIC L | ZRG.387RSIC R |
| 500 (19-11/16")               | ZRG.437RSIC L | ZRG.437RSIC R |
| 550 (21-5/8")                 | ZRG.487RSIC L | ZRG.487RSIC R |

### TANDEMBOX cover caps

- For use with TANDEMBOX drawers
- Non-handed, symmetrical design
- Gray
- Custom logo printing available
- Order two cover caps per drawer

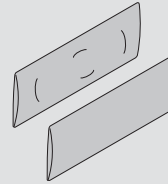

| Part no.            |             |
|---------------------|-------------|
| Blum logo cover cap | ZAA.532C.BT |
| Blank cover cap     | ZAA.532C    |

### Rear fixing bracket set

- Set includes:
  - Left and right bracket
  - Gray (R906)

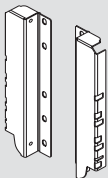

| Part no.                |           |
|-------------------------|-----------|
| Rear fixing bracket set | Z30D000SL |
| Installation screw      | 612TH     |

### Front fixing bracket

- Two required per drawer
- For use with M height drawer profiles only

#### INSERTA



#### Screw-on



| Part no.  |          |
|-----------|----------|
| INSERTA   | ZSF.39A2 |
| Screw-on* | ZSF.35A2 |

\*Use of #6 x 3/4" minimum truss head screw is recommended



Cabinet profile installation

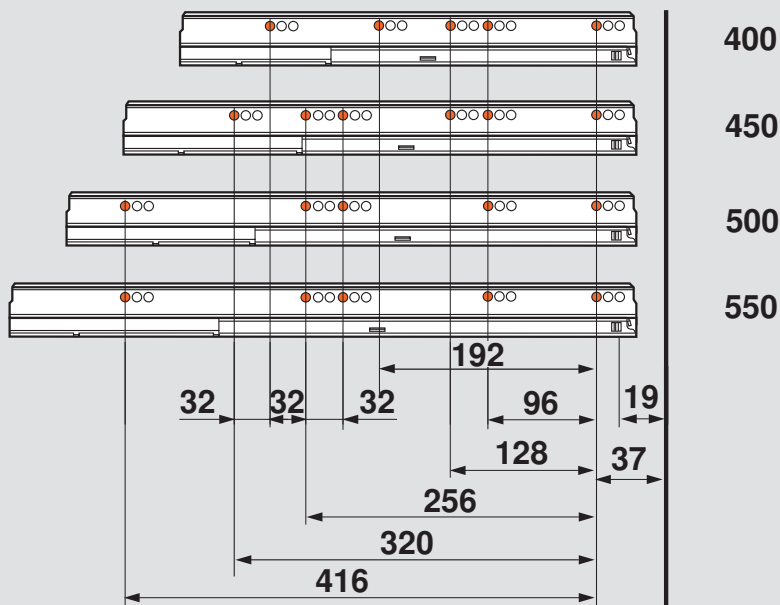

**NOTE:** Recommended screw locations in orange (system screws or #7 wood screws)

Cutting dimensions for bottom and back

**Drawer bottom**

Width = Inside cabinet width minus **75** (2-15/16")

Length = Actual cabinet profile length minus **24** (15/16")

**Drawer back**

Width = Inside cabinet width minus **87** (3-7/16")

Height = **199** (7-13/16")

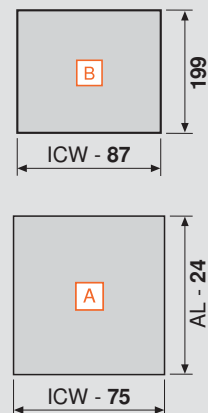
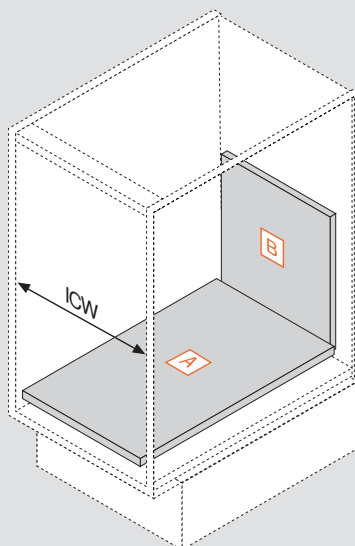

AL = Actual cabinet profile length

ICW = Inside cabinet width

**NOTE:** Use **16** (5/8") material for bottom and back

## Front fixing bracket installation

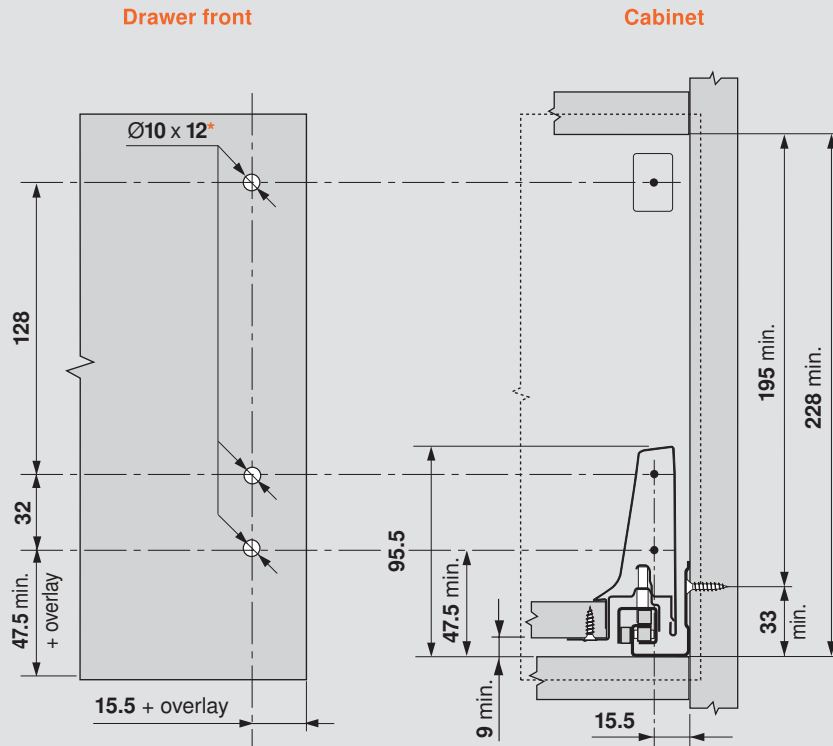

\*Pre-boring dimensions for INSERTA and EXPANDO only, for screw-on pre-bore Ø2 x 2.5

## Rear fixing bracket installation

## Drawer back

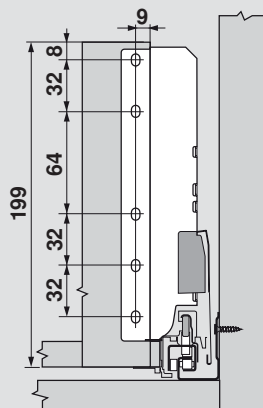

# TANDEMBOX



## M Height Interior Roll-out

### Application



### Features

- Full extension drawer system with BLUMOTION
- TANDEM smooth running mechanism
- Two-dimensional drawer front adjustment
- Static load capacity of 100 lb
- Drawer side height 84 (3-5/16")

### Space Requirements

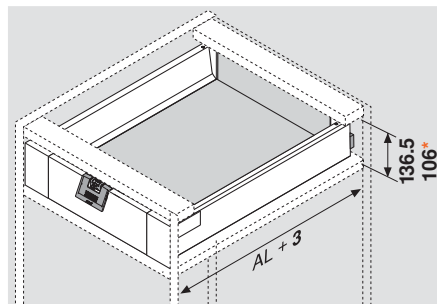

AL = Actual cabinet profile length

\*Minimum opening with handle and 3 (1/8") clearance

### Components

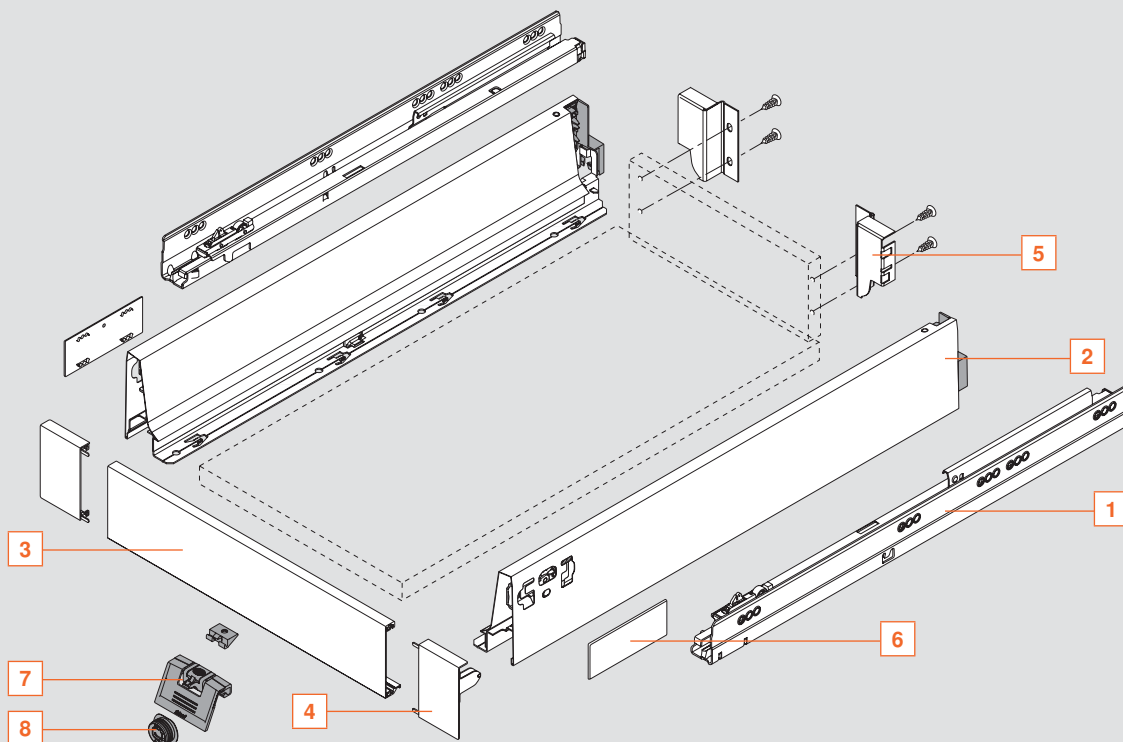

**NOTE:** Parts identified on right page



## Cabinet and drawer profiles

- Left and right drawer & cabinet profiles must be ordered separately

## 1 Cabinet profile

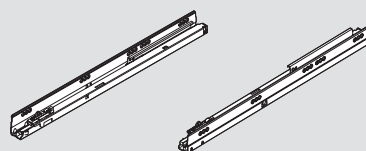

## 2 Drawer profile

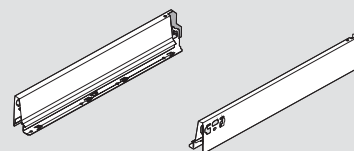

| Nominal length            | Actual cabinet profile length | 100 lb      |             | Gray         |              |
|---------------------------|-------------------------------|-------------|-------------|--------------|--------------|
| 16"                       | 400 (15-3/4")                 | 578.4001B L | 578.4001B R | 378M4002SA L | 378M4002SA R |
| 18"                       | 450 (17-11/16")               | 578.4501B L | 578.4501B R | 378M4502SA L | 378M4502SA R |
| 20"                       | 500 (19-11/16")               | 578.5001B L | 578.5001B R | 378M5002SA L | 378M5002SA R |
| 22"                       | 550 (21-5/8")                 | 578.5501B L | 578.5501B R | 378M5502SA L | 378M5502SA R |
| Installation wood screw   |                               | 707N        | 707N        | 612TH        |              |
| Installation system screw |                               | 661.1300.HG | 661.1300.HG |              |              |

## Front piece

|              |  |                  |
|--------------|--|------------------|
| <div>3</div> | <ul style="list-style-type: none"> <li>Length <b>1036</b> (40-13/16"), cut to size</li> <li>Gray (R906)</li> </ul> | Part no.         |
|              | Front piece  | <b>Z31L1036A</b> |

## Front fixing bracket set – nylon

|              |  |                 |
|--------------|--|-----------------|
| <div>4</div> | <b>Set includes:</b> <ul style="list-style-type: none"> <li>Left and right bracket</li> <li>Bottom support</li> <li>Gray (R906)</li> </ul> | Part no.        |
|              | Nylon bracket set  | <b>ZIF.71M0</b> |

## Rear fixing bracket set

|                    |  |                    |
|--------------------|--|--------------------|
| <div>5</div>       | <b>Set includes:</b> <ul style="list-style-type: none"> <li>Left and right bracket</li> <li>Gray (R906)</li> </ul> | Part no.           |
|                    | Rear fixing bracket set  | <b>Z30M000S.04</b> |
| Installation screw |  | <b>612TH</b>       |

## TANDEMBOX cover caps

|                 |   |                    |
|-----------------|---|--------------------|
| <div>6</div>    | <ul style="list-style-type: none"> <li>For use with TANDEMBOX drawers</li> <li>Non-handed, symmetrical design</li> <li>Gray</li> <li>Custom logo printing available</li> <li>Order two cover caps per drawer</li> </ul> | Part no.           |
|                 | Blum logo cover cap   | <b>ZAA.532C.BT</b> |
| Blank cover cap |   | <b>ZAA.532C</b>    |

## Interior front handle

|              |  |                 |
|--------------|--|-----------------|
| <div>7</div> | <ul style="list-style-type: none"> <li>Dust gray (R737)</li> </ul> | Part no.        |
|              | Interior front handle  | <b>ZIF.80M5</b> |

## Interior front handle with latch

|              |  |                 |
|--------------|--|-----------------|
| <div>8</div> | <ul style="list-style-type: none"> <li>Dust gray (R737)</li> </ul> | Part no.        |
|              | Handle with latch  | <b>ZIF.80M7</b> |

Cabinet profile installation

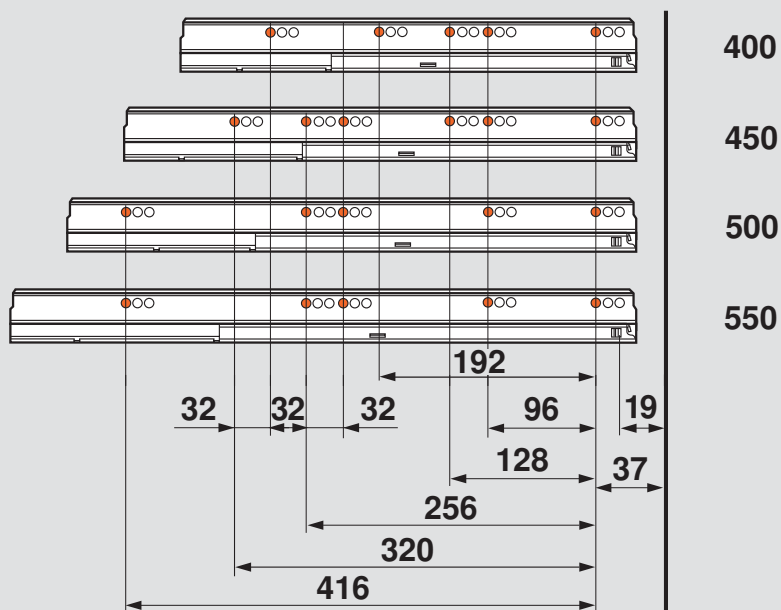

**NOTE:** Recommended screw locations in orange (system screws or #7 wood screws)

Cutting dimensions for bottom and back

**Drawer bottom**

Width = Inside cabinet width minus **75** (2-15/16")

Length = Actual cabinet profile length minus **24** (15/16")

**Drawer back**

Width = Inside cabinet width minus **87** (3-7/16")

Height = **84** (3-5/16")

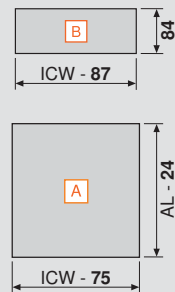
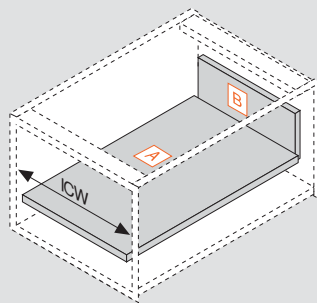

AL = Actual cabinet profile length

ICW = Inside cabinet width

**NOTE:** Use **16** (5/8") material for bottom and back

## Rear fixing bracket installation

Cabinet

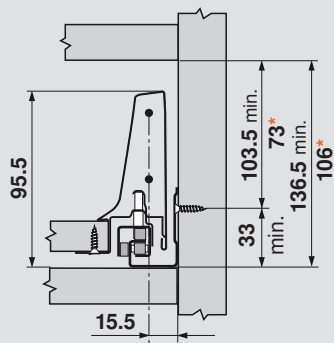

Drawer back

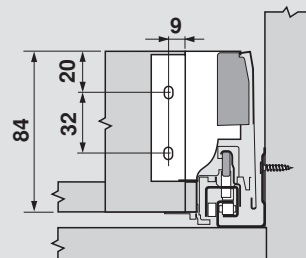

\*Measurement for use with handle (ZIF.80M5)

## Front boring dimensions for interior front handle

Drawer front center line

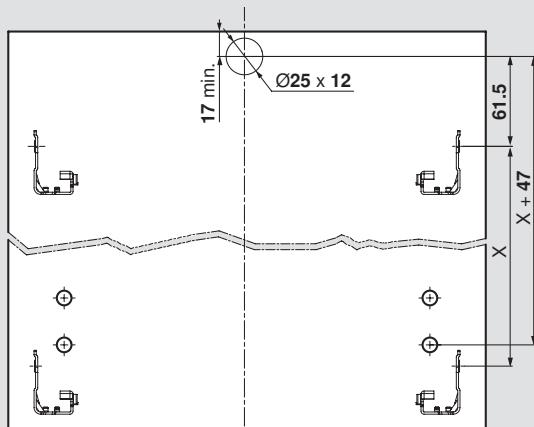

## Cutting front piece

Using a metal cutting blade, cut front piece to size.

X = Inside cabinet width minus 132 (5-3/16")

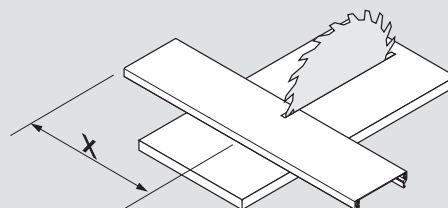

## Operation with interior front handle enabled

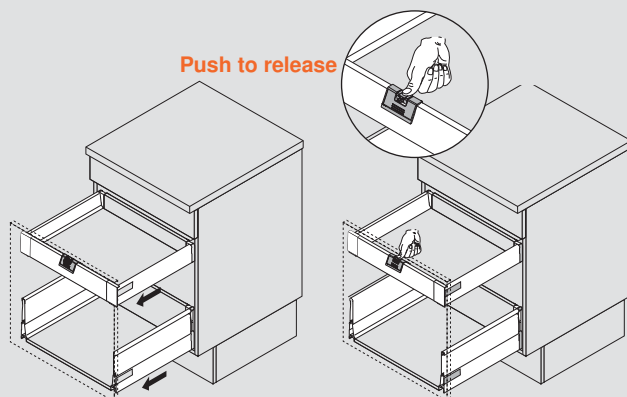

## Enable/disable interior front handle

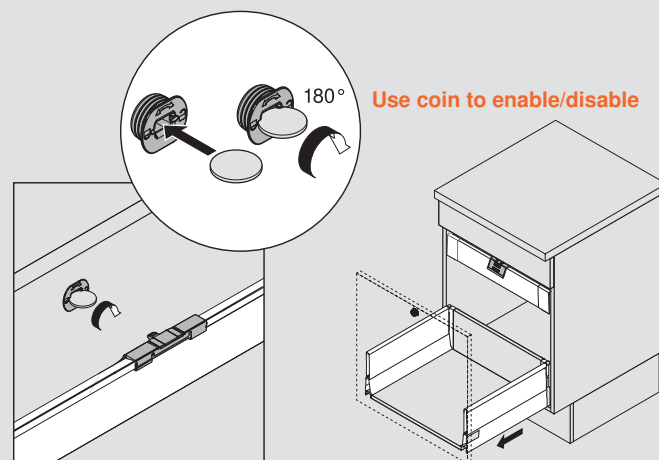

# TANDEMBOX



## D Height with Single Gallery Interior Roll-out

### Application



### Features

- Full extension drawer system with BLUMOTION
- TANDEM smooth running mechanism
- Three-dimensional drawer front adjustment
- Static load capacity of 100 lb
- Drawer side height **207** (8-1/8")

### Space Requirements

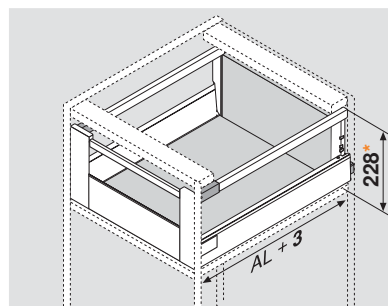

AL = Actual cabinet profile length

\*Minimum opening height based on 3 (1/8") clearance

### Components

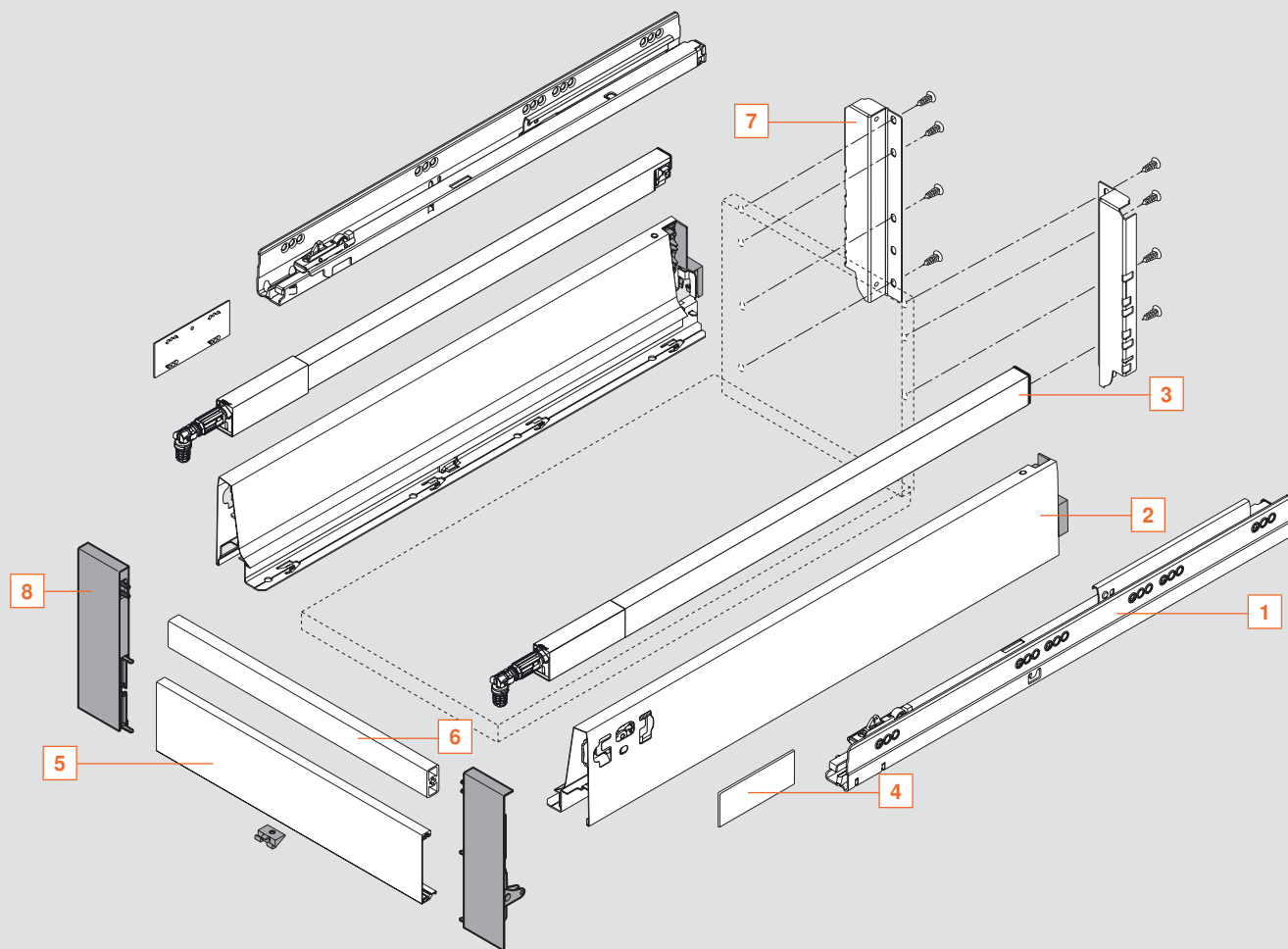

**NOTE:** Parts identified on right page



## Required Parts

## TANDEMBOX



### Cabinet and drawer profiles

- Left and right drawer & cabinet profiles must be ordered separately

#### 1 Cabinet profile

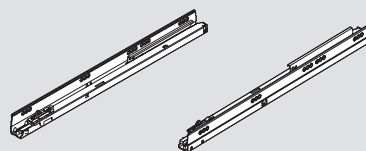

100 lb

#### 2 Drawer profile

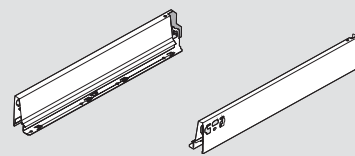

Gray

| Nominal length            | Actual cabinet profile length |             |             |              |              |
|---------------------------|-------------------------------|-------------|-------------|--------------|--------------|
| 16"                       | 400 (15-3/4")                 | 578.4001B L | 578.4001B R | 378M4002SA L | 378M4002SA R |
| 18"                       | 450 (17-11/16")               | 578.4501B L | 578.4501B R | 378M4502SA L | 378M4502SA R |
| 20"                       | 500 (19-11/16")               | 578.5001B L | 578.5001B R | 378M5002SA L | 378M5002SA R |
| 22"                       | 550 (21-5/8")                 | 578.5501B L | 578.5501B R | 378M5502SA L | 378M5502SA R |
| Installation wood screw   |                               | 707N        | 707N        | 612TH        |              |
| Installation system screw |                               | 661.1300.HG | 661.1300.HG |              |              |

### Top gallery rails

3

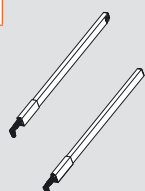

- Left and right gallery rails must be ordered separately

Actual cabinet profile length

Gray

|                 |               |               |
|-----------------|---------------|---------------|
| 400 (15-3/4")   | ZRG.337RSIC L | ZRG.337RSIC R |
| 450 (17-11/16") | ZRG.387RSIC L | ZRG.387RSIC R |
| 500 (19-11/16") | ZRG.437RSIC L | ZRG.437RSIC R |
| 550 (21-5/8")   | ZRG.487RSIC L | ZRG.487RSIC R |

### TANDEMBOX cover caps

4

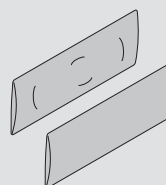

- For use with TANDEMBOX drawers
- Non-handed, symmetrical design
- Gray
- Custom logo printing available
- Order two cover caps per drawer

Part no.

|                     |             |
|---------------------|-------------|
| Blum logo cover cap | ZAA.532C.BT |
| Blank cover cap     | ZAA.532C    |

### Front piece

5

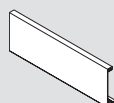

- Length **1036** (40-13/16"), cut to size
- Gray (R906)

Part no.

|             |           |
|-------------|-----------|
| Front piece | Z31L1036A |
|-------------|-----------|

### Cross rail

6

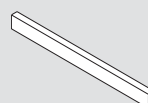

- Length **1046** (41-3/16"), cut to size
- Gray (R906)

Part no.

|            |           |
|------------|-----------|
| Cross rail | ZRG.1046Z |
|------------|-----------|

### Rear fixing bracket set

7

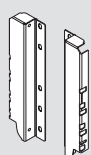

#### Set includes:

- Left and right bracket
- Gray (R906)

Part no.

|                         |           |
|-------------------------|-----------|
| Rear fixing bracket set | Z30D000SL |
| Installation screw      | 612TH     |

### Front fixing bracket set – nylon

8

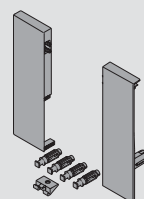

#### Set includes:

- Left and right bracket
- Bottom support
- Gray (R906)

Part no.

|                          |             |
|--------------------------|-------------|
| Front fixing bracket set | ZIF.75D0.US |
|--------------------------|-------------|

Cabinet profile installation

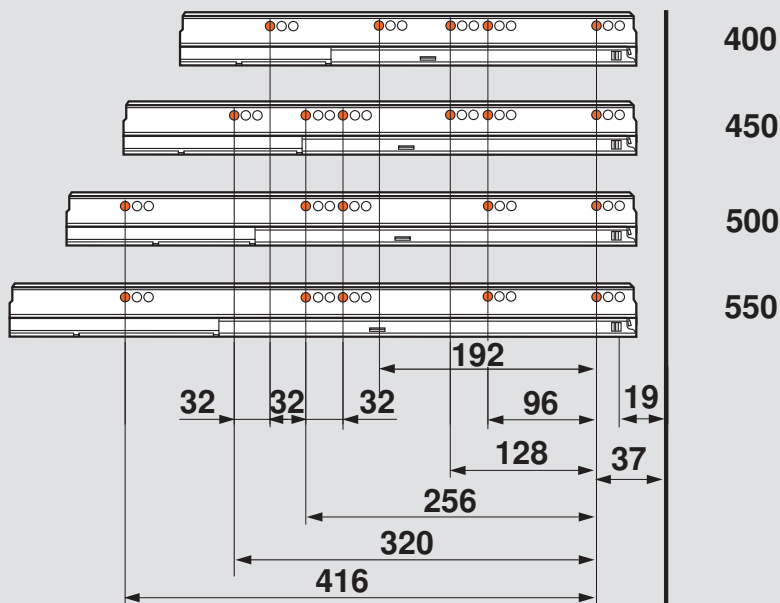

**NOTE:** Recommended screw locations in orange (system screws or #7 wood screws)

Cutting dimensions for bottom and back

**Drawer bottom**

Width = Inside cabinet width minus **75** (2-15/16")

Length = Actual cabinet profile length minus **24** (15/16")

**Drawer back**

Width = Inside cabinet width minus **87** (3-7/16")

Height = **199** (7-13/16")

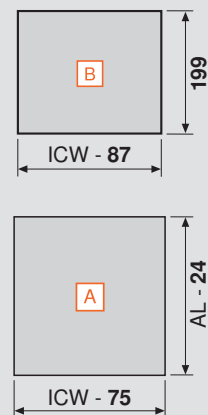
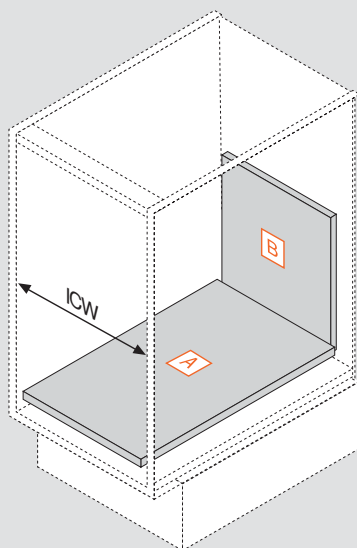

AL = Actual cabinet profile length

ICW = Inside cabinet width

**NOTE:** Use **16** (5/8") material for bottom and back

## Front fixing bracket installation

Cabinet

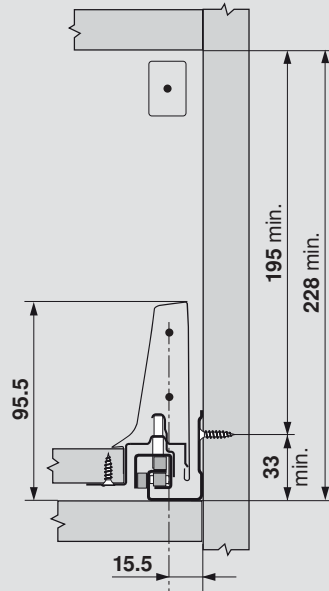

Drawer back

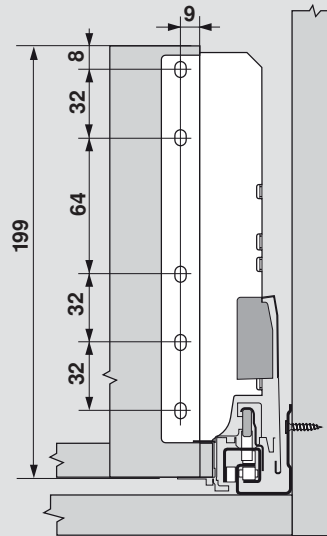

\*Pre-boring dimensions for INSERTA and EXPANDO only, for screw-on pre-bore  $\varnothing 2 \times 2.5$

## Cutting front piece

Using metal cutting blade, cut front piece to size.

X = Inside cabinet width minus **132** (5-3/16")

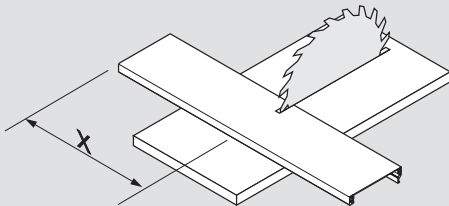

## Cutting cross rail

Using metal cutting blade, cut cross rail to size.

X = Inside cabinet width **122** (4-13/16")

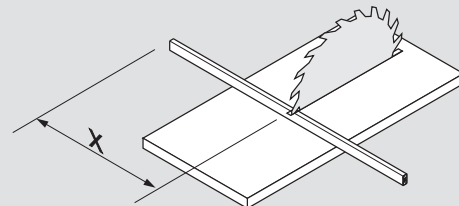

TANDEMBOX



## Dual Sink Drawer

### Application



### Features

- Full extension drawer system with BLUMOTION
- TANDEM smooth running mechanism
- Three-dimensional drawer front adjustment
- Static load capacity of 100 lb

#### M Height

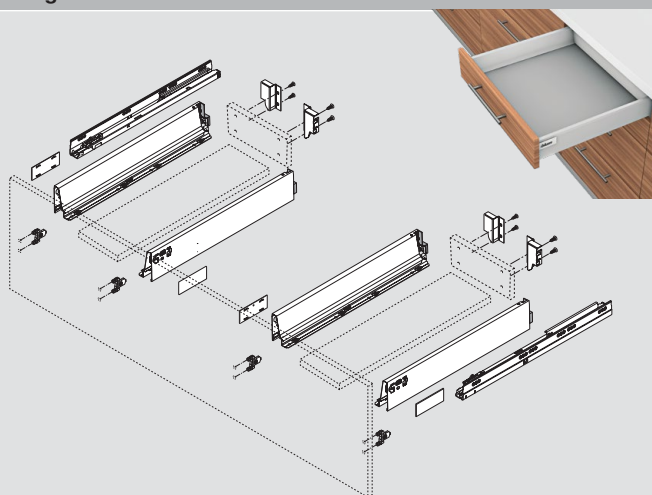

#### Required components and specifications

M Height

page 12-15

#### D Height with Single Gallery

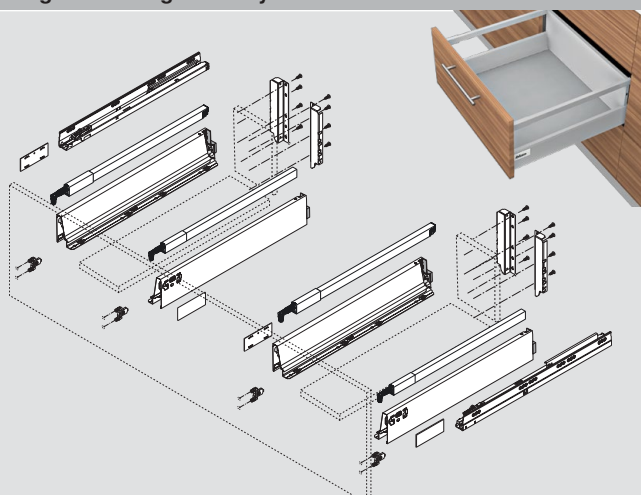

#### Required components and specifications

D Height with Single Gallery

page 20-23

## Cutting dimensions for bottom and back

**A** Drawer back

Width = Y minus 12 then subtract 12

M Height = 84 (3-5/16")

D Height = 199 (7-13/16")

Y minimum = 48 (1-7/8")

Y maximum = **Trial recommended****B** Drawer bottom

Minimum width = 43 (1-11/16") each

Length = Actual cabinet profile length minus 24 (15/16")

Y = Drawer bottom width minus (SW+63) divided by 2

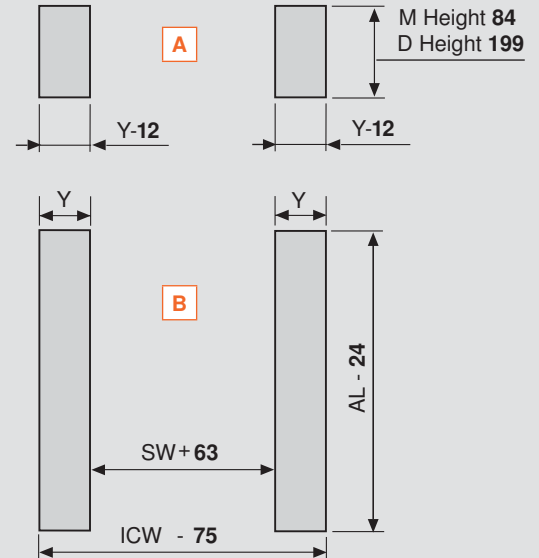
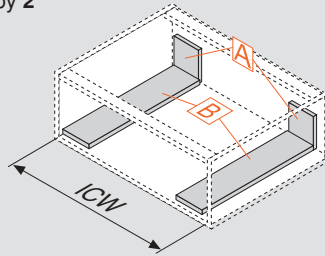

AL = Actual cabinet profile length

ICW = Inside cabinet width

SW = Width of the sink

Y = Drawer bottom width of side 1 or 2 (variable)

Z = Actual cabinet profile length minus 164 (6-7/16")

**NOTE:** Use 16 (5/8") material for bottom and back

## Drawer front preparation

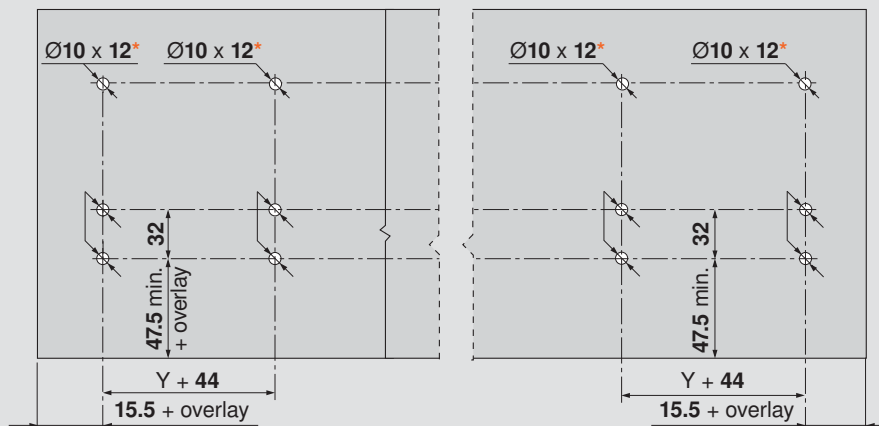

\*Pre-boring dimensions for INSERTA and EXPANDO only, for screw-on pre-bore Ø2 x 2.5



# TANDEMBOX



## Waste/recycle Set with SERVO-DRIVE

### Application



### Features

- Pre-assembled bottom mount solution
- TANDEMBOX heavy duty full extension drawer system
- For 12", 15" and 18" minimum opening widths
- For face frame and frameless applications
- Three-dimensional drawer front adjustment
- Maximum 6 (1/4") cabinet bottom recess
- TANDEM smooth running action
- Static load capacity of 175 lb
- SERVO-DRIVE touch-to-open feature

### Basic Components

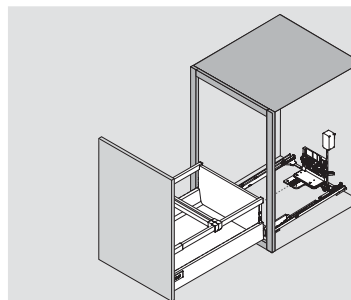

**NOTE:** Bins not included

### TANDEMBOX waste/recycle set

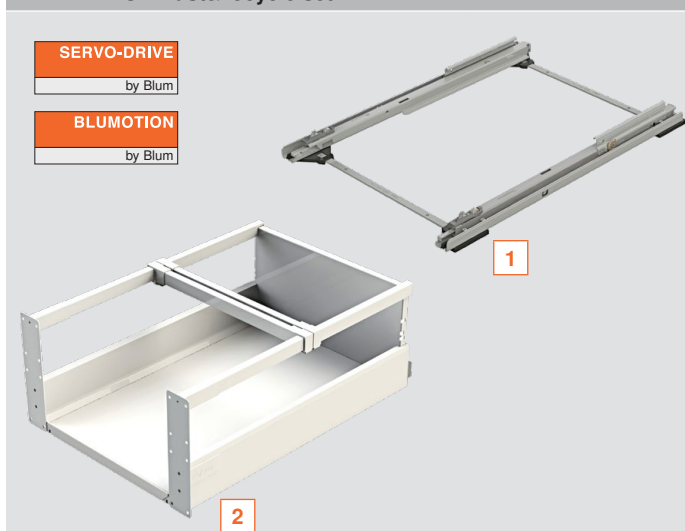

#### Set includes:

- TANDEMBOX heavy duty runner set with pre-mounted #6 x 3/4" wood screws for installation (qty 8)
  - Pre-assembled silk white TANDEMBOX drawer
- Installation template and instructions
  - #6 x 5/8" wood screws for attachment to drawer front (qty 10)
  - TANDEMBOX cover caps (qty 2)

| TANDEMBOX waste/recycle set   | Drawer length | Part no.    |
|-------------------------------|---------------|-------------|
| For 12" minimum opening width | 550 (21-5/8") | 376M55B7SAB |
| For 15" minimum opening width | 550 (21-5/8") | 376M55B7SAD |
| For 18" minimum opening width | 550 (21-5/8") | 376M55B7SAF |

### SERVO-DRIVE waste/recycle set

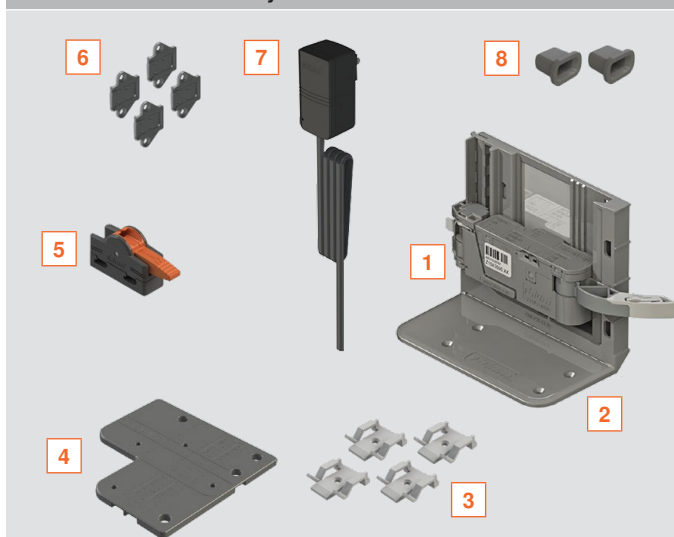

#### Set includes:

- Drive unit (pre-attached)
  - Double bottom bracket with #6 x 1" wood screws (qty 2)
  - Cable clips (qty 4)
  - Adapter plate
  - INSERTA cable connector
  - Screw-on distance bumpers (qty 4) with #6 x 5/8" wood screws for installation (qty 8)
  - 110 volt plug-in power supply with six feet of universal cable
  - Cable end protectors (qty 2)
- Installation template, instructions and user manual

Part no.

SERVO-DRIVE waste/recycle set

**Z10NA30UGUS**

**NOTE:** Power supply will operate up to two drive units in a double bottom bracket application (second drive unit sold separately)

## Specifications

## TANDEMBOX



### Drawer and Cabinet Specifications

#### Front view

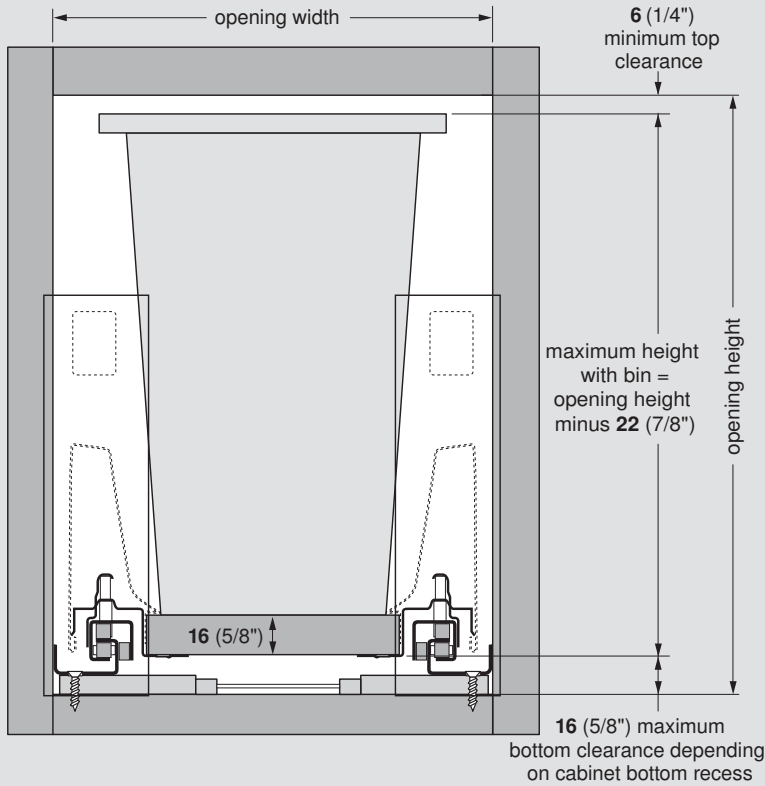

A retainer or wood block should be added to the TANDEMBOX drawer to secure the bins and keep them from pressing against the drawer front during daily operation

**NOTE:** Minimum opening height = 233 (9-3/16")



#### Important

Bin width and height must be considered when designing your cabinet (see the diagram on the left).

#### Minimum inside cabinet depth

|                     |                 |
|---------------------|-----------------|
| With SERVO-DRIVE    | 574 (22-19/32") |
| Without SERVO-DRIVE | 569 (22-13/32") |

#### Drawer front attachment

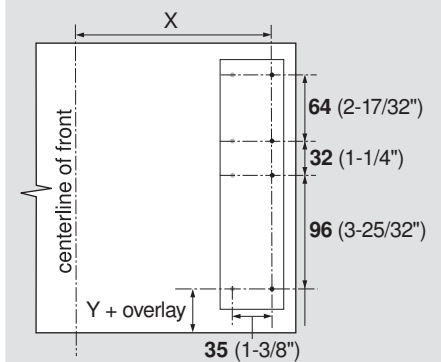

#### Cabinet bottom recess

|   | 6 (1/4")  | 3 (1/8")  | Flush     |
|---|-----------|-----------|-----------|
| Y | 16 (5/8") | 19 (3/4") | 22 (7/8") |

| Waste/recycle set     | 376M55B7SAB      | 376M55B7SAD      | 376M55B7SAF     |
|-----------------------|------------------|------------------|-----------------|
| X                     | 154.5 (6-3/32")  | 192.5 (7-19/32") | 230.5 (9-1/16") |
| Z                     | 146.5 (5-25/32") | 184.5 (7-1/4")   | 222.5 (8-3/4")  |
| Minimum opening width | 305 (12")        | 381 (15")        | 457 (18")       |

#### Set mounting specifications

##### Top view

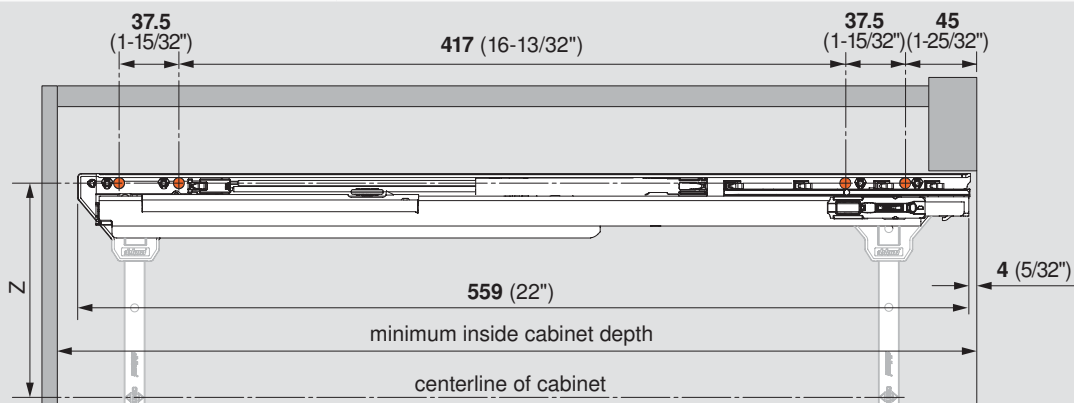

**NOTE:** Orange dots indicate pre-mounted screw locations. All four screws are required to meet specified load capacities.

### Cabinet profile template



- Used for pre-boring holes for LEGRABOX, TANDEMBOX, and TANDEM drawer runners
- Can also be used to pre-bore AVENTOS locating pins and pre-boring for hinge mounting plates

Part no.

|                          |            |
|--------------------------|------------|
| Cabinet profile template | 65.1000.01 |
| Replacement template     | 65.1001.01 |
| Ø2.5 drill bit           | DB-2.5mm   |

### Components

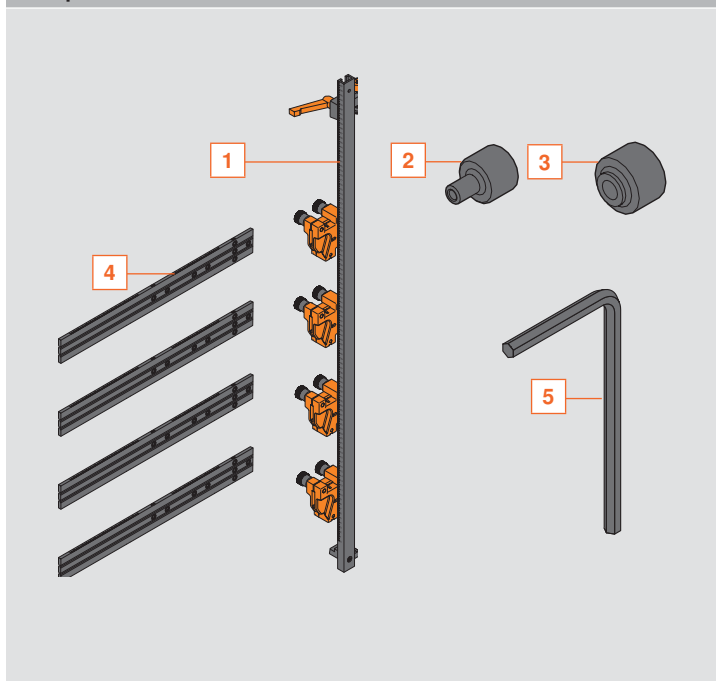

#### Cabinet profile template includes:

- 1 Rail, 1 meter long (qty 1)
- 2 Ø2.5 stop collar (qty 1)
- 3 Ø5 stop collar (qty 1)
- 4 Replacement template (qty 4)
- 5 Allen wrench (qty 1)

### Universal individual template

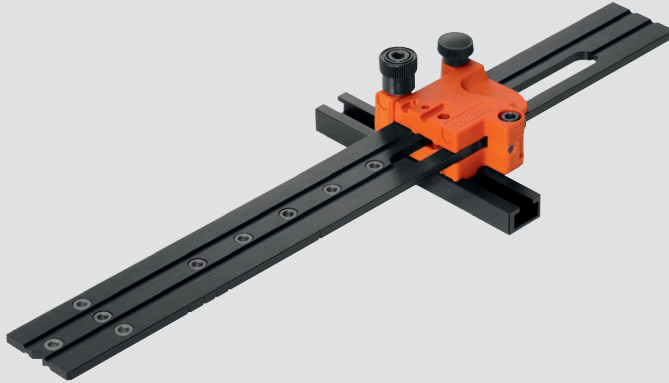

- Used for pre-boring holes for LEGRABOX, TANDEMBOX, and TANDEM drawer runners
- Can also be used to pre-bore for AVENTOS locating pins and pre-boring for hinge mounting plates
- Calibrated scale for accurate setting

#### Set includes:

- Universal individual template
- Ø2.5 and Ø5 stop collars

Part no.

Universal individual template

65.1051.02

Ø2.5 drill bit

DB-2.5mm

### Pre-boring for cabinet profile mounting holes

#### 1 Mark position

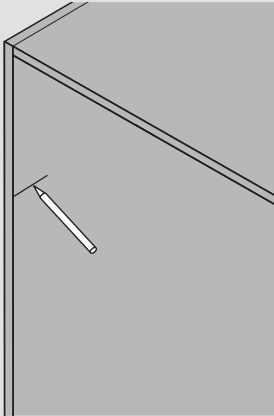

#### 2 Line up template with mark and pre-bore required holes

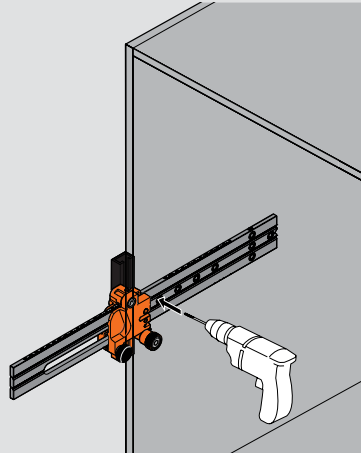

#### 3 Attach runner

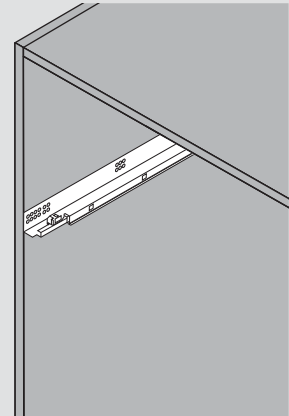

### Universal boring template

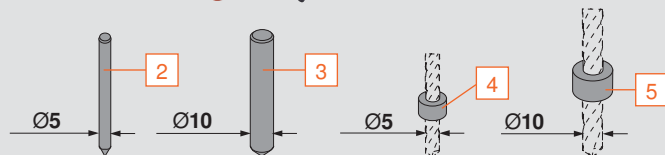

#### Set includes:

- 1 Template
- 2 Ø5 marking pin
- 3 Ø10 marking pin
- 4 Ø5 stop collar
- 5 Ø10 stop collar

- Used for boring drawer fronts, locates all fixing positions
- Used to pre-bore for drawer fronts, bottoms and backs for LEGRABOX, TANDEMBOX and METABOX drawer systems, also AVENTOS mounting plates

Part no.

Universal boring template

ZML.0040.01

Ø5 drill bit

DB-5mm

Ø10 drill bit

DB-10mm

### Using the universal boring template

- 1 Set stops using calibration

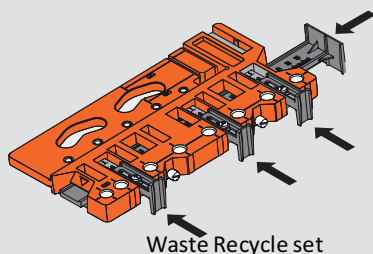

- 2 Pre-bore with Ø10 bit or mark fixing locations

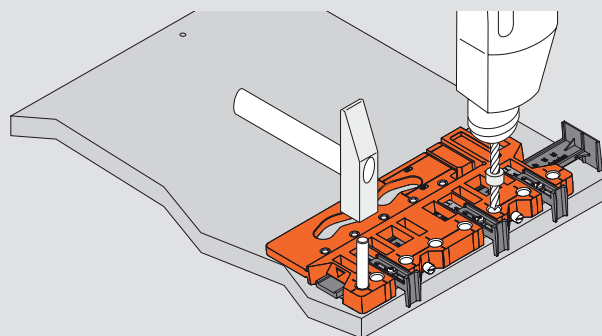

### TANDEMBOX front marking templates



- Used for marking front fixing locations
- For TANDEMBOX 37XM/L drawer profiles

#### Includes:

- Marking template (left and right)
- Marking flag for 37XL drawer profile (left and right)

Part no.

Front marking template

ZML.3580.01

- Can mark for gallery locations

#### Includes:

- Marking template (left and right)

Part no.

Gallery marking template

ZML.3600



### BOXFIX E-T

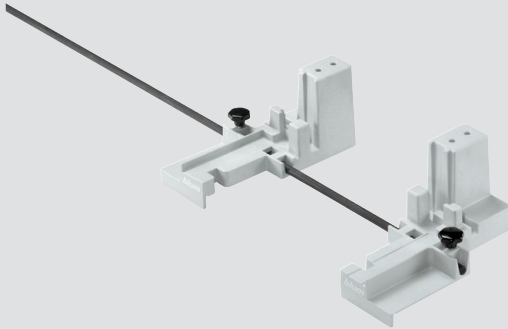

Using BOXFIX E-T you can manually assemble TANDEMBOX easier than ever. Its easy setup and comfortable work height all contribute to a more efficient assembly of TANDEMBOX drawers.

- For all TANDEMBOX heights and lengths
- For cabinet widths **250** to **1200** (9-13/16" to 47-1/4")
- For cabinet back heights up to **250** (9-13/16")

Part no.

BOXFIX E-T

**ZMM.0350**

### BOXFIX plus



Using the new BOXFIX plus you can assemble TANDEMBOX and LEGRABOX faster than ever. Its easy setup, pneumatic clamps, and comfortable work height all contribute to faster, more efficient assembly of LEGRABOX and TANDEMBOX drawers.

- For all LEGRABOX and TANDEMBOX heights and lengths
- Flexible width adjustment (pneumatic)
- One adjustable stop for drawer width included (additional stops available)
- For cabinet widths **250** to **1200** (9-13/16" to 47-1/4")
- For back heights up to **350** (13-3/4")

Part no.

BOXFIX plus

**ZMM.2500**

## MINIPRESS P – Deluxe boring and insertion machine

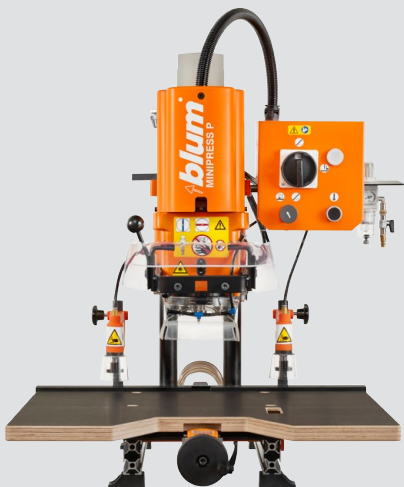

- Front adjustable boring distance with digital counter
- Pneumatic hold-down clamps
- Boring depth adjustment
- Ruler stops (qty 4)
- Tool kit included
- Dust collection attachment
- Optional laser center line set
- Accepts 8 or 9 spindle heads

Part no.

Single phase – 220V power

**M53.2053\*US**

Three-phase – 220V power

**M53.2004\*US**

## MINIPRESS M – 110V manual boring and insertion machine



- 110V power with molding plug (portable)
- Does not require pressurized air
- Ruler stops (qty 4)
- Tool kit included
- Dust collection attachment
- Accepts 8 or 9 spindle heads

Part no.

Single phase – 110V power

**M52.1056\*US**

## 8 spindle head



- 8 spindle head for use with MINIPRESS/MINIDRILL
- Bores eight holes spaced **32** apart, perpendicular to the fence
- Quick-disconnect chucks
- Once aligned, does not require additional adjustment
- Bores all METABOX/TANDEMBOX/LEGRABOX front fixing brackets and galleries
- Bores cabinet side panels for all Blum runner systems
- Requires retrofit set for use with machines produced in 2009 or prior

**Includes:**

- Ø3 allen wrench
- Distance spacer
- Drive pin
- Air hose

Part no.

|                 |                 |
|-----------------|-----------------|
| 8 spindle head  | <b>MZK.880S</b> |
| Chuck cover cap | <b>M30.1329</b> |

## 9 spindle head



- 9 spindle head for use with MINIPRESS/MINIDRILL
- Bores nine holes spaced **32** apart, parallel to the fence
- Quick-disconnect chucks
- Once aligned, does not require additional adjustment
- Bores cabinet side panel for **32** system boring for Blum mounting plates and runners
- Requires retrofit set for use with machines produced in 2009 or prior

**Includes:**

- Ø3 allen wrench
- Distance spacer
- Drive pin
- Air hose

Part no.

|                 |                 |
|-----------------|-----------------|
| 9 spindle head  | <b>MZK.190S</b> |
| Chuck cover cap | <b>M30.1329</b> |

## EASYSTICK



- Automatically moves stops for exact drilling locations for all Blum products
- Built-in cabinet configurator for cabinet design with integrated Blum hardware
- Available as an upgrade for MINIPRESS P (models 2007 and newer)

Part no.

|                                      |                 |
|--------------------------------------|-----------------|
| Computer                             | <b>MZD.5000</b> |
| Fence - overall 1700mm*              | <b>MZD.2000</b> |
| Fence extensions - additional 1700** | <b>MZD.2V00</b> |
| Support for extension ruler          | <b>M2V.2E00</b> |

\* Maximum position 953mm from center

\*\* 1700 each side

# TANDEMBOX



## Accessories

### TANDEMBOX cover caps

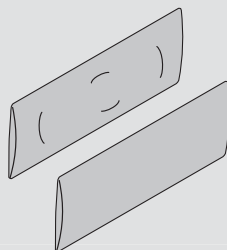

- For use with TANDEMBOX drawers
- Non-handed, symmetrical design
- Gray
- Custom logo printing available
- Order two cover caps per drawer

Part no.

|                     |                    |
|---------------------|--------------------|
| Blum logo cover cap | <b>ZAA.532C.BT</b> |
| Blank cover cap     | <b>ZAA.532C</b>    |

### Front stabilization bracket

- Used for stabilizing wide drawers and/or tall drawer fronts
- Reinforces the connection between the drawer bottom and the front
- One required per drawer, center on drawer bottom

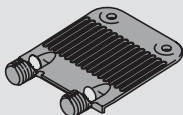

Part no.

|                          |                 |
|--------------------------|-----------------|
| Front stabilizer bracket | <b>Z96.10E1</b> |
|--------------------------|-----------------|

### Front stabilization bracket application

#### Space requirements

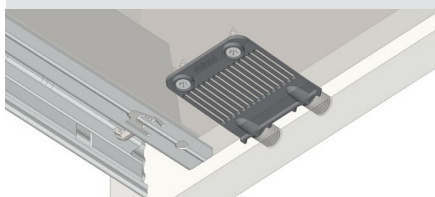
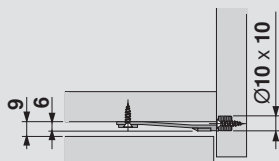

#### Front boring dimensions

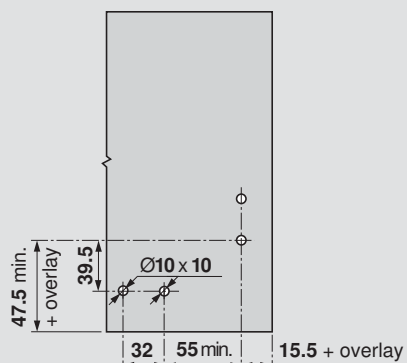

### Side spacer

For spacing out cabinet profiles for clearance on interior roll-out trays.

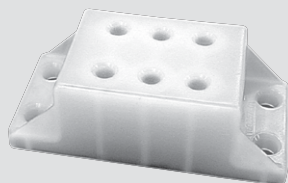

Part no.

|                         |                    |
|-------------------------|--------------------|
| Spacer                  | <b>T59.3570</b>    |
| POZI installation screw | <b>661.1300.HG</b> |

### Side spacer application

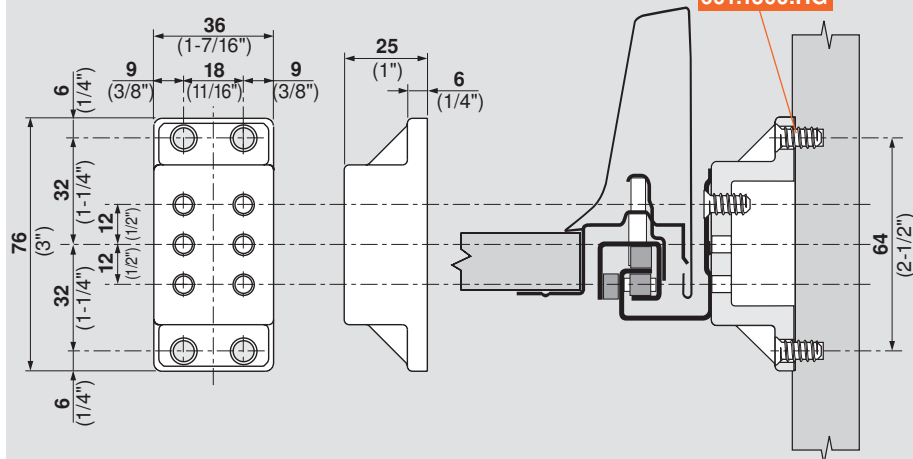

**NOTE:** Use two on 578 series and three on 576 series

## Lateral stabilizer set

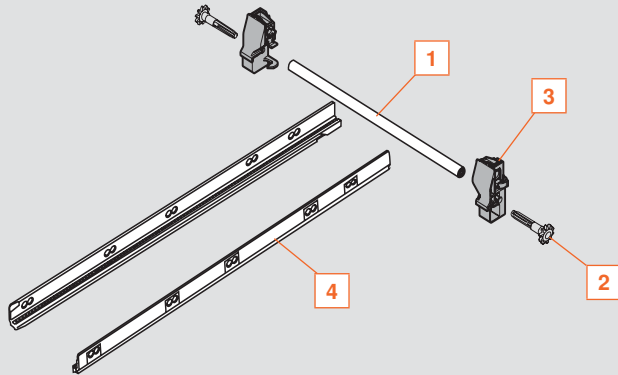

## Set includes:

- 1** Linkage rod, 1076 (42-3/8") cut to size
- 2** Pinion gears (qty 2)
- 3** Rear brackets, left and right
- 4** Gear racks, left and right
- Recommended for cabinets 900 to 1200 (35" to 47") wide

Drawer length

500 (20")

Part no.

ZST.500BA

## Linkage rod specifications

- Length = Inside cabinet width minus 86 (3-3/8")
- Maximum inside cabinet width 1162 (45-3/4")

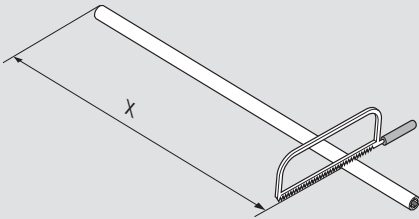

X = Inside cabinet width minus 86 (3-3/8")

## Installation

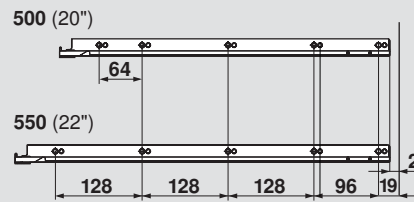

## Assembly

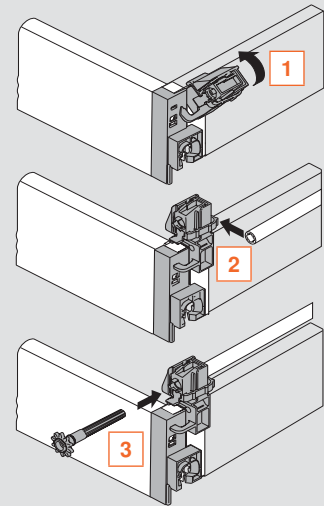

## Space requirements

## M Height rear view drawer

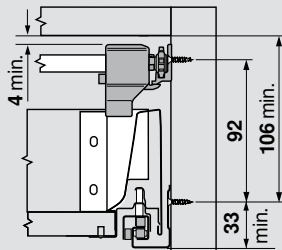

## B Height rear view drawer

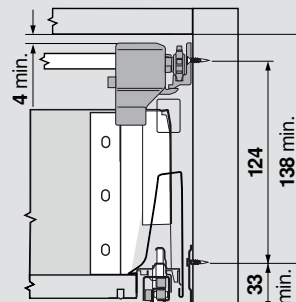

## D Height rear view drawer

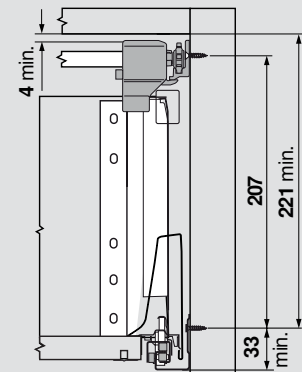



### METAFILE set

Set makes one standard hanging file. Recommended use in combination with B height drawer.

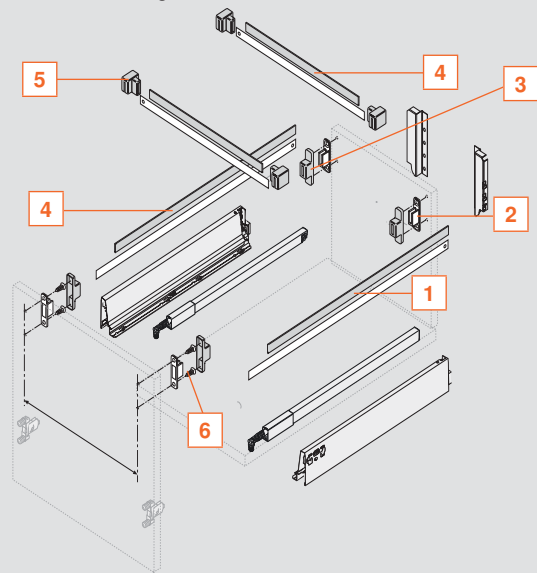

#### Set includes:

- 1** Steel hanging rails (qty 4) – 3 x 13 x 550 (1/8" x 1/2" x 21-5/8")
- 2** Rail support brackets (qty 4)
- 3** Rail support covers (qty 4)
- 4** Glide profiles (qty 4) – length 550 (21-5/8")
- 5** Lateral brackets (qty 4)
- 6** Flathead wood screws (qty 8) – #6 x 19 (3/4")

Part no.

METAFILE set **ZRM.5500**

#### Replacement parts

Rail support covers **ZRM.0003**

Glide profiles **ZRM.550G**

Installation wood screw **6064N**

### Cutting dimensions for wood parts

#### Drawer bottom

**A** Width = Inside cabinet width minus 75 (2-15/16") Length = Actual runner length minus 24 (15/16")

#### Drawer back

**B** Width = Inside cabinet width minus 87 (3-7/16") Height = 271 (10-11/16") minimum

**C** Minimum opening dimensions:

Letter = 413 (16-1/4")

Legal = 489 (19-1/4")

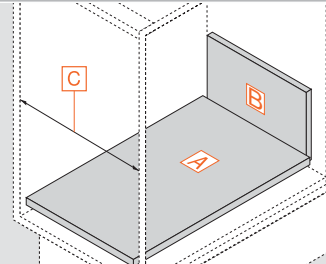

### Installation

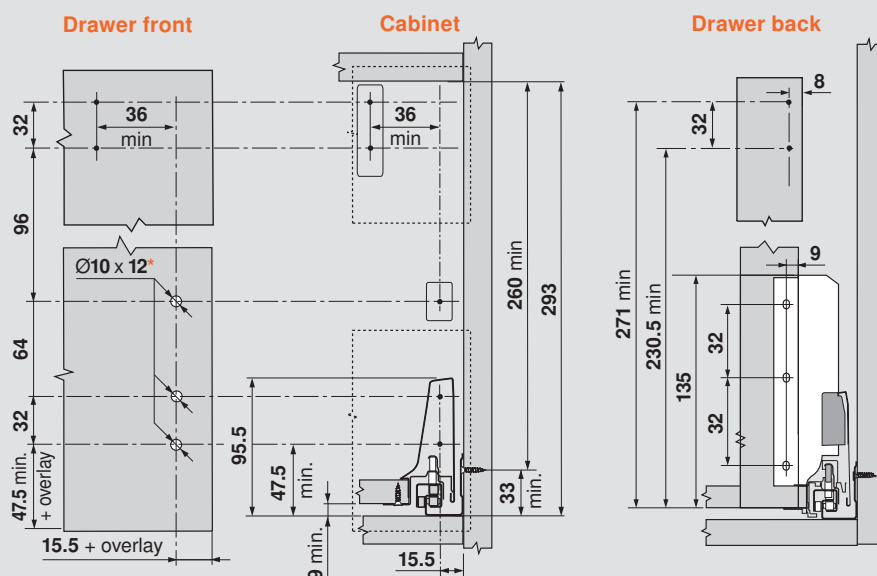

\*INSERTA only

## POZI DRIVER and bits



A POZI screwdriver (different from Phillips) is the most crucial tool you can use to assure that full torque is applied to all Blum mounting screws. POZI screws can be identified by the distinctive "tick" marks located in the center of the screw head recess.

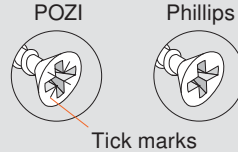

Part no.

|                          |                      |
|--------------------------|----------------------|
| #2 POZI DRIVER           | <b>POZI DRIVER</b>   |
| 1/4" Magnetic bit holder | <b>BIT HOLDER</b>    |
| #2 x 1" POZI bit insert  | <b>POZI BIT #2X1</b> |
| #2 x 2" POZI bit insert  | <b>POZI BIT #2X2</b> |

## Bumpers

- Cushions door closing
- Clear with a self-adhesive back

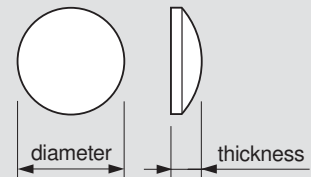

Part no.

|                       |               |
|-----------------------|---------------|
| Ø7 (1/4") x 2 (1/16") | <b>FX4041</b> |
| Ø10 (3/8") x 3 (1/8") | <b>SJ5312</b> |

## Deep thread system screw

- Pilot bore Ø5 (3/16") hole



Part no.

|                       |                    |
|-----------------------|--------------------|
| #7 x 13 mm, #2 POZI   | <b>661.1300.HG</b> |
| #7 x 14.5 mm, #2 POZI | <b>661.1450.HG</b> |

## Ø10 Drill bit

- 10 drill bit for the MINIPRESS/ MINIDRILL and boring heads

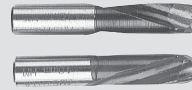

Part no.

|                        |                    |
|------------------------|--------------------|
| Drill bit (right hand) | <b>M01.ZB10.02</b> |
| Drill bit (left hand)  | <b>M01.ZB10.03</b> |

## Deep thread wood screw

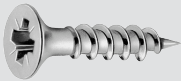

Part no.

|                        |              |
|------------------------|--------------|
| #6 x 5/8", #2 Phillips | <b>606N</b>  |
| #6 x 5/8", #2 POZI     | <b>606P</b>  |
| #7 x 5/8", #2 Phillips | <b>707N</b>  |
| #7 x 3/4", #2 Phillips | <b>7074N</b> |

## Ø5 Drill bit

- Ø5 drill bit for the MINIPRESS/ MINIDRILL and boring heads



Part no.

|                        |                    |
|------------------------|--------------------|
| Drill bit (right hand) | <b>M01.ZB05.D2</b> |
| Drill bit (left hand)  | <b>M01.ZB05.D3</b> |

## Truss head wood screw

- Pilot bore Ø2 (3/32") hole



Part no.

|                        |              |
|------------------------|--------------|
| #6 x 1/2", #2 Phillips | <b>612TH</b> |
|------------------------|--------------|

## VPB-5 VIX bit

- For pre-drilling a 3 pilot hole



Part no.

|         |              |
|---------|--------------|
| VIX bit | <b>VPB-5</b> |
|---------|--------------|

# TANDEMBOX



## ORGA-LINE



### Blum's Ideas for Functional Kitchens

Design doesn't have to stop with the kitchen layout. This adjustable organization solution for TANDEMBOX can be customized to fit individual needs. Whether in the kitchen, office or bathroom, for top drawers and deep drawers alike, there's a place for everything. The removable trays are made of high-quality nylon and stainless steel, and are dishwasher safe up to 170°F. You can be sure they will last the lifetime of your kitchen.

To calculate inside drawer width available: ICW - 84 (3-5/16")

[blum.com/ideas](http://blum.com/ideas)

#### Flatware

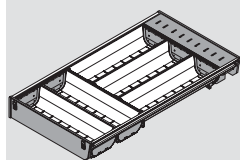

- Width 280 (11")
- Height 64 (2-1/2")

Part no.

500 (20") drawer length

**ZSI.500BI3A**

550 (22") drawer length

**ZSI.550BI3A**

#### Flatware

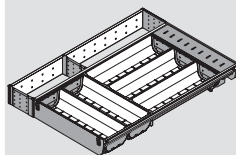

- Width 377 (14-13/16")
- Height 64 (2-1/2")

Part no.

500 (20") drawer length

**ZSI.500KI4A**

550 (22") drawer length

**ZSI.550KI4A**

#### Odds and ends

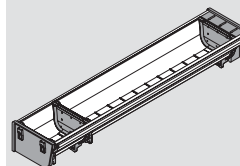

- Width 103 (4-1/16")
- Height 64 (2-1/2")

Part no.

500 (20") drawer length

**ZSI.500BI1N**

550 (22") drawer length

**ZSI.550BI1N**

#### Odds and ends

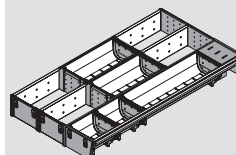

- Width 297 (11-11/16")
- Height 64 (2-1/2")

Part no.

500 (20") drawer length

**ZSI.500MI3**

550 (22") drawer length

**ZSI.550MI3**

#### Utensils

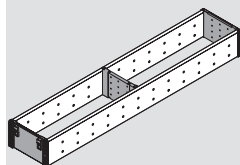

- Width 105 (4-1/8")
- Height 64 (2-1/2")

Part no.

500 (20") drawer length

**ZSI.500FI1**

550 (22") drawer length

**ZSI.550FI1**

#### Utensils

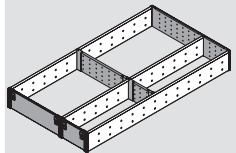

- Width 291 (11-7/16")
- Height 64 (2-1/2")

Part no.

500 (20") drawer length

**ZSI.500FI3**

550 (22") drawer length

**ZSI.550FI3**

**B or D Height TANDEMBOX with Gallery Rails**

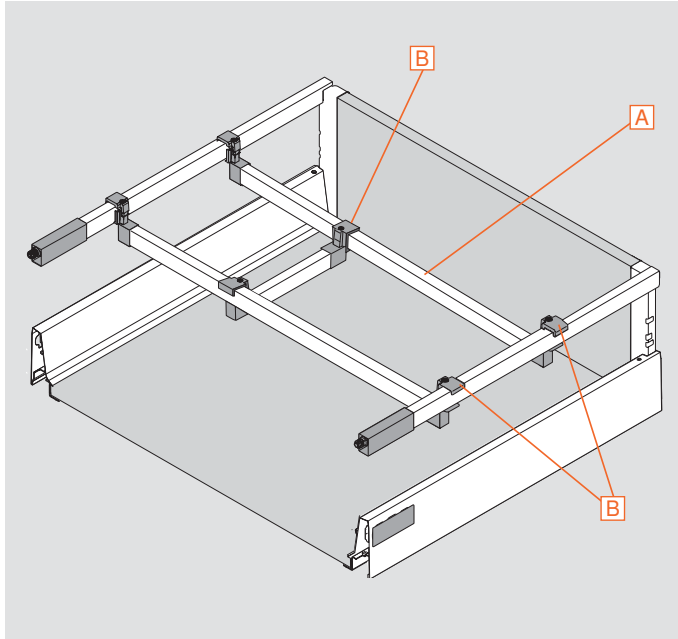

**A Cross gallery rail divider**



- Length **1118** (44-1/32")
- Opening width minus **63** (2-1/2")
- Available in brush nickel or gray

Part no.

Cross gallery rail divider

**ZRG.1118Q**

**B Cross gallery rail connector**

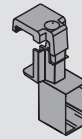

- Two required
- Available in light gray or dust gray

Part no.

Cross gallery rail connector

**ZRU.01E0**

**Accessories**

**ORGA-LINE Knife holder**

- Length **280** (11")
- Width **180** (7-1/8")
- Holds up to nine knives of different sizes
- High quality nylon and stainless steel
- Dishwasher safe up to 170°F
- Handle supports (qty 4)

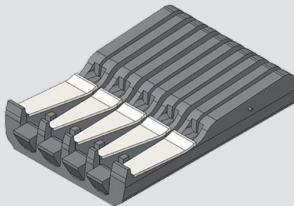

Part no.

Knife holder

**ZSZ.02M0**

**ORGA-LINE Spice tray**

- Width **282** (11-1/8")
- Inside storage width **260** (10-1/4")
- Height **121** (4-3/4")
- Easy removal from drawer
- High quality nylon and stainless steel
- Set includes two trays and four feet

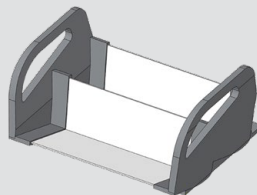

Part no.

Spice tray

**ZFZ.38G01**

**Plate holder**

- Adjustable width **186** to **322** (7-5/16" to 12-11/16")
- Overall height **170** (6-11/16")
- Holds up to 12 plates
- Non-slip bottom
- High quality nylon and stainless steel

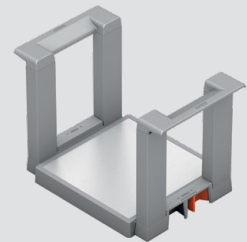

Part no.

Plate holder

**ZC7T0350**

# TANDEMBOX



## Part Number Index

Part no.

Page no.

|               |                    |
|---------------|--------------------|
| 376M55B7SAB   | 34                 |
| 376M55B7SAD   | 34                 |
| 376M55B7SAF   | 34                 |
| 378M4002SA    | 13, 17, 21, 25, 29 |
| 378M4502SA    | 13, 17, 21, 25, 29 |
| 378M5002SA    | 13, 17, 21, 25, 29 |
| 378M5502SA    | 13, 17, 21, 25, 29 |
| 578.4001B     | 13, 17, 21, 25, 29 |
| 578.4501B     | 13, 17, 21, 25, 29 |
| 578.5001B     | 13, 17, 21, 25, 29 |
| 578.5501B     | 13, 17, 21, 25, 29 |
| 606N          | 45                 |
| 606P          | 45                 |
| 612TH         | 25                 |
| 65.1000.01    | 36                 |
| 65.1001.01    | 36                 |
| 65.1051.02    | 37                 |
| 661.1300.HG   | 42                 |
| 661.1450.HG   | 45                 |
| 7074N         | 45                 |
| 707N          | 45                 |
| BIT HOLDER    | 45                 |
| DB-10mm       | 38                 |
| DB-2.5mm      | 37                 |
| DB-5mm        | 38                 |
| FX4041        | 45                 |
| M01.ZB05.D2   | 45                 |
| M01.ZB05.D3   | 45                 |
| M01.ZB10.02   | 45                 |
| M01.ZB10.03   | 45                 |
| M2V.2E00      | 41                 |
| M30.1329      | 41                 |
| M52.1056*US   | 40                 |
| M53.1004*US   | 40                 |
| M53.1053*US   | 40                 |
| MZD.2000      | 41                 |
| MZD.2V00      | 41                 |
| MZD.5000      | 41                 |
| MZK.190S      | 41                 |
| MZK.880S      | 41                 |
| POZI BIT #2x2 | 45                 |
| POZI BIT #2x1 | 45                 |
| POZI DRIVER   | 45                 |
| SJ5312        | 45                 |
| T59.3570      | 42                 |

|             |            |
|-------------|------------|
| VPB-5       | 45         |
| Z10NA30UGUS | 34         |
| Z30B000S.04 | 17         |
| Z30D000SL   | 21, 29     |
| Z30M000S.04 | 13, 25     |
| Z31L1036A   | 25, 29     |
| Z96.10E1    | 42         |
| ZAA.532C    | 42         |
| ZAA.532C.BT | 42         |
| ZC7T0350    | 47         |
| ZFZ.38G0I   | 47         |
| ZIF.71M0    | 25         |
| ZIF.75D0.US | 29         |
| ZIF.80M5    | 25         |
| ZIF.80M7    | 25         |
| ZML.0040.01 | 38         |
| ZML.3580.01 | 38         |
| ZML.3600    | 38         |
| ZMM.0350    | 39         |
| ZMM.2500    | 39         |
| ZRG.1046Z   | 29         |
| ZRG.1118Q   | 47         |
| ZRG.337RSIC | 17, 21, 29 |
| ZRG.387RSIC | 17, 21, 29 |
| ZRG.437RSIC | 17, 21, 29 |
| ZRG.487RSIC | 17, 21, 29 |
| ZRM.0003    | 44         |
| ZRM.5500    | 44         |
| ZRM.550G    | 44         |
| ZRU.01E0    | 47         |
| ZSF.35A2    | 13, 17, 21 |
| ZSF.39A2    | 13, 17, 21 |
| ZSI.500BI1N | 46         |
| ZSI.500BI3A | 46         |
| ZSI.500FI1  | 46         |
| ZSI.500FI3  | 46         |
| ZSI.500KI4A | 46         |
| ZSI.500MI3  | 46         |
| ZSI.550BI1N | 46         |
| ZSI.550BI3A | 46         |
| ZSI.550FI1  | 46         |
| ZSI.550FI3  | 46         |
| ZSI.550KI4A | 46         |
| ZSI.550MI3  | 46         |
| ZST.500BA   | 43         |

ZSZ.02M0

47















A warm, modern kitchen scene. In the foreground, a young girl with blonde hair sits on a black stool, looking towards the kitchen island. The island has a thick wooden countertop and a light-colored cabinet base. A man in a striped shirt is standing at the far end of the island, smiling and cooking. A drawer under the island is open, revealing a well-organized spice rack. The kitchen features large windows, pendant lights, and a dining table in the background. The floor is made of light-colored wood in a herringbone pattern.

# moving ideas

At Blum, we pay attention to those small, but valuable, details. We're attentive in everything we do. With our carefully engineered hardware, innovative motion technologies and customized services, we help move your ideas forward. Let's move the world together.





## Quality of living

We engineer our products with your lifetime in mind. As your mobility needs change, Blum hardware keeps your cabinets accessible.



## Product range

Everything from a single source: Our wide range of products allows you to keep up with the trends of today and tomorrow.



## Inspiration

We monitor global trends and strive to create the solutions of tomorrow. We like to share our insights with you.



## Innovation

We stay in motion. Our curiosity and pioneering spirit drive us to develop new products and services for you.



## Services

We support your daily operations with customized services tailored to your processes.



## Quality

We continuously strive to improve our products, services and ourselves.



## Trust

It's our goal to build lasting relationships with our customers, employees and in our community.

Julius Blum started our journey in 1952 with horseshoe studs. Today we supply innovative hardware to customers in over 120 countries.



Please visit [blum.com](http://blum.com) for information on other Blum products  
LIT.TBX1000.11.24 Ident. 26232340 © 2022 Blum, Inc.

Blum, Inc.  
7733 Old Plank Rd.  
Stanley, NC 28164  
800-438-6788  
[blum.com](http://blum.com)

