

# ARTISAN MILLS

## CABINETS



## Cabinet Specifications

2024-2025

[www.amsupply.com](http://www.amsupply.com)

# Table of Contents



Door Styles/Colors.....	1
Features & Specifications.....	2-3
Phraseology .....	4
Care & Cleaning .....	5
Cabinets at a Glance.....	6-14
Cabinet Type.....	15-48
Wall Cabinets .....	15-24
Base Cabinets.....	25-32
Pantry Cabinets.....	33-36
Vanity Cabinets .....	37-40
Accessories .....	41-43
Panels.....	44-45
Fillers.....	46
Moldings & Trim.....	47-48
Samples & Repair.....	48
Organization Guide .....	49-52
Flooring Guide.....	53-55
Availability by Color.....	56-65
Index.....	66-68



# DOOR STYLES/COLORS

ARTISAN MILLS CABINETS

## Shaker

Available in 6 colors:

White (painted)

Platinum (painted)

Hickory (natural)

Midnight Black (painted)

Fresh Sage (painted)

Carmel (natural)

IMPORTANT: Hickory Shaker Cabinets have unfinished sides and will require a wall skin or panel to conceal any exposed cabinet ends.



PLATINUM



WHITE



HICKORY

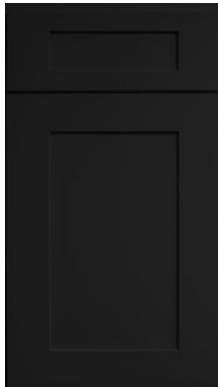

MIDNIGHT BLACK



FRESH SAGE



CARMEL

## Flat Panel w/ Decorative Edge

Available in 2 colors:

West Point Grey (stained)

Winchester Grey (natural)

IMPORTANT: Winchester Grey Cabinets have unfinished sides and will require a wall skin or panel to conceal any exposed cabinet ends.



WEST POINT GREY



WINCHESTER GREY

## Raised Panel

Available in 1 colors:

Aspen White (painted)



ASPEN WHITE

# CABINET SPECIFICATIONS

ARTISAN MILLS CABINETS

SPECIFICATIONS	DESCRIPTION
<b>A</b> OVERLAY	Full-overlay doors and drawer fronts.
<b>B</b> FACE FRAME	3/4" x 1-1/2" solid hardwood face frame.
<b>C</b> DOORS	Stained/Natural doors are 5-piece solid hardwood cope-and-stick construction with a 3/4" thick, 3" wide door frame and 1/4" veneered center panel. Painted doors are 5-piece HDF cope-and-stick with a 3/4" thick, 3" wide door frame with 1/4" HDF center panel.
<b>D</b> HINGES	6-way adjustable soft-close concealed hinges.
<b>E</b> DRAWER FRONTS	5-piece drawer fronts with 3/4" thick frame and 1/4" thick center panel (except Hickory Shaker which is a slab front).*
<b>F</b> DRAWERS	3/4" thick solid wood dovetail drawer boxes with 1/2" veneered plywood drawer bottom.
<b>G</b> DRAWER SLIDES	Premium full extension, 100 lb. dynamic weight rated, adjustable undermount soft-close slides.
<b>H</b> SHELVES	3/4" thick veneered plywood adjustable shelves - half depth in base cabinets 5mm spoon pins included.
<b>I</b> END PANELS	1/2" thick plywood end panels with exterior and interior finished to match and UV coated.*
<b>J</b> TOP/BOTTOM PANELS	1/2" thick plywood captures top and bottom with exterior and interior finished to match and UV coated.*
<b>K</b> BACK PANELS	UV coated plywood back panel.
<b>L</b> CONSTRUCTION	All plywood cabinet construction. Dovetail / Pocket screw assembly system. Corner brackets. 4-1/2" high toe kick.

\* Please see specifications for differences between colors/styles. \*

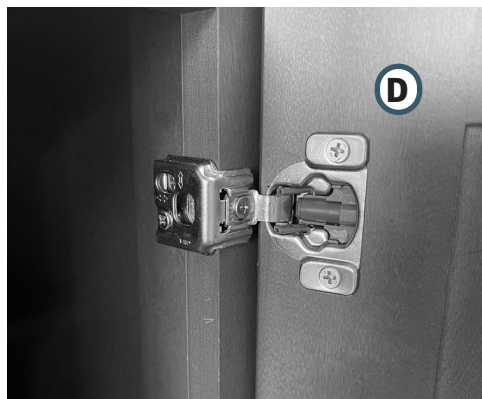
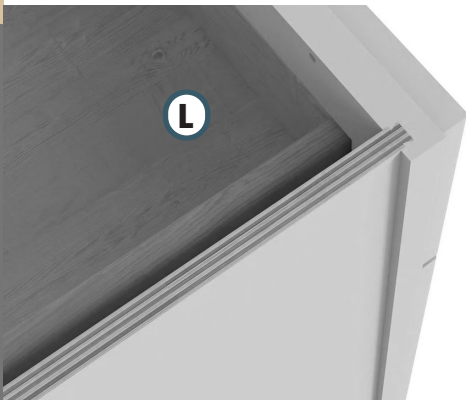
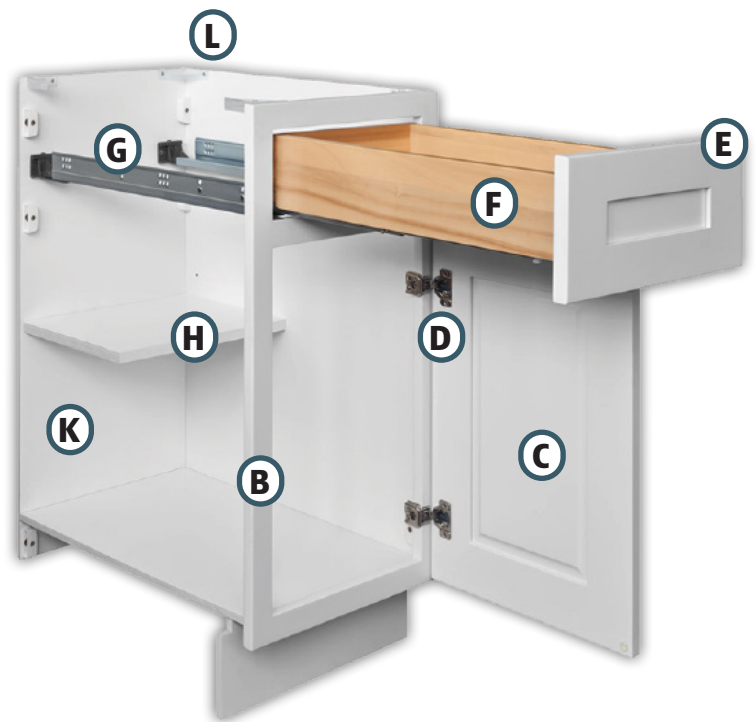
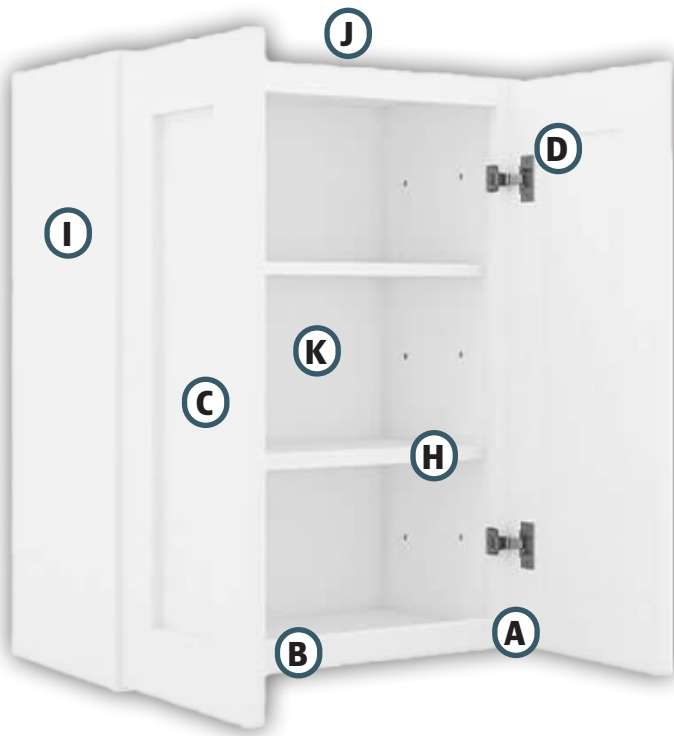

# PHRASEOLOGY

ARTISAN MILLS CABINETS

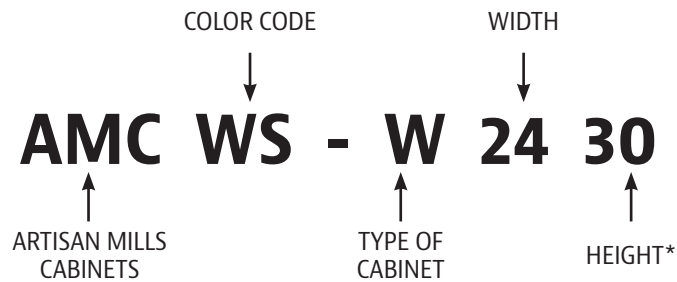

Cabinet Type					
2DB	Two Drawer Base Cabinet	DDW	24" Depth Wall Cabinet	VB	Vanity Base Cabinet
B	Base Cabinet	FSB	Farm Sink Base Cabinet	VDB	Vanity Drawer Cabinet
BA	Angled End Base Cabinet	LS	Lazy Susan Base Cabinet	VSDB	Double Vanity Cabinet
BBC	Blind Corner Base Cabinet	MW	Microwave Wall Cabinet	W	Standard Wall, Decorative Stackers & Bridge Cabinets
BER	Easy Reach Base Cabinet	SB	Sink Base Cabinet	W3DR	Three Drawer Wall Cabinet
BMC	Microwave Base Cabinet	SDW	18"-24" Height Wall Cabinets	WBC	Blind Corner Wall Cabinet
BSD	Spice Drawer Base Cabinet	TB	Tray Base Cabinet	WCA	Angled End Wall Cabinet
BSR	Spice Pull Out Base Cabinet	UC	Utility Cabinets	WDC	Diagonal Corner Wall Cabinet
CDB	Corner Drawer Base Cabinet	UCB	Split Pantry Base Cabinet	WER	Easy Reach Wall Cabinet
DB	Drawer Base Cabinet	UOC	Universal Oven Cabinet	WR	Refrigerator Wall Cabinet
DCSB	Diagonal Sink Base Cabinet	V	Vanity Cabinets	WSC	Spice Drawer Wall Cabinet

\*Height omitted for standard height

Standard base height = 34-1/2"

Standard base depth = 24"

Standard wall depth = 12"

Standard vanity height = 34-1/2"

Standard vanity depth = 21"

Color Codes			
ASP	Aspen White	WIN	Winchester Grey
HS	Hickory Shaker	WPG	West Point Grey
PS	Platinum Shaker	WS	White Shaker
MBS	Midnight Black Shaker	FS	Fresh Sage Shaker
CS	Carmel Shaker		

Samples	
DD	Sample Door

Touch Up	
TUK	Touch Up Kit



# CARE & MAINTENANCE

ARTISAN MILLS CABINETS

## Care and Maintenance of Artisan Mills Cabinets

If you have recently installed Artisan Mills kitchen cabinets, it is important to know how to properly care for and maintain them to ensure their longevity. To begin with, regular cleaning is important, which can be done by simply wiping down the cabinets with a damp cloth and drying them afterwards. Additionally, avoid using harsh chemicals or abrasive cleaning tools as they can damage the cabinets.

When spills or stains occur, it is important to clean them up immediately to prevent any damage. For deeper cleaning, a mild soap solution can be used sparingly. It is also recommended to avoid exposing the cabinets to extreme temperatures or humidity levels, as this can also cause damage or warping.

Overall, by regularly cleaning and properly maintaining your Artisan Mills kitchen cabinets, you can enjoy their beauty and functionality for years to come.

## Cleaning Tips and Best Practices

When it comes to caring for your Artisan Mills Cabinets, there are a few best practices to keep in mind. Firstly, it's important to regularly clean your cabinets with a soft cloth and warm, soapy water. Avoid using abrasive sponges or harsh chemicals, as these can damage the finish on your cabinets.

It's also a good idea to wipe up any spills or stains as soon as possible to prevent them from setting in. In addition to cleaning, it's important to protect your cabinets from excessive moisture and humidity. This can be done by ensuring proper ventilation in your kitchen or bathroom, and by using a dehumidifier if necessary.



# ARTISAN MILLS CABINETS

## *Aspen White (ASP)*

Wood Species	Solid Maple / Birch
Face Frame	Solid Wood
Door Style	Raised Panel (Engineered HDF Construction)
Box Construction	½" Solid Plywood
Drawer Glide	Undermount Soft Close
Drawer Front	5-piece, Matches Door Profile
Drawer Box	¾" Solid Wood Dovetail
Shelves	¾" Adjustable Shelves
Hinges	6 Way Adjustable Soft Close Concealed
Overlay	Full
Cabinet Interior	Color Matched Box & Shelves with Natural Drawers
Cabinet Exterior	Color Matched



Due to printing variations the pictures may vary slightly from true cabinet color.



## *White Shaker (ws)*



Wood Species	Solid Maple / Birch
Face Frame	Solid Wood
Door Style	Shaker Style (Engineered HDF Construction)
Box Construction	1/2" Solid Plywood
Drawer Glide	Undermount Soft Close
Drawer Front	5-piece, Matches Door Profile
Drawer Box	3/4" Solid Wood Dovetail
Shelves	3/4" Adjustable Shelves
Hinges	6 Way Adjustable Soft Close Concealed
Overlay	Full
Cabinet Interior	Color Matched Box & Shelves with Natural Drawers
Cabinet Exterior	Color Matched

Due to printing variations the pictures may vary slightly from true cabinet color.

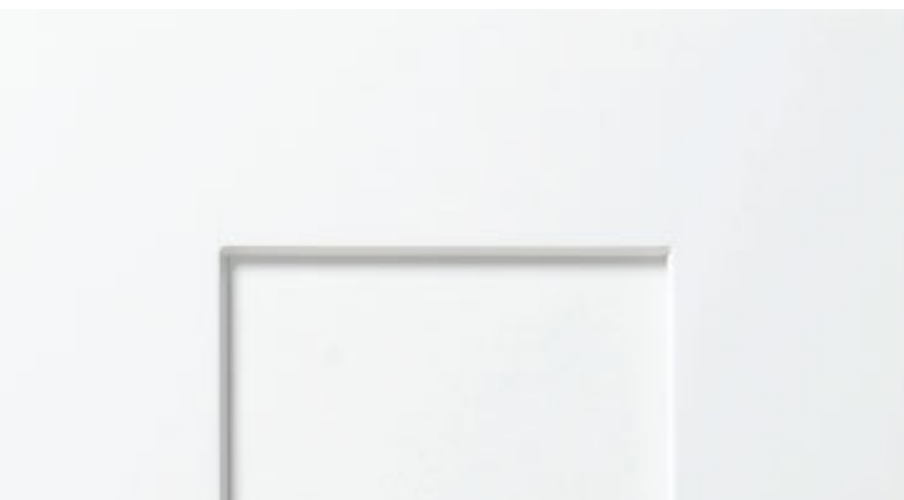





## *Platinum Shaker (PS)*

Wood Species	Solid Maple / Birch
Face Frame	Solid Wood
Door Style	Shaker Style (Engineered HDF Construction)
Box Construction	½" Solid Plywood
Drawer Glide	Undermount Soft Close
Drawer Front	5-piece, Matches Door Profile
Drawer Box	¾" Solid Wood Dovetail
Shelves	¾" Adjustable Shelves
Hinges	6 Way Adjustable Soft Close Concealed
Overlay	Full
Cabinet Interior	Color Matched Box & Shelves with Natural Drawers
Cabinet Exterior	Color Matched



Due to printing variations the pictures may vary slightly from true cabinet color.

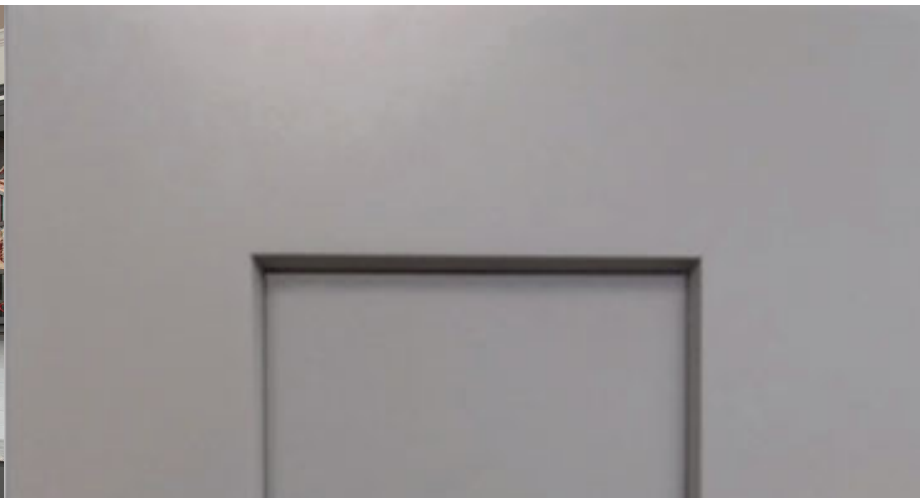



## *West Point Grey (WPG)*



Wood Species	Solid Maple / Birch
Face Frame	Solid Wood
Door Style	Flat Panel w/ Decorative Edge
Box Construction	½" Solid Plywood
Drawer Glide	Undermount Soft Close
Drawer Front	5-piece, Matches Door Profile
Drawer Box	¾" Solid Wood Dovetail
Shelves	¾" Adjustable Shelves
Hinges	6 Way Adjustable Soft Close Concealed
Overlay	Full
Cabinet Interior	Color Matched Box & Shelves with Natural Drawers
Cabinet Exterior	Color Matched

Due to printing variations the pictures may vary slightly from true cabinet color.





## Winchester Grey (WIN)

Wood Species	Solid Maple / Birch
Face Frame	Solid Wood
Door Style	Flat Panel w/ Decorative Edge
Box Construction	½" Solid Plywood
Drawer Glide	Undermount Soft Close
Drawer Front	5-piece, Matches Door Profile
Drawer Box	¾" Solid Wood Dovetail
Shelves	¾" Adjustable Shelves
Hinges	6 Way Adjustable Soft Close Concealed
Overlay	Full
Cabinet Interior	Natural Box, Shelves & Drawers
Cabinet Exterior	Natural



Due to printing variations the pictures may vary slightly from true cabinet color.

\* These cabinets have unfinished sides and will require a skin or panel to conceal any exposed cabinet ends \*





## *Hickory Shaker (HS)*



Wood Species	American Hickory
Face Frame	Solid Wood
Door Style	Shaker Style
Box Construction	½" Solid Plywood
Drawer Glide	Undermount Soft Close
Drawer Front	Solid Slab
Drawer Box	¾" Solid Wood Dovetail
Shelves	¾" Adjustable Shelves
Hinges	6 Way Adjustable Soft Close Concealed
Overlay	Full
Cabinet Interior	Natural Box, Shelves & Drawers
Cabinet Exterior	Natural

Due to printing variations the pictures may vary slightly from true cabinet color.

\* These cabinets have unfinished sides and will require a skin or panel to conceal any exposed cabinet ends \*





## *Midnight Black Shaker (MBS)*

Wood Species	Solid Maple / Birch
Face Frame	Solid Wood
Door Style	Shaker Style (Engineered HDF Construction)
Box Construction	½" Solid Plywood
Drawer Glide	Undermount Soft Close
Drawer Front	5-piece, Matches Door Profile
Drawer Box	¾" Solid Wood Dovetail
Shelves	¾" Adjustable Shelves
Hinges	6 Way Adjustable Soft Close Concealed
Overlay	Full
Cabinet Interior	Natural Box, Shelves & Drawers
Cabinet Exterior	Color Matched



Due to printing variations the pictures may vary slightly from true cabinet color.

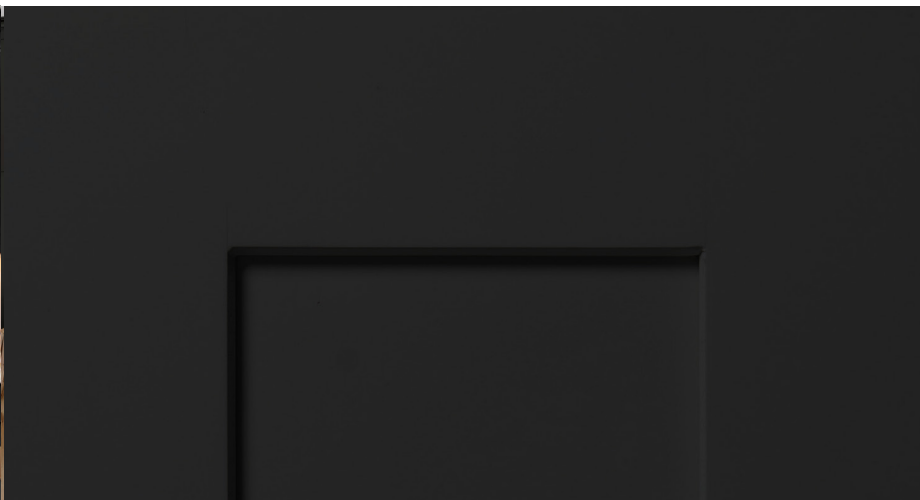



## ***Fresh Sage Shaker (FS)***



Wood Species	Solid Maple / Birch
Face Frame	Solid Wood
Door Style	Shaker Style (Engineered HDF Construction)
Box Construction	½" Solid Plywood
Drawer Glide	Undermount Soft Close
Drawer Front	5-piece, Matches Door Profile
Drawer Box	¾" Solid Wood Dovetail
Shelves	¾" Adjustable Shelves
Hinges	6 Way Adjustable Soft Close Concealed
Overlay	Full
Cabinet Interior	Color Matched Box & Shelves with Natural Drawers
Cabinet Exterior	Color Matched

Due to printing variations the pictures may vary slightly from true cabinet color.





# ARTISAN MILLS CABINETS

## *Carmel Shaker (CS)*

Wood Species	Solid Maple / Birch
Face Frame	Solid Wood
Door Style	Shaker Style
Box Construction	½" Solid Plywood
Drawer Glide	Undermount Soft Close
Drawer Front	5-piece, Matches Door Profile
Drawer Box	¾" Solid Wood Dovetail
Shelves	¾" Adjustable Shelves
Hinges	6 Way Adjustable Soft Close Concealed
Overlay	Full
Cabinet Interior	Natural Box, Shelves & Drawers
Cabinet Exterior	Color Matched



Due to printing variations the pictures may vary slightly from true cabinet color.

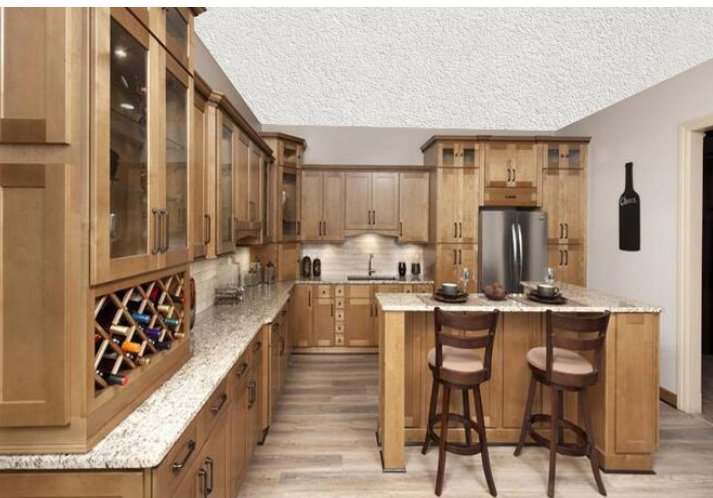



# Wall Cabinets

W



## 30" Height Wall Cabinets

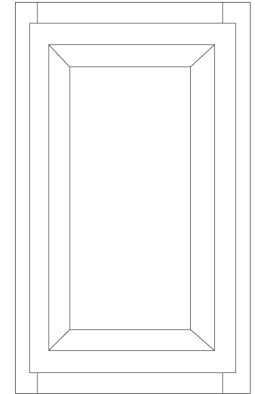
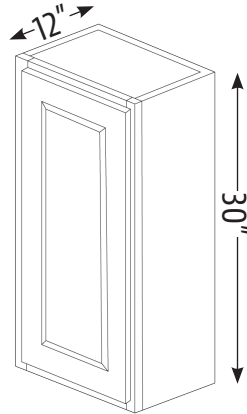

9" to 21"

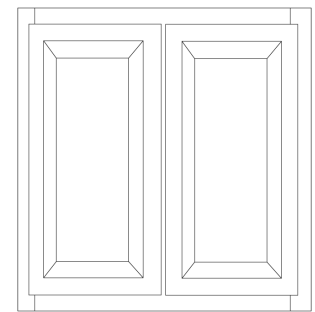
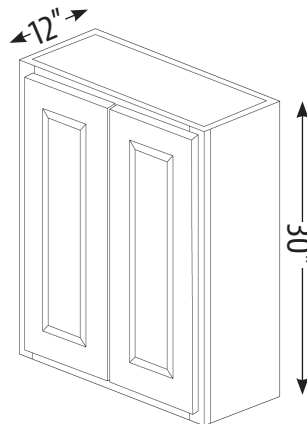

24" to 42"

- Two full depth adjustable shelves included.

	W0930	W1230	W1530	W1830	W2130	W2430	W2730	W3030	W3330	W3630	W3930*	W4230*
Width	9"	12"	15"	18"	21"	24"	27"	30"	33"	36"	39"	42"
Height	30"	30"	30"	30"	30"	30"	30"	30"	30"	30"	30"	30"
Depth	12"	12"	12"	12"	12"	12"	12"	12"	12"	12"	12"	12"
# Doors	1	1	1	1	1	2	2	2	2	2	2	2
# Shelves	2	2	2	2	2	2	2	2	2	2	2	2

### Door Opening

Width	6"	9"	12"	15"	18"	21"	24"	27"	30"	33"	16 7/16"	17 15/16"
Height	27"	27"	27"	27"	27"	27"	27"	27"	27"	27"	27"	27"

### Door Size

Width	7 1/32"	10 1/32"	13 1/32"	16 1/32"	19 1/32"	10 15/16"	12 7/16"	13 29/32"	15 13/32"	16 29/32"	17 17/32"	19 1/32"
Height	28 1/32"	28 1/32"	28 1/32"	28 1/32"	28 1/32"	28 1/32"	28 1/32"	28 1/32"	28 1/32"	28 1/32"	28 1/32"	28 1/32"

\*39" and 42" wide cabinets have a 1-1/2" center stile.

Note: Doors may be replaced with glass doors. Cabinet Opening & Door/Drawer Sizes are estimated dimensions based on cabinet type.

## 36" Height Wall Cabinets

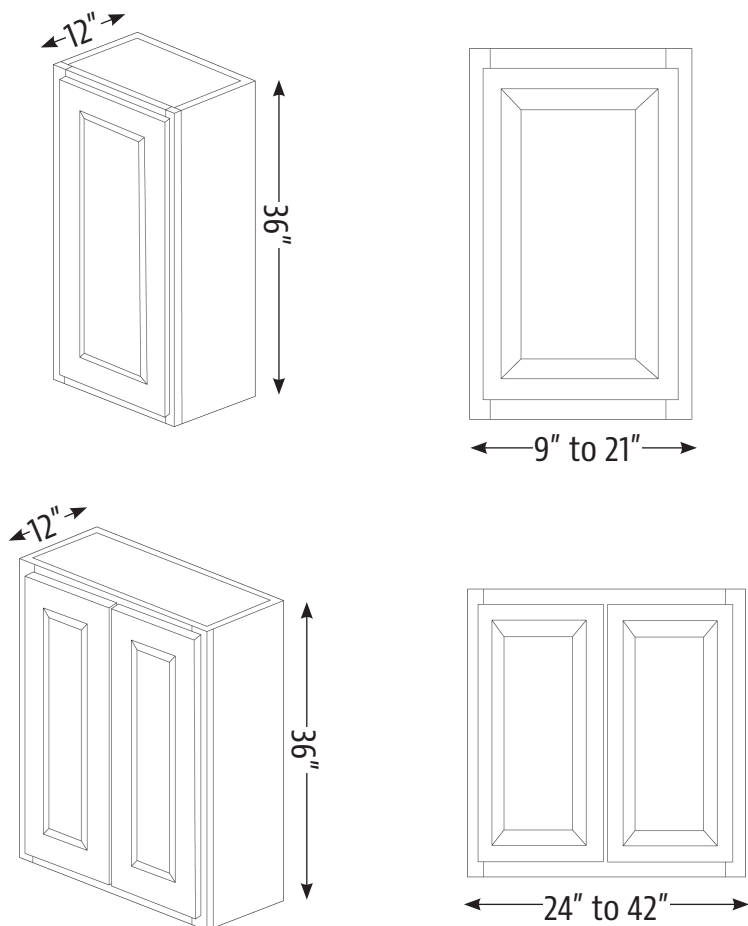

- Two full depth adjustable shelves included.

	W0936	W1236	W1536	W1836	W2136	W2436	W2736	W3036	W3336	W3636	W3936*	W4236*
<b>Width</b>	9"	12"	15"	18"	21"	24"	27"	30"	33"	36"	39"	42"
<b>Height</b>	36"	36"	36"	36"	36"	36"	36"	36"	36"	36"	36"	36"
<b>Depth</b>	12"	12"	12"	12"	12"	12"	12"	12"	12"	12"	12"	12"
<b># Doors</b>	1	1	1	1	1	2	2	2	2	2	2	2
<b># Shelves</b>	2	2	2	2	2	2	2	2	2	2	2	2

### Door Opening

<b>Width</b>	6"	9"	12"	15"	18"	21"	24"	27"	30"	33"	16 7/16"	17 15/16"
<b>Height</b>	33"	33"	33"	33"	33"	33"	33"	33"	33"	33"	33"	33"

### Door Size

<b>Width</b>	7 1/32"	10 1/32"	13 1/32"	16 1/32"	19 1/32"	10 15/16"	12 7/16"	13 29/32"	15 13/32"	16 29/32"	17 17/32"	19 1/32"
<b>Height</b>	34 1/32"	34 1/32"	34 1/32"	34 1/32"	34 1/32"	34 1/32"	34 1/32"	34 1/32"	34 1/32"	34 1/32"	34 1/32"	34 1/32"

\*39" and 42" wide cabinets have a 1-1/2" center stile.

Note: Doors may be replaced with glass doors. Cabinet Opening & Door/Drawer Sizes are estimated dimensions based on cabinet type.



# Wall Cabinets

W



## 42" Height Wall Cabinets

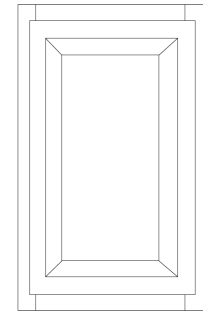
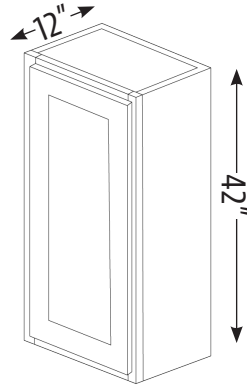

← 9" to 21" →

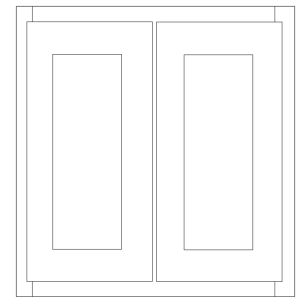
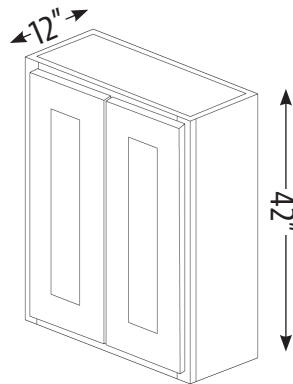

← 24" to 42" →

- Three full depth adjustable shelves included.

	W0942	W1242	W1542	W1842	W2142	W2442	W2742	W3042	W3342	W3642	W3942*	W4242*
Width	9"	12"	15"	18"	21"	24"	27"	30"	33"	36"	39"	42"
Height	42"	42"	42"	42"	42"	42"	42"	42"	42"	42"	42"	42"
Depth	12"	12"	12"	12"	12"	12"	12"	12"	12"	12"	12"	12"
# Doors	1	1	1	1	1	2	2	2	2	2	2	2
# Shelves	3	3	3	3	3	3	3	3	3	3	3	3

### Door Opening

Width	6"	9"	12"	15"	18"	21"	24"	27"	30"	33"	16 7/16"	17"
Height	39"	39"	39"	39"	39"	39"	39"	39"	39"	39"	39"	39"

### Door Size

Width	6 1/2"	9 1/2"	12 1/2"	15 1/2"	18 1/2"	11"	12 1/2"	14"	15 1/2"	17"	17"	18 1/2"
Height	39 1/32"	39 1/32"	39 1/32"	39 1/32"	39 1/32"	39 1/32"	39 1/32"	39 1/32"	39 1/32"	39 1/32"	39 1/32"	39 1/32"

\*39" and 42" wide cabinets have a 1-1/2" center stile.

Note: Doors may be replaced with glass doors. Cabinet Opening & Door/Drawer Sizes are estimated dimensions based on cabinet type.

## Blind Corner Wall Cabinets

	WBC2730	WBC2736	WBC2742
Width	27"	27"	27"
Height	30"	36"	42"
Depth	12"	12"	12"
Doors	1	1	1
Shelves	3	3	3

### Door Opening

Width	N/A	N/A	N/A
Height	N/A	N/A	N/A

### Door Size

Width	N/A	N/A	N/A
Height	N/A	N/A	N/A

Note: May be necessary to pull further to allow clearance for door hardware but not to be pulled further than 3". Cabinet Opening & Door/Drawer Sizes are estimated dimensions based on cabinet type.

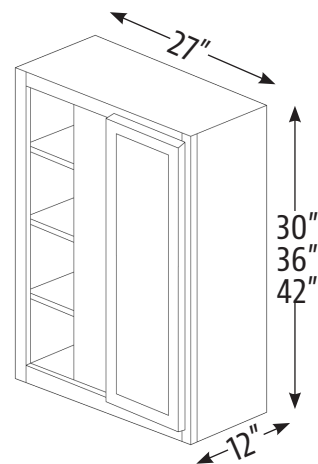

- Two full depth adjustable shelves.
- 2 1/2" stile exposed when using 12" deep cabinet on adjacent wall.
- 12" door overlays, 11" frame opening.
- May be used as a right or left blind corner.

## Angled End Wall Cabinets

	WCA1230	WCA1236	WCA1242
Width	17 1/16"	17 1/16"	17 1/16"
Height	30"	36"	42"
Depth	12"	12"	12"
# Doors	1	1	1
# Shelves	2	2	3

### Door Opening

Width	12 5/16"	12 5/16"	12 5/16"
Height	27"	33"	39"

### Door Size

Width	14 31/32"	14 31/32"	14 31/32"
Height	29 17/32"	35 17/32"	41 17/32"

Note: Cabinet Opening & Door/Drawer Sizes are estimated dimensions based on cabinet type.

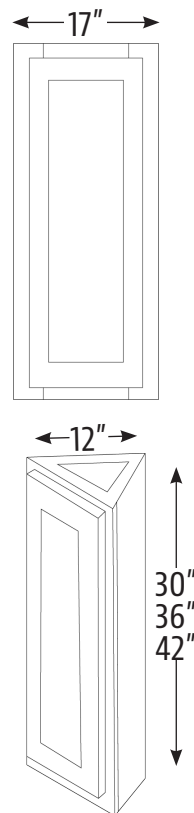

# Wall Cabinets

W



## Diagonal Corner Wall Cabinets

- Two to Three full depth adjustable shelves included.
- The WDC42PG comes with a plain glass door.

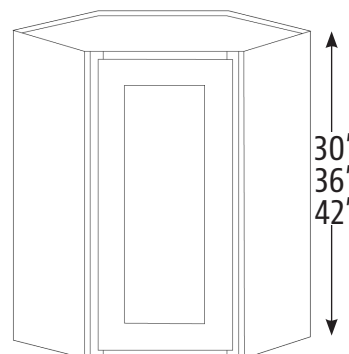

	WDC2430	WDC2436	WDC2442
Width	24"	24"	24"
Height	30"	36"	42"
Depth	12"	12"	12"
Doors	1	1	1
Shelves	2	2	3

### Door Opening

Width	12 7/16"	12 7/16"	12 7/16"
Height	27"	33"	39"

### Door Size

Width	13 7/16"	13 7/16"	13 7/16"
Height	28 1/32"	34 1/32"	40 1/32"

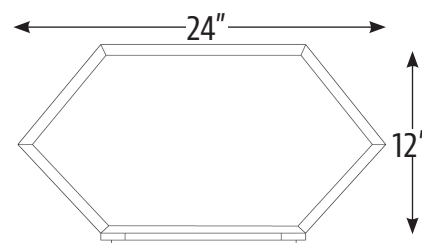

Note: Door may be replaced with diagonal glass door.

Cabinet Opening & Door/Drawer Sizes are estimated dimensions based on cabinet type.



## Diagonal Corner Wall Cabinet with Glass Door

- Two full depth adjustable shelves included.

- Comes with a plain glass door.

SKU	W	H	D	Shelves	Doors
WDC42PG	24"	30"	12"	2	1

Door Opening		Door Size	
W	H	W	H
12 7/16"	27"	13 7/16"	28 1/32"

Note: Cabinet Opening & Door/Drawer Sizes are estimated dimensions based on cabinet type.

## Spice Drawers Wall Cabinets

- Cabinet does not include drawer slides.
- Cabinet interior is finished and can be used without the drawers as a wine rack.

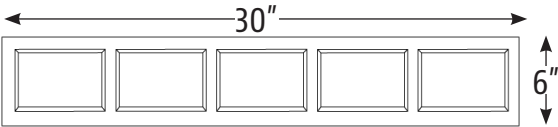

SKU	W	H	D	Drawers
WSC30	30"	6"	12"	5

Note: Drawers cannot be turned. If drawers are used the cabinet must be installed horizontally for them to function properly.

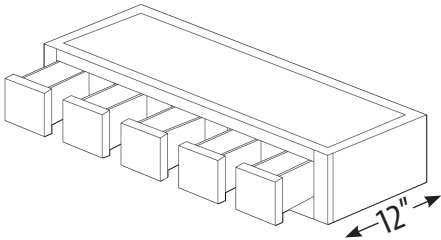

## Microwave Wall Cabinets

- Butt-style doors.
- For use with "counter" style microwaves.

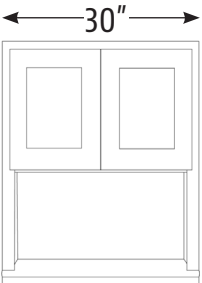
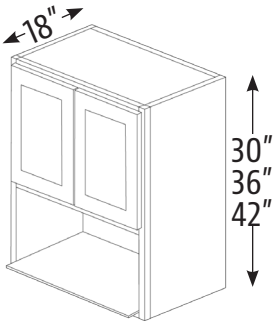

	MW3030	MW3036	MW3042
Width	30"	30"	30"
Height	30"	36"	42"
Depth	18"	18"	18"
# Doors	2	2	2

### Microwave Opening

Width	27"	27"	27"
Height	10 1/16"	16 1/16"	22 1/16"

### Door Opening

Width	27"	27"	27"
Height	9"	15"	21"

### Door Size

Width	14"	14"	14"
Height	9 1/2"	15 1/2"	21 1/2"

Note: Cabinet Opening & Door/Drawer Sizes are estimated dimensions based on cabinet type.



# Wall Cabinets

W

## Split Pantry 18" Height Wall Cabinets

\*Not available in Aspen White

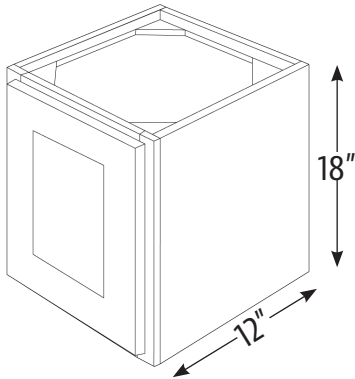

SKU	W	H	D	Doors
SDW1218	12"	18"	12"	1
SDW1518	15"	18"	12"	1
SDW1818	18"	18"	12"	1

Use for split pantry.

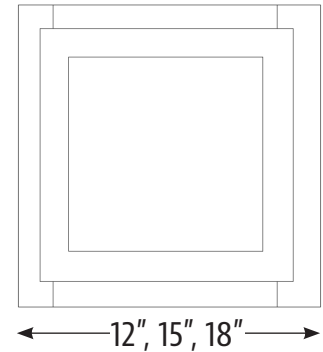

## Split Pantry 24" Depth Wall Cabinets

\*Not available in Aspen White

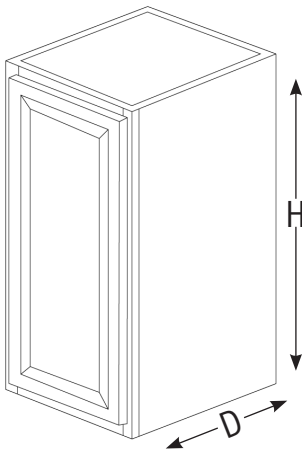

SKU	W	H	D	Doors
SDW183024	18"	30"	24"	1
SDW183624	18"	36"	24"	1
SDW184224	18"	42"	24"	1

Use for split pantry.

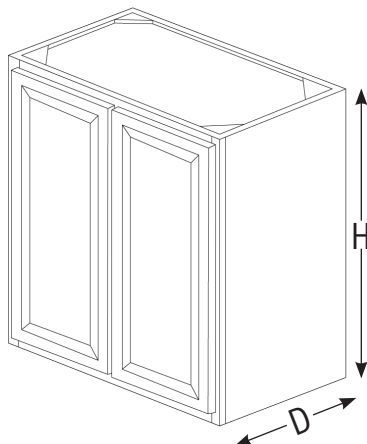
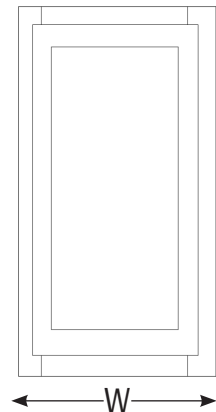

SKU	W	H	D	Doors
DDW243024	24"	30"	24"	2
DDW243624	24"	36"	24"	2
DDW244224	24"	42"	24"	2

DDW303024	30"	30"	24"	2
DDW303624	30"	36"	24"	2
DDW304224	30"	42"	24"	2

DDW363024	36"	30"	24"	2
DDW363624	36"	36"	24"	2
DDW364224	36"	42"	24"	2

Use for split pantry.

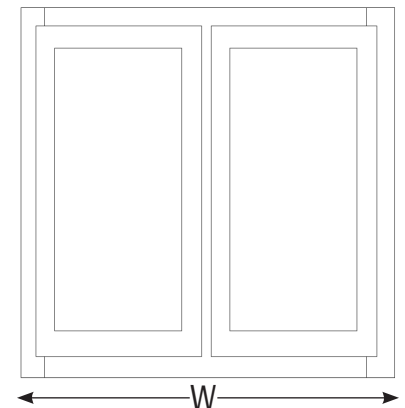

## Three Drawer Wall Cabinets

\*Not available in Aspen White

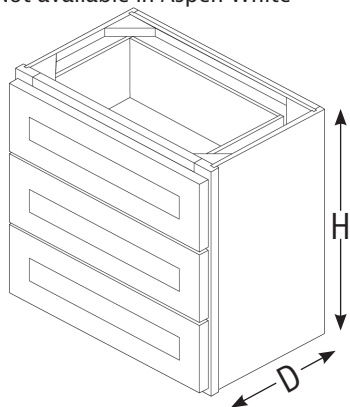

SKU	W	H	D	Drawers
W3DR18	18"	18"	15"	3
W3DR24	24"	18"	15"	3

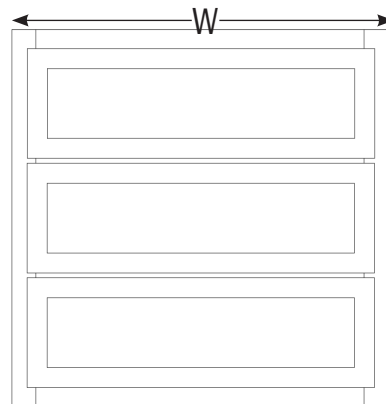

## Bridge Wall Cabinets

- Butt-style doors.
- 24" height bridge cabinets include one adjustable shelf.

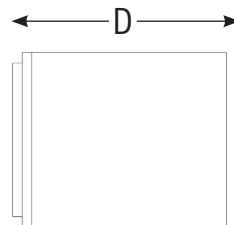
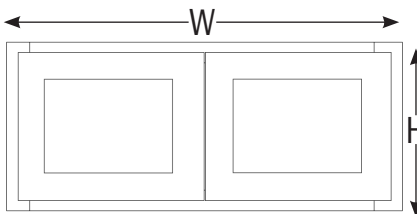

SKU	W	H	D	Shelves	Doors	Door Opening		Door Size	
						W	H	W	H
W3012	30"	12"	12"	0	2	27"	9"	14 <sup>7</sup> / <sub>8</sub> "	11 <sup>3</sup> / <sub>4</sub> "
W3015	30"	15"	12"	0	2	27"	12"	14 <sup>7</sup> / <sub>8</sub> "	14 <sup>3</sup> / <sub>4</sub> "
W3018	30"	18"	12"	0	2	27"	15"	14 <sup>7</sup> / <sub>8</sub> "	17 <sup>3</sup> / <sub>4</sub> "
W3021	30"	21"	12"	0	2	27"	18"	14 <sup>7</sup> / <sub>8</sub> "	20 <sup>3</sup> / <sub>4</sub> "
W3024	30"	24"	12"	1	2	27"	21"	14 <sup>7</sup> / <sub>8</sub> "	23 <sup>3</sup> / <sub>4</sub> "
W3312	33"	12"	12"	0	2	30"	9"	16 <sup>3</sup> / <sub>8</sub> "	11 <sup>3</sup> / <sub>4</sub> "
W3315	33"	15"	12"	0	2	30"	12"	16 <sup>3</sup> / <sub>8</sub> "	14 <sup>3</sup> / <sub>4</sub> "
W3318	33"	18"	12"	0	2	30"	15"	16 <sup>3</sup> / <sub>8</sub> "	17 <sup>3</sup> / <sub>4</sub> "
W3321	33"	21"	12"	0	2	30"	18"	16 <sup>3</sup> / <sub>8</sub> "	20 <sup>3</sup> / <sub>4</sub> "
W3324	33"	24"	12"	1	2	30"	21"	16 <sup>3</sup> / <sub>8</sub> "	23 <sup>3</sup> / <sub>4</sub> "
W3612	36"	12"	12"	0	2	33"	9"	17 <sup>7</sup> / <sub>8</sub> "	11 <sup>3</sup> / <sub>4</sub> "
W3615	36"	15"	12"	0	2	33"	12"	17 <sup>7</sup> / <sub>8</sub> "	14 <sup>3</sup> / <sub>4</sub> "
W3618	36"	18"	12"	0	2	33"	15"	17 <sup>7</sup> / <sub>8</sub> "	17 <sup>3</sup> / <sub>4</sub> "
W3621	36"	21"	12"	0	2	33"	18"	17 <sup>7</sup> / <sub>8</sub> "	20 <sup>3</sup> / <sub>4</sub> "
W3624	36"	24"	12"	1	2	33"	21"	17 <sup>7</sup> / <sub>8</sub> "	23 <sup>3</sup> / <sub>4</sub> "

Note: Cabinet Opening & Door/Drawer Sizes are estimated dimensions based on cabinet type.

# Wall Cabinets

W

## Decorative Stacker Wall Cabinets with Glass Doors

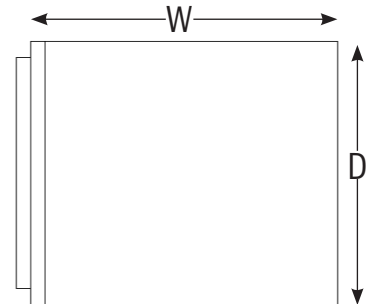
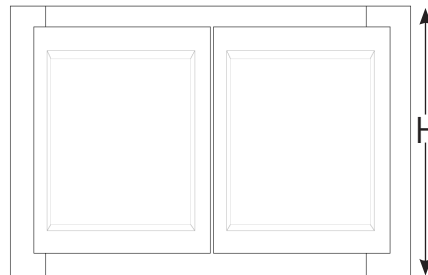
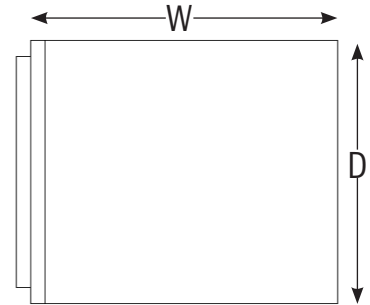
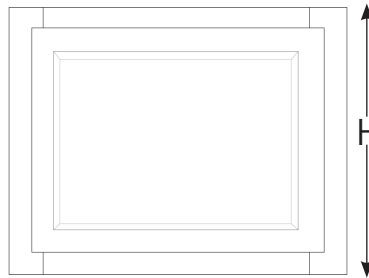

• Plain glass door(s) included.

Note: These cabinets come preassembled and do not have shelves.

SKU	W	H	D	Shelves	Doors	Door Opening		Door Size	
						W	H	W	H
W1212PG	12"	12"	12"	0	1	9"	9"	9 ½"	9 ½"
W1512PG	15"	12"	12"	0	1	12"	9"	12 ½"	9 ½"
W1812PG	18"	12"	12"	0	1	15"	9"	15 ½"	9 ½"
W2112PG	21"	12"	12"	0	1	18"	9"	18 ½"	9 ½"
W2412PG	24"	12"	12"	0	2	21"	9"	10 ¾"	9 ½"
W2712PG	27"	12"	12"	0	2	24"	9"	12 ¼"	9 ½"
W3012PG	30"	12"	12"	0	2	27"	9"	13 ¾"	9 ½"
W3312PG	33"	12"	12"	0	2	30"	9"	15 ¼"	9 ½"
W3612PG	36"	12"	12"	0	2	33"	9"	16 ¾"	9 ½"

Note: Cabinet Opening & Door/Drawer Sizes are estimated dimensions based on cabinet type.

# Wall Cabinets

## Refrigerator Wall Cabinets

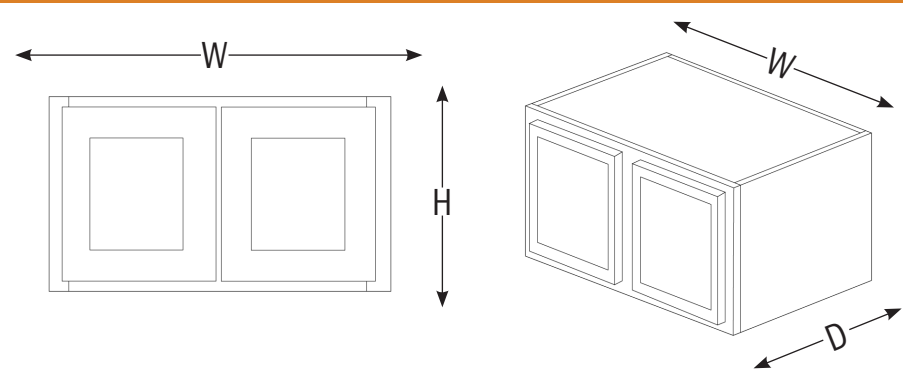

SKU	W	H	D	Shelves	Doors	Door Opening		Door Size	
						W	H	W	H
WR3315	33"	15"	24"	0	2	30"	12"	16 3/8"	14 3/4"
WR3324	33"	24"	24"	0	2	30"	21"	16 3/8"	23 3/4"
WR3612	36"	12"	24"	0	2	33"	9"	17 7/8"	11 3/4"
WR3615	36"	15"	24"	0	2	33"	12"	17 7/8"	14 3/4"
WR3618	36"	18"	24"	0	2	33"	15"	17 7/8"	17 3/4"
WR3621	36"	21"	24"	0	2	33"	18"	17 7/8"	20 3/4"
WR3624	36"	24"	24"	0	2	33"	21"	17 7/8"	23 3/4"

Note: Cabinet Opening & Door/Drawer Sizes are estimated dimensions based on cabinet type.

## Easy Reach Wall Cabinets

- \*Not available in Aspen White
- Includes two to three fully adjustable full depth shelves.

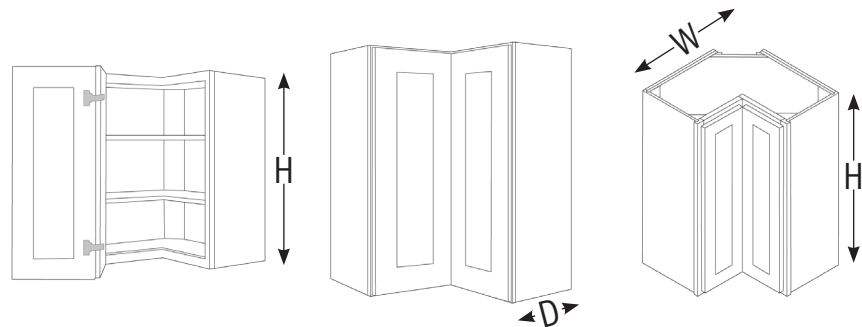

SKU	W	H	D	Shelves	Doors
WER2430	24"	30"	12"	2	2
WER2436	24"	36"	12"	2	2
WER2442	24"	42"	12"	3	2

Note: Cabinet Opening & Door/Drawer Sizes are estimated dimensions based on cabinet type.





# Base Cabinets

B

## Drawer/Door Base Cabinets

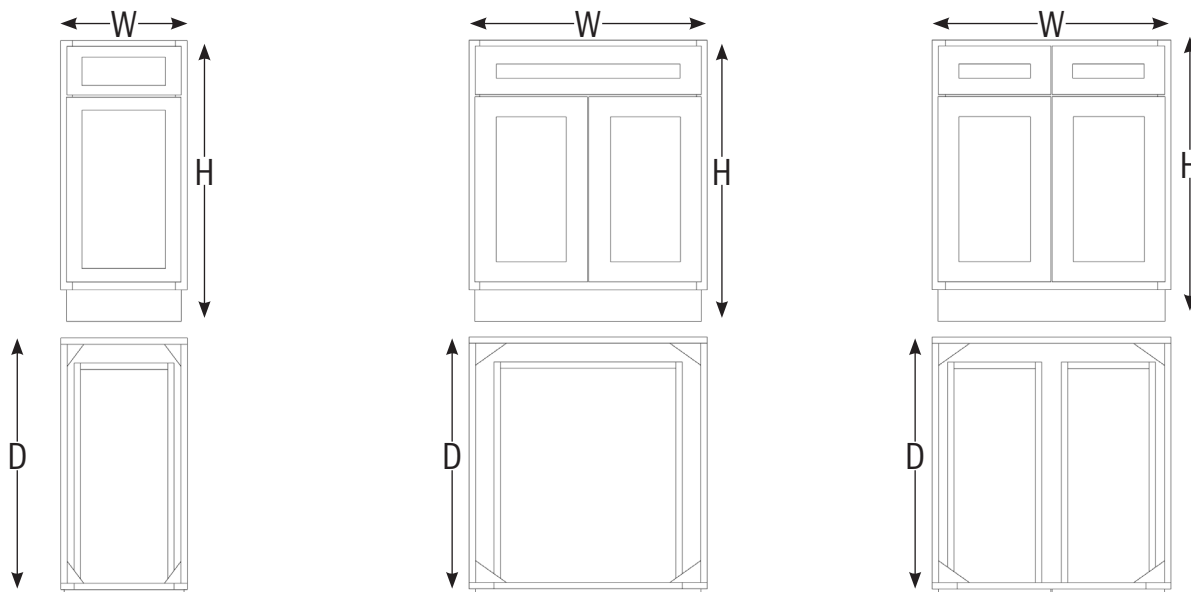

- Base cabinets include one half depth adjustable shelf.
- Butt-style doors on all 24" to 36" wide base cabinet.

Note: Any base cabinet 12" to 48" wide may be used as a sink base cabinet by simply not installing the drawer hardware and attaching only the drawer front(s) to the cabinet as a false front.

SKU	W	H	D	Doors	Drawers	Door Opening		Door Size		Drawer Opening		Drawer Size	
						W	H	W	H	W	H	W	H
B12	12"	34 ½"	24"	1	1	9"	20 ½"	11 ½"	22 ¼"	9"	5"	11 ½"	6 ¾"
B15	15"	34 ½"	24"	1	1	12"	20 ½"	14 ½"	22 ¼"	12"	5"	14 ½"	6 ¾"
B18	18"	34 ½"	24"	1	1	15"	20 ½"	17 ½"	22 ¼"	15"	5"	17 ½"	6 ¾"
B21	21"	34 ½"	24"	1	1	18"	20 ½"	20 ½"	22 ¼"	18"	5"	20 ½"	6 ¾"
B24	24"	34 ½"	24"	2	1	21"	20 ½"	11 ¾"	22 ¼"	21"	5"	23 ½"	6 ¾"
B27	27"	34 ½"	24"	2	1	24"	20 ½"	13 ¼"	22 ¼"	24"	5"	26 ½"	6 ¾"
B30	30"	34 ½"	24"	2	2	27"	20 ½"	14 ¾"	22 ¼"	13 ½"	5"	14 ¾"	6 ¾"
B33	33"	34 ½"	24"	2	2	30"	20 ½"	16 ¼"	22 ¼"	15"	5"	16 ¼"	6 ¾"
B36	36"	34 ½"	24"	2	2	33"	20 ½"	17 ¾"	22 ¼"	16 ½"	5"	17 ¾"	6 ¾"
B39	39"	34 ½"	24"	2	2	17 ¼"	20 ½"	19 ¼"	22 ¼"	18"	5"	19 ¼"	6 ¾"
B42	42"	34 ½"	24"	2	2	18 ¾"	20 ½"	20 ¾"	22 ¼"	19 ½"	5"	20 ¾"	6 ¾"
B48	48"	34 ½"	24"	2	2	21 ¾"	20 ½"	23 ¾"	22 ¼"	22 ½"	5"	23 ¾"	6 ¾"

Note: Cabinet Opening & Door/Drawer Sizes are estimated dimensions based on cabinet type.

# Base Cabinets

## Two Drawer Base Cabinets

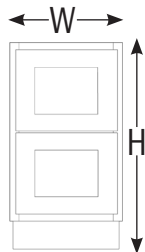
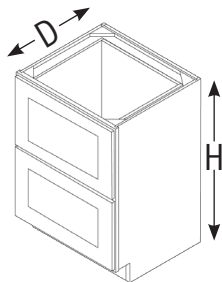

- Two fully functioning deep drawers.

\*Not available in Aspen White

SKU	W	H	D	Drawers	Drawer Opening		Drawer Size	
					W	H	W	H
2DB24	24"	34 1/2"	24"	2	21"	12 1/8" - 12 3/4"	23 17/32"	14 17/32"
2DB27	27"	34 1/2"	24"	2	24"	12 1/8" - 12 3/4"	26 17/32"	14 17/32"
2DB30	30"	34 1/2"	24"	2	27"	12 1/8" - 12 3/4"	29 17/32"	14 17/32"
2DB33	33"	34 1/2"	24"	2	30"	12 1/8" - 12 3/4"	32 17/32"	14 17/32"
2DB36	36"	34 1/2"	24"	2	33"	12 1/8" - 12 3/4"	35 17/32"	14 17/32"

Note: Cabinet Opening & Door/Drawer Sizes are estimated dimensions based on cabinet type.

## Three Drawer Base Cabinets

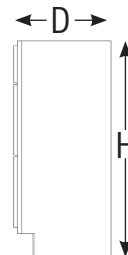
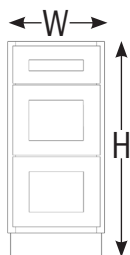
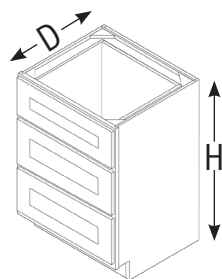

- One standard depth top drawer and two deep depth bottom drawers.

SKU	W	H	D	Drawers	Drawer Opening				Drawer Size			
					W	Top H	Middle H	Bottom H	W	Top H	Middle H	Bottom H
DB12	12"	34 1/2"	24"	3	9"	20 1/2"	11 1/2"	22 1/4"	9"	5"	11 1/2"	6 3/4"
DB15	15"	34 1/2"	24"	3	12"	20 1/2"	14 1/2"	22 1/4"	12"	5"	14 1/2"	6 3/4"
DB18	18"	34 1/2"	24"	3	15"	20 1/2"	17 1/2"	22 1/4"	15"	5"	17 1/2"	6 3/4"
DB21	21"	34 1/2"	24"	3	18"	20 1/2"	16 1/4"	22 1/4"	15"	5"	16 1/4"	6 3/4"
DB24	24"	34 1/2"	24"	3	21"	20 1/2"	17 3/4"	22 1/4"	16 1/2"	5"	17 3/4"	6 3/4"
DB30	30"	34 1/2"	24"	3	27"	20 1/2"	19 1/4"	22 1/4"	18"	5"	19 1/4"	6 3/4"
DB36	36"	34 1/2"	24"	3	33"	20 1/2"	20 3/4"	22 1/4"	19 1/2"	5"	20 3/4"	6 3/4"

Note: Cabinet Opening & Door/Drawer Sizes are estimated dimensions based on cabinet type.

# Base Cabinets

B

## Farm Sink Base Cabinets

- (x2) 18" high cabinet doors.
- Cabinet does not include shelves.

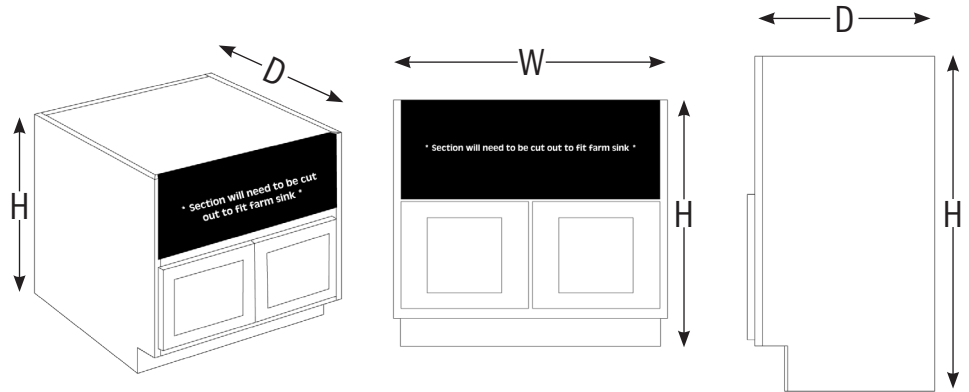

SKU	W	H	D	Doors	Drawers	Door Opening		Sink Space Available		Door Size	
						W	H	W	H	W	H
FSB36	36"	34 1/2"	24"	2	0	33"	14 13/16"	33"	12"	17 11/16"	17 17/32"

Note: Cabinet Opening & Door/Drawer Sizes are estimated dimensions based on cabinet type.

## Sink Base Cabinets

- Butt-Style Doors.

Note: Any base cabinet 12" to 48" may be used as a sink base cabinet by simply not installing the drawer hardware and attaching only the drawer face(s) to the cabinet as a false front.

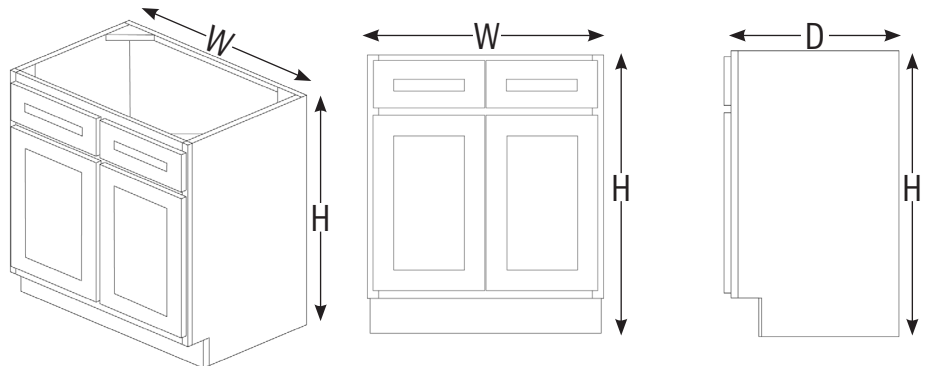

SKU	W	H	D	Doors	False Fronts	Door Opening		Drawer Opening		Door Size		Drawer Size	
						W	H	W	H	W	H	W	H
SB33	33"	34 1/2"	24"	2	2	30"	20 1/2"	30"	5"	16 3/16"	22 27/32"	32 17/32"	6 7/32"
SB36	36"	34 1/2"	24"	2	2	33"	20 1/2"	33"	5"	17 11/16"	22 27/32"	35 17/32"	6 7/32"

Note: Cabinet Opening & Door/Drawer Sizes are estimated dimensions based on cabinet type.



# Base Cabinets

## Diagonal Corner Sink Base Cabinets

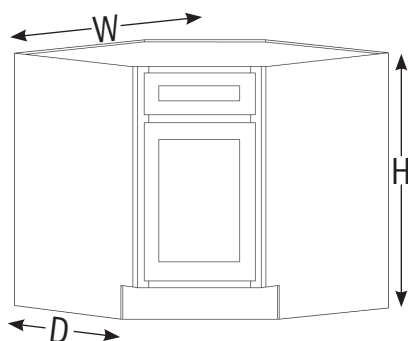

• This cabinets does not include any shelves.

SKU	W	H	D	Doors	False Fronts	Door Opening		Drawer Opening		Door Size		Drawer Size	
						W	H	W	H	W	H	W	H
DCSB36	36"	34 ½"	24"	1	1	N/A	N/A	N/A	N/A	N/A	N/A	N/A	N/A

Note: Cabinet Opening & Door/Drawer Sizes are estimated dimensions based on cabinet type.

## Easy Reach Base Cabinets

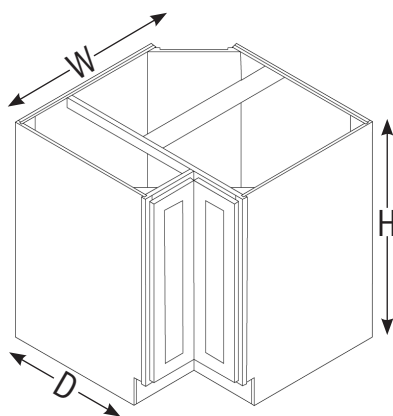

• This cabinet includes one fully adjustable shelf.

Note: Image to the left shown with two Lazy Susan single shelves (Sold Separately).

\*Not available in Aspen White

SKU	W	H	D	Bi-Fold Doors	Drawers	Door Opening		Door Size	
						W	H	W	H
BER33	33"	34 ½"	24"	1	0	10 3/16"	27"	7 ⅞"	29 9/32"
BER36	36"	34 ½"	24"	1	0	11 ½"	27"	10 ⅞"	29 9/32"

Note: Cabinet Opening & Door/Drawer Sizes are estimated dimensions based on cabinet type.

# Base Cabinets

B

## Microwave Base Cabinets

- One standard depth bottom dovetail drawer.

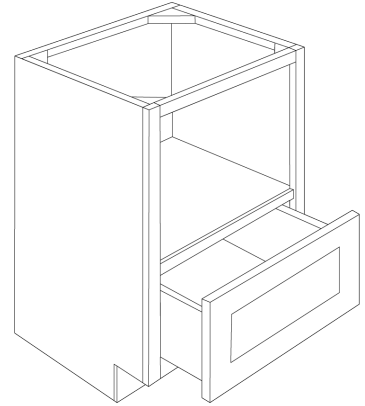
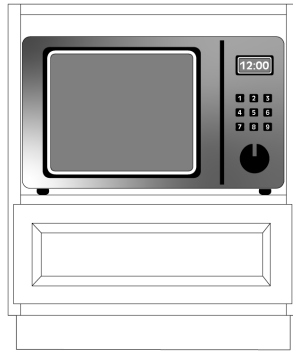

SKU	W	H	D	Doors	Drawers	Opening		Drawer Opening		Drawer Front Size	
						W	H	W	H	W	H
BMC27	27"	34 1/2"	24"	0	1	24"	12 13/16"	24"	6 1/4"	24"	8 5/16"
BMC30	30"	34 1/2"	24"	0	1	27"	15 13/16"	27"	9 1/4"	29 17/32"	11 5/16"

Note: Cabinet Opening & Door/Drawer Sizes are estimated dimensions based on cabinet type.

## Blind Corner Base Cabinets

- Adjustable to 45" W.
- 12-7/8" door overlay.
- 11-7/8" frame opening.
- Setup as left (L) or right (R) blind.

Note: May be necessary to pull cabinet further to allow clearance for door and drawer hardware. May not be pulled farther than 9". Full overlay cabinets must be pulled a minimum of 4".

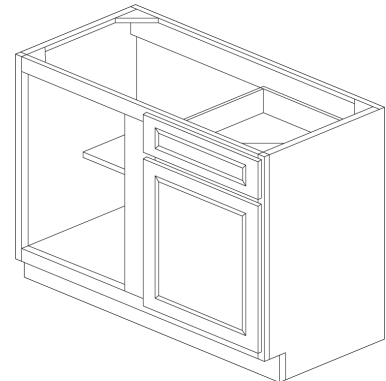

SKU	W	H	D	Doors	Drawers	Door Opening		Drawer Opening		Door Size		Drawer Size	
						W	H	W	H	W	H	W	H
BBC36	36"	34 1/2"	24"	1	1	13"	20 1/2"	13"	5"	14 7/8"	22 27/32"	14 7/8"	6 7/32"

Note: Cabinet Opening & Door/Drawer Sizes are estimated dimensions based on cabinet type.

# Base Cabinets

## Lazy Susan Base Cabinets

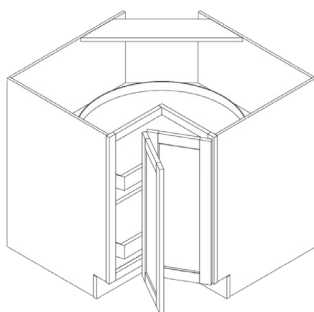
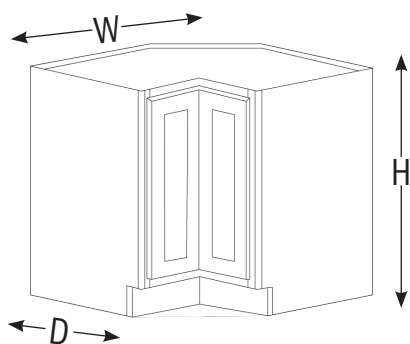

- Stainless steel lazy susan baskets included.
- Baskets are height adjustable.
- Doors may be mounted left (L) or right (R).

SKU	W	H	D	Bi-Fold Doors	Drawers	Door Opening		Door Size	
						W	H	W	H
LS3312	33"	34 1/2"	24"	2	0	10 3/16"	27"	7 1/8"	29 9/32"
LS3612	36"	34 1/2"	24"	2	0	11 1/2"	27"	10 1/8"	29 9/32"

Note: Cabinet Opening & Door/Drawer Sizes are estimated dimensions based on cabinet type.

## Angled End Base Cabinets

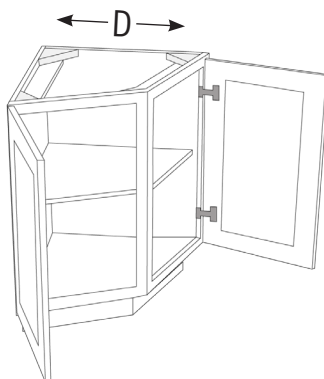
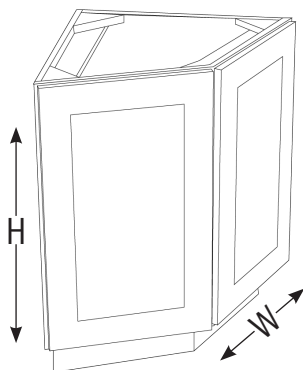

- (2) 18-1/4" W doors.
- One adjustable shelf.
- Doors may be replaced with 18" x 30" glass doors.

SKU	W	H	D	Doors	Drawers	Door Opening		Door Size	
						W	H	W	H
BA24	24"	34 1/2"	24"	2	0	15 1/4"	27"	18"	29 9/32"

Note: Cabinet Opening & Door/Drawer Sizes are estimated dimensions based on cabinet type.



# Base Cabinets

B

## Tray Base Cabinets

- This cabinet is great for trays and cookie sheets.
- No shelving included.

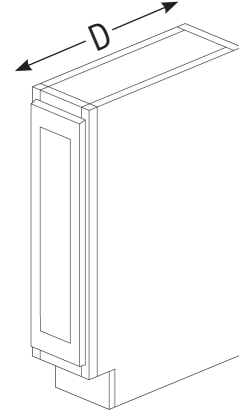
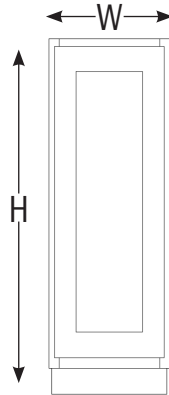

SKU	W	H	D	Doors	Drawers	Door Opening		Door Size	
						W	H	W	H
TB09	9"	34 1/2"	24"	1	0	6"	27"	8 17/32"	29 9/32"

Note: Cabinet Opening & Door/Drawer Sizes are estimated dimensions based on cabinet type.

## Corner Drawer Base Cabinets

- Three fully functioning drawers.
- Full extension drawer slides.
- (1) standard depth top drawer.
- (2) deep depth bottom drawers.

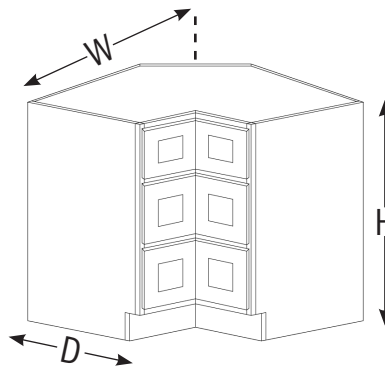

SKU	W	H	D	Doors	Drawers	Top Drawer Front		Middle Drawer Front		Bottom Drawer Front	
						W	H	W	H	W	H
CDB36	36"	34 1/2"	24"	0	3	7 1/8"	5"	7 1/8"	9"	7 1/8"	9 1/2"

Note: Cabinet Opening & Door/Drawer Sizes are estimated dimensions based on cabinet type.

# Base Cabinets

## Spice Drawers Base Cabinets

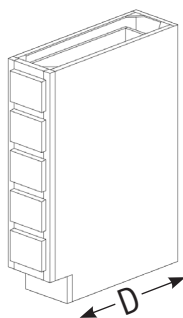
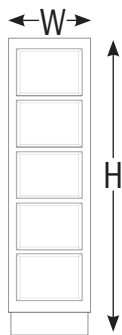

- Cabinets do not include drawer slides; due to drawer and drawer opening dimensions, drawer slides cannot be added to drawers.
- Cabinet interior is finished and can be used without the drawers as a wine rack.

SKU	W	H	D	Doors	Drawers	Drawer Opening		Drawer Size	
						W	H	W	H
BSD6	6"	34 ½"	24"	1	5	4"	4 ⅛"	4 ⅛"	4 ½"

Note: Cabinet Opening & Door/Drawer Sizes are estimated dimensions based on cabinet type.

## Spice Pull Out Base Cabinets

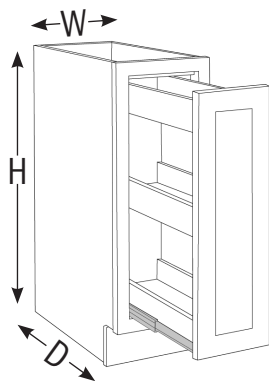

- Full extension slides included.

\*Not available in Aspen White

SKU	W	H	D	Doors	Drawers	Door Opening		Door Size	
						W	H	W	H
BSR9	9"	34 ½"	24"	1	0	6"	27"	8 17/32"	29 9/32"
BSR12	12"	34 ½"	24"	1	0	9"	27"	11 17/32"	29 9/32"

Note: Cabinet Opening & Door/Drawer Sizes are estimated dimensions based on cabinet type.

## 18" Wide Pantry Cabinets

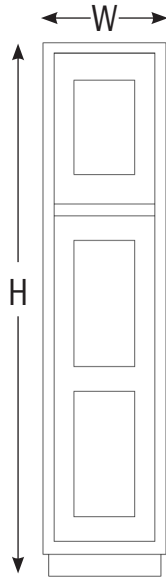

- Cabinet includes four adjustable shelves that may be used in either the top or lower sections.
- Lower section of this cabinet measures 54" tall.



SKU	W	H	D	Doors	Shelves	Top Door Opening		Top Door Size		Lower Door Opening		Lower Door Size	
						W	H	W	H	W	H	W	H
UC1884	18"	84"	24"	2	4	15"	27"	16 1/32"	28 1/32"	15"	47 1/2"	16 1/32"	48 17/32"
UC1890	18"	90"	24"	2	4	15"	33"	16 1/32"	34 1/32"	15"	47 1/2"	16 1/32"	48 17/32"
UC1896	18"	96"	24"	2	4	15"	39"	16 1/32"	40 1/32"	15"	47 1/2"	16 1/32"	48 17/32"

Note: Cabinet Opening & Door/Drawer Sizes are estimated dimensions based on cabinet type.



# Tall Cabinets

## 24" Wide Pantry Cabinets

- Cabinet includes four adjustable shelves that may be used in either the top or lower sections.
- Lower section of this cabinet measures 54" tall.

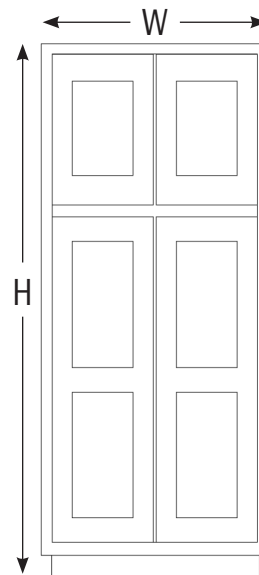

SKU	W	H	D	Doors	Shelves	Top Door Opening		Top Door Size		Lower Door Opening		Lower Door Size	
						W	H	W	H	W	H	W	H
UC2484	24"	84"	24"	4	4	21"	27"	11 11/16"	29 17/32"	21"	47 1/2"	11 11/16"	49 9/32"
UC2490	24"	90"	24"	4	4	21"	33"	11 11/16"	35 17/32"	21"	47 1/2"	11 11/16"	49 9/32"
UC2496	24"	96"	24"	4	4	21"	39"	11 11/16"	41 17/32"	21"	47 1/2"	11 11/16"	49 9/32"

Note: Cabinet Opening & Door/Drawer Sizes are estimated dimensions based on cabinet type.

## Universal Oven Cabinets

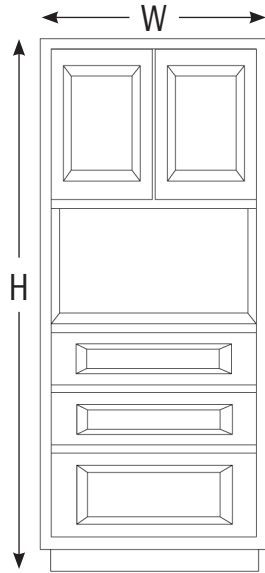

- Cabinet fits any standard size oven.
- Butt-style doors.
- (2) standard depth drawers.
- (1) Deep depth bottom drawer.



Note: the top two drawers of this cabinet may be removed to accommodate a variety of configurations; single oven, double oven or a oven/microwave combination.

SKU	W	H	D	Doors	Drawers	Door Size		Oven Opening	
						W	H	W	H
UOC3384	33"	84"	24"	2	3	16 1/4"	17"	26 1/2"	24 3/8"
UOC3390	33"	90"	24"	2	3	16 1/4"	23"	26 1/2"	24 3/8"
UOC3396	33"	96"	24"	2	3	16 1/4"	29"	26 1/2"	24 3/8"

Note: Cabinet Opening & Door/Drawer Sizes are estimated dimensions based on cabinet type.

## Split Pantry Wall Cabinets

\*Not available in Aspen White

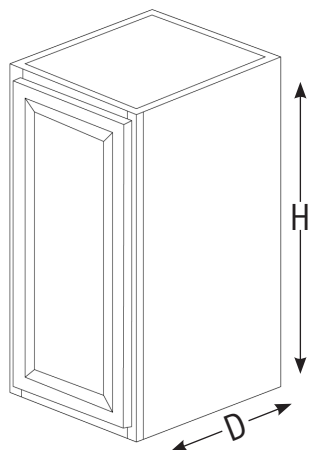

SKU	W	H	D	Doors
SDW183024	18"	30"	24"	1
SDW183624	18"	36"	24"	1
SDW184224	18"	42"	24"	1

Use for split pantry.

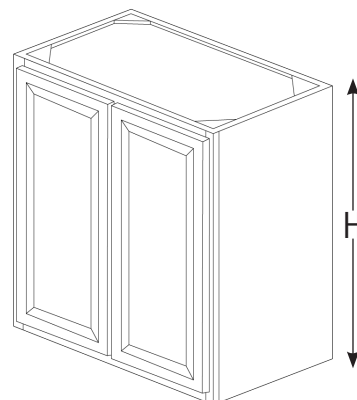

SKU	W	H	D	Doors
DDW243024	24"	30"	24"	2
DDW243624	24"	36"	24"	2
DDW244224	24"	42"	24"	2

Use for split pantry.

SKU	W	H	D	Doors
DDW303024	30"	30"	24"	2
DDW303624	30"	36"	24"	2
DDW304224	30"	42"	24"	2

Use for split pantry.

SKU	W	H	D	Doors
DDW363024	36"	30"	24"	2
DDW363624	36"	36"	24"	2
DDW364224	36"	42"	24"	2

Use for split pantry.

## Split Pantry Base Cabinets

\*Not available in Aspen White

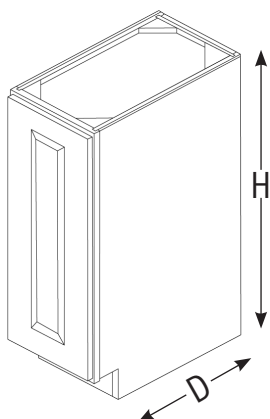

SKU	W	H	D	Doors	Drawers
UCB1854	18"	54"	24"	1	0
UCB2454	24"	54"	24"	2	0
UCB3054	30"	54"	24"	2	0
UCB3654	36"	54"	24"	2	0

Use for split pantry.

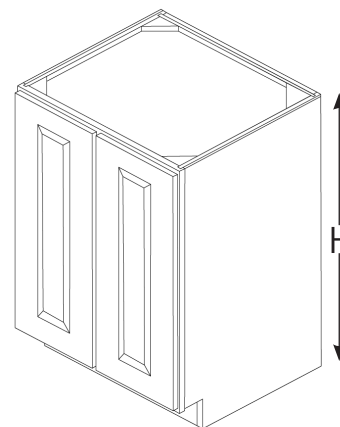

# Vanity Cabinets

V

## Vanity Drawer Base Cabinets

- Three fully functioning drawers with full extensions slides.
- (1) standard depth top drawer.
- (2) deep depth bottom drawers.

	VDB1221	VDB1521	VDB1821	VDB2121	VDB2421
<b>Width</b>	12"	15"	18"	21"	24"
<b>Height</b>	34 ½"	34 ½"	34 ½"	34 ½"	34 ½"
<b>Depth</b>	21"	21"	21"	21"	21"
<b>Drawers</b>	3	3	3	3	3

### Top Drawer Opening

<b>Width</b>	9"	12"	15"	18"	21"
<b>Height</b>	5"	5"	5"	5"	5"

### Bottom Two Drawers Opening

<b>Width</b>	9"	12"	15"	18"	21"
<b>Height</b>	9" - 9 ½"	9" - 9 ½"	9" - 9 ½"	9" - 9 ½"	9" - 9 ½"

Note: Cabinet Opening & Door/Drawer Sizes are estimated dimensions based on cabinet type.

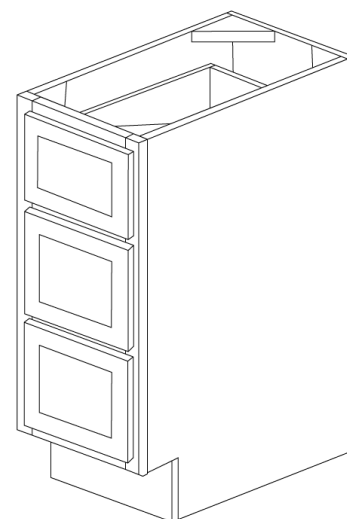

## Vanity Base Cabinets

\*Not available in Aspen White

	VB12	VB15	VB18
<b>Width</b>	12"	15"	18"
<b>Height</b>	34 ½"	34 ½"	34 ½"
<b>Depth</b>	21"	21"	21"
<b>Doors</b>	1	1	1
<b>Drawers</b>	1	1	1

### Door Opening

<b>Width</b>	9"	12"	15"
<b>Height</b>	20 ½"	20 ½"	20 ½"

### Drawer Opening

<b>Width</b>	9"	12"	15"
<b>Height</b>	5"	5"	5"

Note: Cabinet Opening & Door/Drawer Sizes are estimated dimensions based on cabinet type.

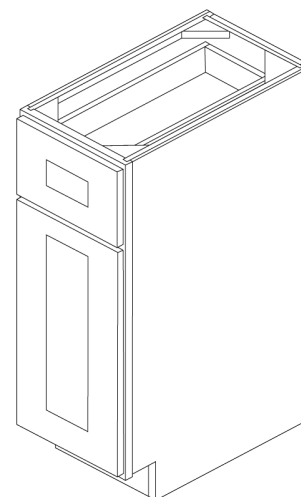



## Vanity Base Cabinets

- Butt Style Doors.
- These cabinets do not have any drawers or shelves.

	V2121	V2421	V2721	V3021	V3621
Width	21"	24"	27"	30"	36"
Height	34 ½"	34 ½"	34 ½"	34 ½"	34 ½"
Depth	21"	21"	21"	21"	21"
Doors	1	1	2	2	2
False Fronts	1	1	1	2	2

### Door Opening

Width	18"	21"	24"	27"	33"
Height	20 ½"	20 ½"	20 ½"	20 ½"	20 ½"

### False Drawer Front Size

Width	18"	21"	24"	27"	33"
Height	5"	5"	5"	5"	5"

Note: Cabinet Opening & Door/Drawer Sizes are estimated dimensions based on cabinet type.

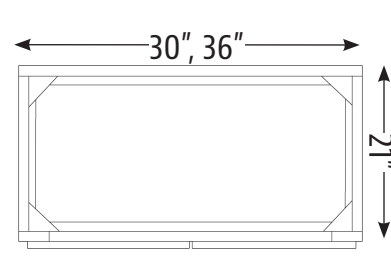
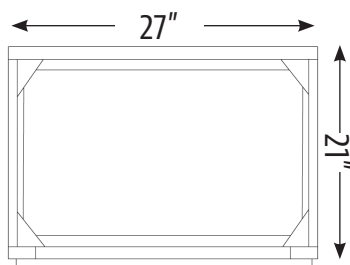
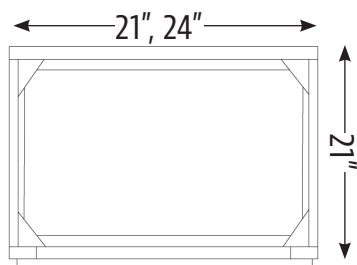
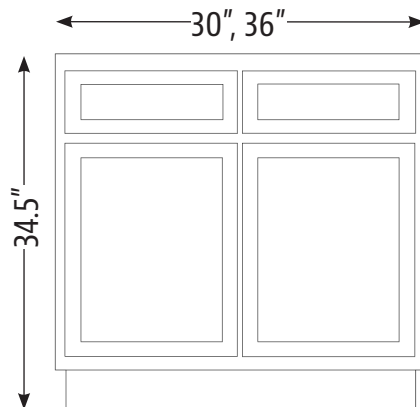
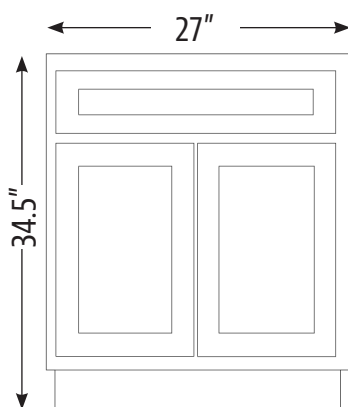
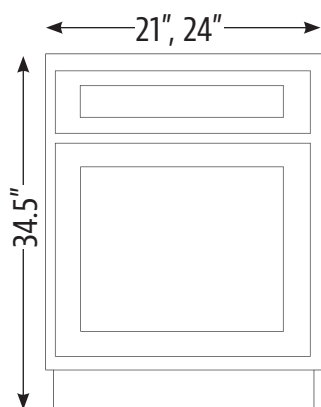

# Vanity Cabinets

V

## Vanity Base Cabinets w/ Drawers

\*V4221D (L/R) not available in Aspen White

- Two top false drawer fronts.
- Two deep fully functioning bottom drawers.
- These cabinets do not have any shelves and only the bottom two drawers are fully functional.

	V2421DL	V2421DR	V3021DL	V3021DR	V3621DL	V3621DR	V4221DL	V4221DR
<b>Width</b>	24"	24"	30"	30"	36"	36"	42"	42"
<b>Height</b>	34 1/2"	34 1/2"	34 1/2"	34 1/2"	34 1/2"	34 1/2"	34 1/2"	34 1/2"
<b>Depth</b>	21"	21"	21"	21"	21"	21"	21"	21"
<b>Doors</b>	1	1	1	1	1	1	2	2
<b>False Fronts</b>	2	2	2	2	2	2		

### Door Opening

<b>Width</b>	N/A	N/A	N/A	N/A	N/A	N/A	N/A	N/A
<b>Height</b>	N/A	N/A	N/A	N/A	N/A	N/A	N/A	N/A

### Bottom Drawers Opening

<b>Width</b>	N/A	N/A	N/A	N/A	N/A	N/A	N/A	N/A
<b>Height</b>	N/A	N/A	N/A	N/A	N/A	N/A	N/A	N/A

Note: Cabinet Opening & Door/Drawer Sizes are estimated dimensions based on cabinet type.

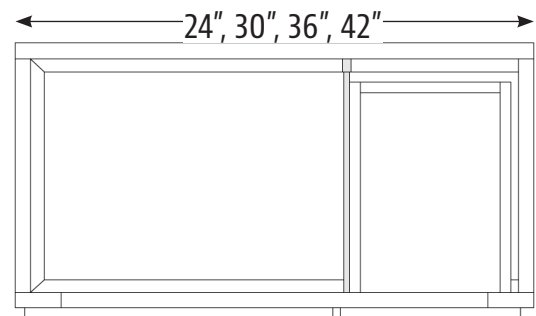
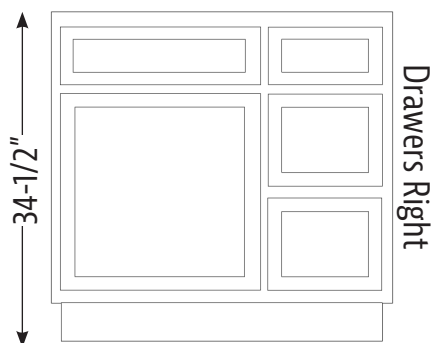
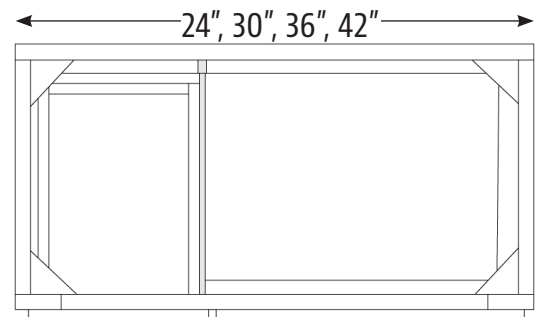
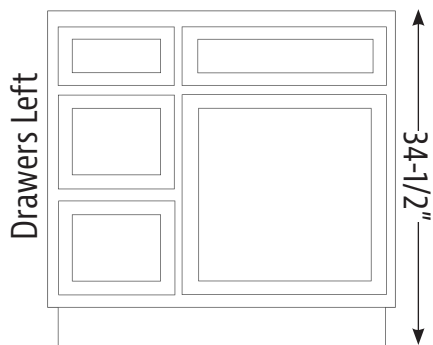

# Vanity Cabinets

## Vanity Base Cabinets w/ Double Drawers

- Six fully functioning drawers.
- Top drawers are standard depth.
- Bottom drawers are deep depth.
- Butt Style Doors.
- These cabinets do not have any shelves.

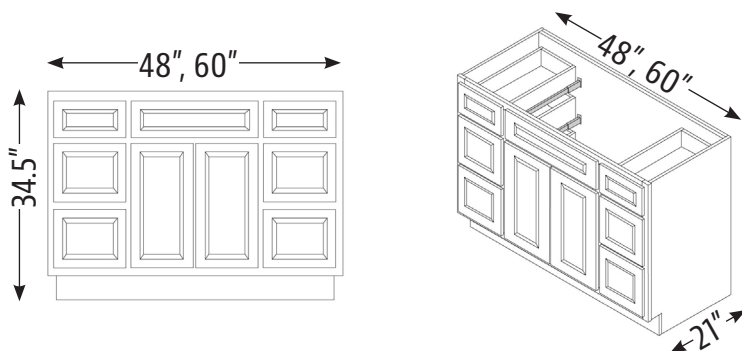

SKU	W	H	D	Doors	Drawers	False Fronts	Door(s) Opening		Door(s) Size	
							W	H	W	H
V4821DD	48"	34 1/2"	21"	2	6	1	N/A	N/A	N/A	N/A
V6021DD	60"	34 1/2"	21"	2	6	1	27"	20 1/2"	14 11/16"	22 27/32"

Note: Cabinet Opening & Door/Drawer Sizes are estimated dimensions based on cabinet type.

## Vanity Double Sink Base Cabinets

- Three fully functioning drawers.
- Top drawer standard depth.
- Bottom drawers are deep depth.
- Butt Style Doors.
- These cabinets do not have any shelves.

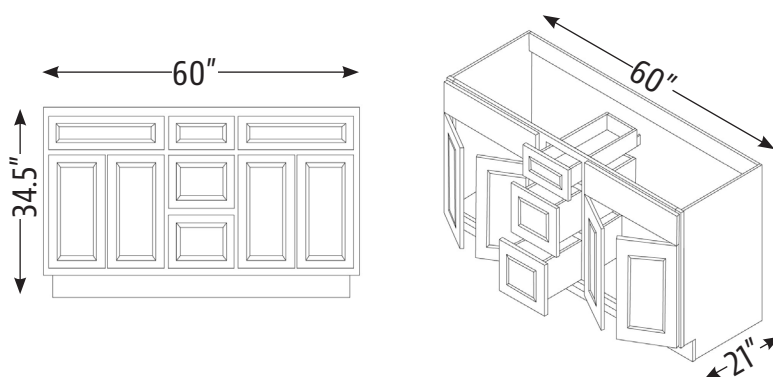

SKU	W	H	D	Doors	Drawers	False Fronts	Door(s) Opening		Door(s) Size	
							W	H	W	H
VSDB60	60"	34 1/2"	21"	4	3	2	21"	20 1/2"	11 11/16"	22 27/32"

Note: Cabinet Opening & Door/Drawer Sizes are estimated dimensions based on cabinet type.

# Accessories

A

## Appliance Garage

SKU	W	H	D	Doors
AG2418	24"	18"	12"	1

(x2) 18-¼" door fronts.  
Designed for installation on countertop.

Fits directly below a wall diagonal corner cabinet.  
There are no shelves in this cabinet.

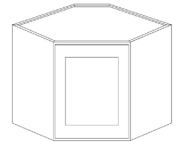

\*Not available in Aspen White

## Finished Floating Shelves

SKU	W	H	D
FFS24	24"	2 ½"	10"
FFS30	30"	2 ½"	10"
FFS36	36"	2 ½"	10"
FFS42	42"	2 ½"	10"

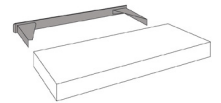

## Range Hood Fronts

SKU	W	H	D
RHF30	30"	23 ½"	8"
RHF36	36"	23 ½"	8"

Installation Notes: before installation of range hood front, the blower MUST be installed first and the depth adjusted using filler and/or panels to fit the blower. The range hood MUST be installed between two cabinets for support.

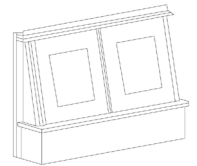

## Plate Rack Cabinets

SKU	W	H	D
PR3015	30"	15"	12"

Holds up to 10 plates.

Plate rack may be used inbetween wall cabinets.

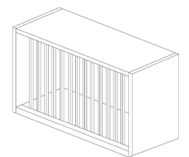

\*Not available in Aspen White

## Toilet Topper Cabinets

SKU	W	H	D	Doors	Drawers
TT2436	24"	36"	8"	2	1

Includes one drawer.

Two butt-style doors.

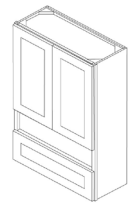

## Under Counter Drawers

SKU	W	H	D
UCD30	30"	7"	21"
UCD36	36"	7"	21"

Designed to be installed under counter to create a desk area.  
Can be installed between 21" depth vanity cabinets or 24" depth base cabinets.





# Accessories



## Universal Roll Out Trays

SKU	W	H	D
ROT15	15"	3 ½"	20 ½"
ROT18	18"	3 ½"	20 ½"
ROT21	21"	3 ½"	20 ½"
ROT24	24"	3 ½"	20 ½"
ROT27	27"	3 ½"	20 ½"
ROT30	30"	3 ½"	20 ½"
ROT33	33"	3 ½"	20 ½"
ROT36	36"	3 ½"	20 ½"

May be used in any 24" deep cabinet.

Installation: For partial overlay cabinets, order according to the width of the cabinet  
For full overlay cabinets, order according to the width of the cabinet if NOT being installed between hinges. If the roll out tray is to be installed between hinges, order one size smaller and use shims for installation. This is done so the tray will clear the hinges when opening.



## Glass Panel Doors for Diagonal Corner Wall Cabinets

SKU	W	H	Thickness
PGWDC30	24"	30"	¾"
PGWDC36	24"	36"	¾"
PGWDC42	24"	42"	¾"

Glass doors match the profile/color of the selected door style.

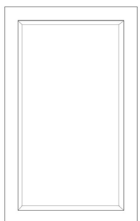

## Glass Panel Doors for Single Door Wall Cabinets

\*Not available in West Point Grey and Aspen White

SKU	W	H	Thickness
PG1530	15"	30"	¾"
PG1536	15"	36"	¾"
PG1542	15"	42"	¾"
PG1830	18"	30"	¾"
PG1836	18"	36"	¾"
PG1842	18"	42"	¾"
PG2130	21"	30"	¾"
PG2136	21"	36"	¾"
PG2142	21"	42"	¾"

Glass doors match the profile/color of the selected door style.

# Accessories

A

\*Not available in West Point Grey and Aspen White

## Glass Panel Doors for Double Door Wall Cabinets

SKU	W	H	Thickness
PG2430	24"	30"	3/4"
PG2436	24"	36"	3/4"
PG2442	24"	42"	3/4"
PG3030	30"	30"	3/4"
PG3036	30"	36"	3/4"
PG3042	30"	42"	3/4"
PG3630	36"	30"	3/4"
PG3636	36"	36"	3/4"
PG3642	36"	42"	3/4"



Glass doors match the profile/color of the selected door style.

\*Not available in Aspen White

## Three Drawers Wall Cabinets

SKU	W	H	D
W3DR18	18"	18"	15"
W3DR24	24"	18"	15"

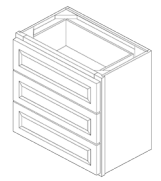

## Stem Glass Holders

SKU	W	H	D
SGH	30"	2"	12"

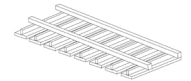

Holds six rows of glasses; 18 standard size wine glasses.

Fitted to mount under any 30" wide standard wall cabinet, stacker cabinet or bridge wall cabinet.

## Lattice Wine Racks

SKU	W	H	D
LWR3015	15"	30"	12"

Cabinet will hold up to eleven 3 3/4" diameter bottles of wine wine.

Cabinet may be installed vertically or horizontally.

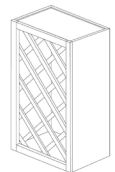

\*Not available in Aspen White

## Wine Storage Cubes

SKU	W	H	D
WINEESC1515	15"	15"	12"
WINEESC1818	18"	18"	12"

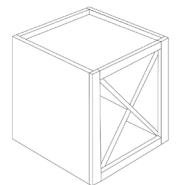

# Panels

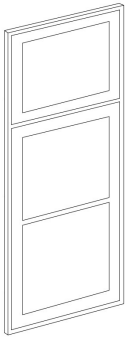
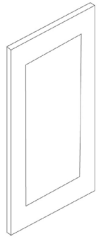

## Decorative End Panels

SKU	W	H	Thickness
For Wall Cabinets			
DP1230	11"	27 5/8"	3/4"
DP1236	11"	33 5/8"	3/4"
DP1242	11"	39 7/8"	3/4"
For Base Cabinets			
DP2430	22 7/8"	27 3/4"	3/4"
For Tall Cabinets *Not available in Aspen White			
MTEP84	23 1/2"	79"	3/4"
MTEP90	23 1/2"	85"	3/4"
MTEP96	23 1/2"	91"	3/4"
For Vanity Cabinets *Not available in Aspen White			
MVEPBH	20 1/2"	29"	3/4"

Panel match the profile/color of the selected door style.

## Cabinet End Panels

SKU	W	H	Thickness	Front Trim
For Wall Cabinets				
WEP1542	15"	42"	1/2"	3"
For Base Cabinets				
BEP3	24"	34 1/2"	1/2"	3"
For Tall Cabinets				
REP9624	24"	96"	1/2"	1 1/2"

May be trimmed to desired height and/or width.

Finished on both sides.

May be used on either left or right side of cabinets.

## Cabinet Skins

SKU	W	H	Thickness
For Wall Cabinets			
WS1542	15"	42"	1/4"
For Base Cabinets			
BS2435*	24"	34 1/2"	1/4"
For Tall Cabinets			
TS2496*	24"	96"	1/4"

May be trimmed to desired height and/or width.

\*BS2435 & TS2496 are only available in Winchester Grey and Hickory Shaker.

# Panels

P

## Island Panels

SKU	W	H	Thickness
IS3696	36"	96"	1/2"

Panels may be trimmed to desired height and/or width.



## Stained Plywood Panels

SKU	W	H	Thickness
SPW	36"	96"	1/4"

Panels may be trimmed to desired height and/or width.



\*Not available in Aspen White

## Edgebanded Plywood Panels

SKU	W	H	Thickness
PLYEB42	42"	96"	1/2"

Panels may be trimmed to desired height and/or width.



\*Not available in Aspen White

## Bead Board Panels

SKU	W	H	Thickness
BBFBP4896	48"	96"	1/4"

Panels may be trimmed to desired height and/or width.





# Fillers

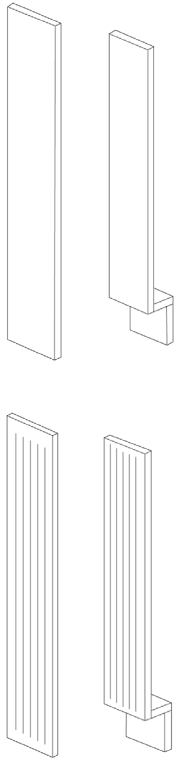

## Fillers

SKU	W	H	Thickness
<b>Wall Fillers</b>			
WF342	3"	42"	$\frac{3}{4}"$
WF642	6"	42"	$\frac{3}{4}"$
<b>Fluted Wall Fillers</b>			
WFF342	3"	42"	$\frac{3}{4}"$
WFF642	6"	42"	$\frac{3}{4}"$
<b>Base Fillers</b>			
BF3	3"	34 $\frac{1}{2}"$	$\frac{3}{4}"$
BF6	6"	34 $\frac{1}{2}"$	$\frac{3}{4}"$
<b>Fluted Base Fillers</b>			
BFF3	3"	34 $\frac{1}{2}"$	$\frac{3}{4}"$
BFF6	6"	34 $\frac{1}{2}"$	$\frac{3}{4}"$
<b>Tall Fillers</b>			
WF396	3"	96"	$\frac{3}{4}"$
TF396	3"	96"	$\frac{3}{4}"$
<b>Fluted Tall Fillers</b>			
WFF396	3"	96"	$\frac{3}{4}"$
TF396	3"	96"	$\frac{3}{4}"$

May be trimmed to desired height and/or width.

Flutes begin 1.5" from the top and end 1.5" from the bottom.

The toe kick area is not fluted.

# Moldings & Trim

M

\*CBLPN2 not available in Midnight Black Shaker

## Corbels

SKU	W	H	D
CBLPN2	4 ¾"	9 ½"	5"
CBLPN3	6 ¼"	13 ¼"	6 ½"



## Toe Kicks

SKU	H	L	Thickness
TK8	4 ½"	96"	¼"



Moldings may be trimmed to desired length.

\*LVC not available in Aspen White and West Point Grey

## Crown Moldings

SKU	D	H	L
LCM8	2 ½"	3 ⅜"	96"
LVC	2 ½"	2 ⅝"	96"

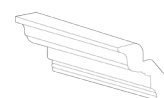

Moldings may be trimmed to desired length.

Flat section on crown molding may be used with the rope insert.

When applying crown molding to full overlay cabinets, a crown backer will be required.

## Batten Moldings

SKU	H	L	Thickness
BM8	1 21/32"	96"	¼"

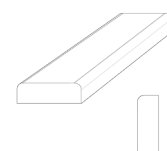

Moldings may be trimmed to desired length.

## Light Rail Moldings

SKU	W	H	L
LRM8	1 7/16"	1"	96"



Moldings may be trimmed to desired length.

## Scribe Moldings

SKU	H	L	Thickness
SM8	¾"	96"	¼"

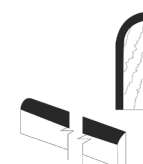

Moldings may be trimmed to desired length.

For use behind a light rail molding when wrapping around side of cabinet.

## Shoe Moldings

SKU	H	L	Thickness
SHM8	¾"	96"	½"



Moldings may be trimmed to desired length.

# Moldings & Trim

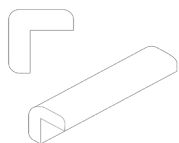

## Outside Corner Moldings

SKU	H	L	Thickness
OCS8	13/16"	96"	1/4"

Moldings may be trimmed to desired length.

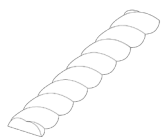

## Rope Insert Moldings

SKU	H	L	Thickness
ROPE8	9/16"	96"	1/4"

Moldings may be trimmed to desired length.

For use with crown molding.



## Arched Valance Moldings

SKU	H	L	Thickness
VA48	4 1/2"	48"	3/4"

Moldings may be trimmed to desired length.

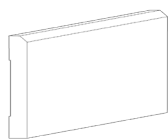

## Decorative Base Moldings

SKU	H	L	Thickness
DEC004	4 1/2"	96"	11/16"

Moldings may be trimmed to desired length.



## Decorative Split Leg Moldings

SKU	W	H	Thickness
SCDL	3"	42"	1 3/8"

# Samples & Repair



## Sample Doors

SKU	W	H	Thickness
DD	11"	15"	3/4"



## Touch-Up Kits

SKU	
TUK	Includes (1) Wax Stick and (1) Marker Pen



## WASTE CONTAINERS

SKU	DESCRIPTION	CABINET
RV53WC1535SCDM112	Single 35qt Soft Close Steel Bottom Mount Champagne	B15
RV53WC1535SCDM113	Single 35qt Soft Close Steel Bottom Mount Orion Gray	B15
RV53WC1535SCDM117	Single 35qt Soft Close Steel Bottom Mount Metallic Silver	B15
RV53WC1527SCDM217	Double 27qt Soft Close Steel Bottom Mount Metallic Silver	B15
RV53WC2150SCDM217	Double 50qt Soft Close Steel Bottom Mount Metallic Silver	B18

## BASE ORGANIZERS

SKU	DESCRIPTION	CABINET
RV448BCSC5C	5" Base Organizer w/Blum Soft Close	TB09
RV448UTBCSC5C	5" Pull-Out Utensil Bins w/Blum Soft Close	TB09
RV448KBBCSC5C	5" Pull-Out w/Knife Block & Utensil Bins w/Blum Soft Close	TB09
RV447BCSC5C	5" Pull-Out Tray Divider and Foil Wrap Holder	TB09
RV448BDDSC8C	8" Base Organizer Door/Drawer	B12
RV448BDDSC11C	11" Base Organizer Door/Drawer	B15
RV59712CR	Tray Divider w/Clips	Various Base
RV59718CR52	Tray Divider w/Clips	Various Base
RV59718CR10	Tray Divider w/Clips (Bulk)	Various Base
RV432BFSC3C	3" Base Fille Blum Soft Close	BF3
RV432BFSC6C	6" Base Filler Pull-Out Blum Soft Close	BF6







## DRAWER ORGANIZERS

SKU	DESCRIPTION	CABINET
RV4WCT1	Trimmable Cutlery Tray Insert	B15, DB15, B18, DB18
RV4WCT3	Trimmable Cutlery Tray Insert	B21, DB21, B24, DB24
RV4WUT1	Trimmable Utensil Drawer Insert	B15, DB15, B18, DB18
RV4WUT3	Trimmable Utensil Drawer Insert	B21, DB21, B24, DB24
RV4WUT361	Trimmable Utensil Drawer Insert	DB30, DB36
RV4WUTKB361	Knife Block/Utensil Drawer Insert	DB30, DB36
RV4WUTCT361	Utensil/Cutlery Drawer Insert	DB30, DB36
RV4WDKB	Trimmable Knife Block	B21 & DB21 or smaller
RV4WDKBWN	Trimmable Knife Block	B21 & DB21 or smaller
RV4DPS2421	Small Peg Drawer System (9 Pegs)	2DB24, 2DB27
RV4DPSWN2421	Small Peg Drawer System (9 Pegs)	2DB24, 2DB27
RV4DPS3021	Medium Peg Drawer System (12 Pegs)	2DB30, 2DB33
RV4DPSWN3021	Medium Peg Drawer System (12 Pegs)	2DB30, 2DB33
RV4DPS3921	Large Peg Drawer System (16 Pegs)	2DB36
RV4DPSWN3921	Large Peg Drawer System (16 Pegs)	2DB36
RV4DPSPEG4	(4) Maple Pegs	
RV4DPSPEGWN4	(4) Walnut Pegs	

## TALL CABINETS

SKU	DESCRIPTION	CABINET
RV448TP43141	14" Wood Pull-Out Pantry	UC1884, UC1890, UC1896



## WALL CABINETS



SKU	DESCRIPTION	CABINET
RV4SR15	Wood Spice Rack 15" Wall	W1530, W1536, W1542
RV4SR18	Wood Spice Rack 18" Wall	W1830, W1836, W1842
RV4SR21	Wood Spice Rack 21" Wall	W2130, W2136, W2142
RV432WFBBS303C	3" Wall Filler Pull-Out 30" Tall	WF342
RV432WFBBS363C	3" Wall Filler Pull-Out 36" Tall	WF342
RV432WFBBS423C	3" Wall Filler Pull-Out 42" Tall	WF342
RV432WFBBS306C	3" Wall Filler Pull-Out 30" Tall	WF642
RV432WFBBS366C	3" Wall Filler Pull-Out 36" Tall	WF642
RV432WFBBS426C	3" Wall Filler Pull-Out 42" Tall	WF642
RVLD4BW062201	20" LD Banded Wood Full Circle 2 Shelf Set 26"-31" Telescoping Post	WDC2430
RVLD4BW06320361	20" LD Banded Wood Full Circle 3 Shelf Set 38"-46" Telescoping Post	WDC2436
RV3072201152	18" (2) Shelf Set 26-31" Telescoping Post	WDC2430
RV30731811531	18" (3) Shelf Set 31"-38" Telescoping Post	WDC2436
RV30731811536	18" (3) Shelf Set 38-46" Telescoping Post	WDC2442





## LAZY SUSAN (BASE CABINETS)

SKU	DESCRIPTION	CABINET
RVLD4BW40128SBS1	28" Banded Wood Susan w/Steel bearing & stop	BER36
RVLD4BW472241	24" Banded Wood Kidney Two Shelf Kit	LS3312
RVLD4BW472281	28" Banded Wood Kidney Two Shelf Kit	LS3612

## VANITY CABINETS

SKU	DESCRIPTION	CABINET
RV445VCG20SC8	8" Grooming Vanity Organizer	VB12
RV4WHRM15DM1	Soft Close Hamper Pull-Out	VB18
RVHPRV1520S	Pull-Out Hamper	VB18
RV4HD151	Vanity Appliance Storage Rack	V3021
RV44112VSBSC1	L Shaped Vanity Organizer	V2421, V2721
RV44115VSBSC1	L Shaped Vanity Organizer	V3021, V3621
RV4SOWC81	Single 8qt Door Mount Vanity Waste Container	V3021
RV5SBWC815S1	Sink Base Waste Container	V2421 to V3621





# LUXURY VINYL SPC FLOORING

Width: 7" x 48" | Thickness: 5mm | Wear Layer: 12mil | Sq Ft per Ctn: 28.4 | Cartons Per Pallet: 55

**INCREDIBLE  
12 MIL**



**StoneCast**  
RIGID WATERPROOF FLOOR

COLOR	SKU	3-IN-1 Threshold, T-Mold, End Cap	STAIR NOSE
Antique Oak	NF525212	TH525212	TN525212
Dawn's Early Light	NF525051	TH525051	TN525051
Light Oak	NF525204	TH525204	TN525204
Light Twine	NF525002	TH525002	TN525002
Silver Rustic Oak	NF525203	TH525203	TN525203
Toasted Barnboard	NF525211	TH525211	TN525211
Weathered Barnboard	NF525208	TH525208	TN525208
Wheatfield	NF525193	TH525193	TN525193

Antique Oak



Dawn's Early Light



Light Oak



Light Twine



Silver Rustic Oak

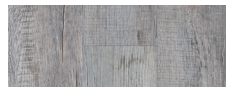

Toasted Barnboard



Weathered Barnboard

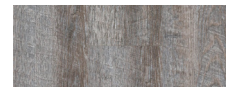

Wheatfield



**AMAZING  
12 MIL**



**StoneCast**  
RIGID WATERPROOF FLOOR

Width: 7" x 48" | Thickness: 5mm | Wear Layer: 12mil | Sq Ft per Ctn: 28.4 | Cartons Per Pallet: 55

COLOR	SKU	3-IN-1 Threshold, T-Mold, End Cap	STAIR NOSE
Arctic Oak	AMLVTAZ537047	TH537047	TN537047
Carbonized Oak	AMLVTAZ537078	TH537078	TN537078
Espresso Oak	AMLVTAZ537006	TH537006	TN537006
Heritage Oak	AMLVTAZ537053	TH537053	TN537053
Naturall Oiled Oak	AMLVTAZ537060	TH537060	TN537060
Nickel Finished Oak	AMLVTAZ537048	TH537048	TN537048
Smoked Oak	AMLVTAZ537054	TH537054	TN537054
Tavern Oak	AMLVTAZ537412	TH537412	TN537412

Arctic Oak

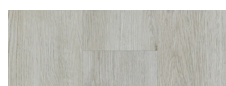

Carbonized Oak

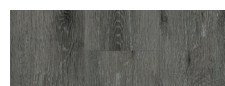

Espresso Oak



Heritage Oak



Naturally Oiled Oak



Nickel Finished Oak

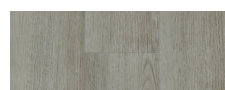

Smoked Oak

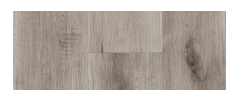

Tavern Oak

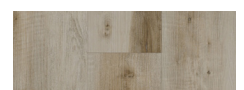





# LUXURY VINYL GLUE DOWN

Width: 7.25" x 48" | Thickness: 3mm | Wear Layer: 28mil | Sq Ft per Ctn: 33.8 | Cartons Per Pallet: 55

## INDESTRUCTIBLE 28 MIL



COLOR	SKU	Recommended Adhesive:  Titebond 780
Charcoal Oak	AMLVTID415007	
Ecru Oak	AMLVTID415004	
Pewter Oak	AMLVTID415056	
Silver Oak	AMLVTID415038	
Umber Oak	AMLVTID415008	
Weathered Oak	AMLVTID415003	

Charcoal Oak

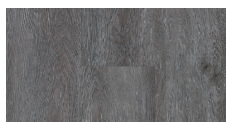

Ecru Oak

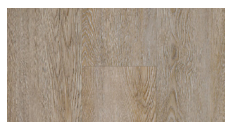

Pewter Oak



Silver Oak



Umber Oak

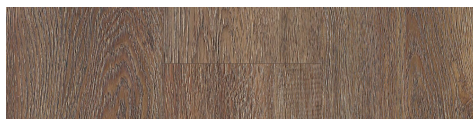

Weathered Oak

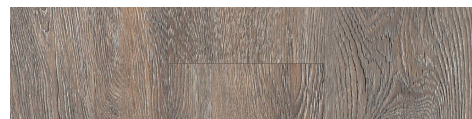

## COASTAL RESORT 20 MIL



Width: 7.25" x 48" | Thickness: 2.5mm | Wear Layer: 20mil | Sq Ft per Ctn: 41.1 | Cartons Per Pallet: 55

COLOR	SKU	Recommended Adhesive:  Titebond 780
Aged Driftwood	NF439005	
Dovetail Gray	NF439026	
Light Twine	NF439002	
Mineral White Maple	NF439051	
Salted Caramel	NF439043	
Shaded Walnut	NF439011e	

Aged Driftwood



Dovetail Gray



Light Twine



Mineral White Maple



Salted Caramel



Shaded Walnut





# ENGINEERED HARDWOODS

Width: 6.5" x 72" RL | Thickness: 3/8" | Species: Oak | Sq Ft per Ctn: 32.87 | Cartons Per Pallet: 54

## RIVIERA WHITE OAK



COLOR	SKU	STAIRNOSE	REDUCER	T-MOLD	BABY THRESHOLD
Menton	FH19500	FH19500SN	FH19500RD	FH19500TM	FH19500TH
Cannes	FH19501	FH19501SN	FH19501RD	FH19501TM	FH19501TH
Antibes	FH19502	FH19502SN	FH19502RD	FH19502TM	FH19502TH
Monaco	FH19503	FH19503SN	FH19503RD	FH19503TM	FH19503TH
Nice	FH19504	FH19504SN	FH19504RD	FH19504TM	FH19504TH

Menton

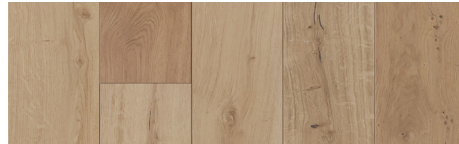

Cannes



Antibes



Monaco

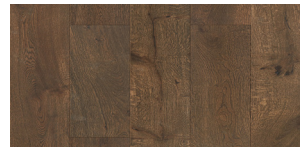

Nice

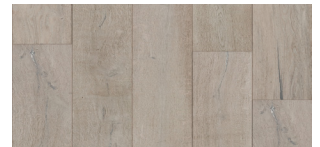

## TEMPEST HICKORY



Width: 6.5" x 72" RL | Thickness: 3/8" | Species: Hickory | Sq Ft per Ctn: 32.87 | Cartons Per Pallet: 54

COLOR	SKU	STAIRNOSE	REDUCER	T-MOLD	BABY THRESHOLD
Ranger	FH19801	FH19801SN	FH19801RD	FH19801TM	FH19801TH
Lexington	FH19802	FH19802SN	FH19802RD	FH19802TM	FH19802TH
Yorktown	FH19803	FH19803SN	FH19803RD	FH19803TM	FH19803TH
Independence	FH19804	FH19804SN	FH19804RD	FH19804TM	FH19804TH
Essex	FH19805	FH19805SN	FH19805RD	FH19805TM	FH19805TH
Saratoga	FH19807	FH19807SN	FH19807RD	FH19807TM	FH19807TH

Ranger

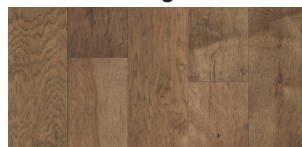

Lexington

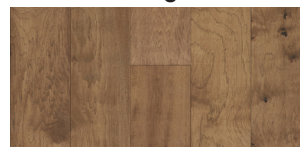

Yorktown

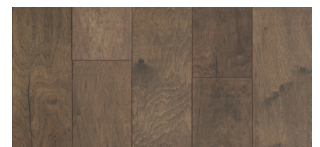

Independence

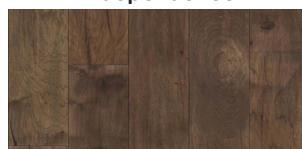

Essex

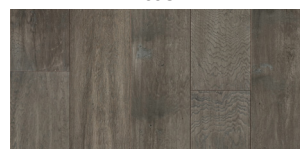

Saratoga





## Wall Cabinets

ITEM #	SIZE	ASP	WS	PS	WPG	WIN	HS	MBS	FS	CS
18" Height Wall Cabinets										
SDW1218	12 x 18	✗	✓	✓	✓	✓	✓	✓	✓	✓
SDW1518	15 x 18	✗	✓	✓	✓	✓	✓	✓	✓	✓
SDW1818	18 x 18	✗	✓	✓	✓	✓	✓	✓	✓	✓
30" Height Wall Cabinets										
W0930	9 x 30	✓	✓	✓	✓	✓	✓	✓	✓	✓
W1230	12 x 30	✓	✓	✓	✓	✓	✓	✓	✓	✓
W1530	15 x 30	✓	✓	✓	✓	✓	✓	✓	✓	✓
W1830	18 x 30	✓	✓	✓	✓	✓	✓	✓	✓	✓
W2130	21 x 30	✓	✓	✓	✓	✓	✓	✓	✓	✓
W2430	24 x 30	✓	✓	✓	✓	✓	✓	✓	✓	✓
W2730	27 x 30	✓	✓	✓	✓	✓	✓	✓	✓	✓
W3030	30 x 30	✓	✓	✓	✓	✓	✓	✓	✓	✓
W3330	33 x 30	✓	✓	✓	✓	✓	✓	✓	✓	✓
W3630	36 x 30	✓	✓	✓	✓	✓	✓	✓	✓	✓
W3930	39 x 30	✓	✓	✓	✓	✓	✓	✓	✓	✓
W4230	42 x 30	✓	✓	✓	✓	✓	✓	✓	✓	✓
36" Height Wall Cabinets										
W0936	9 x 36	✓	✓	✓	✓	✓	✓	✓	✓	✓
W1236	12 x 36	✓	✓	✓	✓	✓	✓	✓	✓	✓
W1536	15 x 36	✓	✓	✓	✓	✓	✓	✓	✓	✓
W1836	18 x 36	✓	✓	✓	✓	✓	✓	✓	✓	✓
W2136	21 x 36	✓	✓	✓	✓	✓	✓	✓	✓	✓
W2436	24 x 36	✓	✓	✓	✓	✓	✓	✓	✓	✓
W2736	27 x 36	✓	✓	✓	✓	✓	✓	✓	✓	✓
W3036	30 x 36	✓	✓	✓	✓	✓	✓	✓	✓	✓
W3336	33 x 36	✓	✓	✓	✓	✓	✓	✓	✓	✓
W3636	36 x 36	✓	✓	✓	✓	✓	✓	✓	✓	✓
W3936	39 x 36	✓	✓	✓	✓	✓	✓	✓	✓	✓
W4236	42 x 36	✓	✓	✓	✓	✓	✓	✓	✓	✓
42" Height Wall Cabinets										
W0942	9 x 42	✓	✓	✓	✓	✓	✓	✓	✓	✓
W1242	12 x 42	✓	✓	✓	✓	✓	✓	✓	✓	✓
W1542	15 x 42	✓	✓	✓	✓	✓	✓	✓	✓	✓
W1842	18 x 42	✓	✓	✓	✓	✓	✓	✓	✓	✓
W2142	21 x 42	✓	✓	✓	✓	✓	✓	✓	✓	✓
W2442	24 x 42	✓	✓	✓	✓	✓	✓	✓	✓	✓

**Wall Cabinets** (Continued ...)

ITEM #	SIZE	ASP	WS	PS	WPG	WIN	HS	MBS	FS	CS
<b>42" Height Wall Cabinets</b>										
W2442	24 x 42	✓	✓	✓	✓	✓	✓	✓	✓	✓
W2742	27 x 42	✓	✓	✓	✓	✓	✓	✓	✓	✓
W3042	30 x 42	✓	✓	✓	✓	✓	✓	✓	✓	✓
W3342	33 x 42	✓	✓	✓	✓	✓	✓	✓	✓	✓
W3642	36 x 42	✓	✓	✓	✓	✓	✓	✓	✓	✓
W3942	39 x 42	✓	✓	✓	✓	✓	✓	✓	✓	✓
W4242	42 x 42	✓	✓	✓	✓	✓	✓	✓	✓	✓
<b>Angled End Wall Cabinets</b>										
WCA1230	12 x 30	✓	✓	✓	✓	✓	✓	✓	✓	✓
WCA1236	12 x 36	✓	✓	✓	✓	✓	✓	✓	✓	✓
WCA1242	12 x 42	✓	✓	✓	✓	✓	✓	✓	✓	✓
<b>Blind Corner Wall Cabinets</b>										
WBC2730	27 x 30	✓	✓	✓	✓	✓	✓	✓	✓	✓
WBC2736	27 x 36	✓	✓	✓	✓	✓	✓	✓	✓	✓
WBC2742	27 x 42	✓	✓	✓	✓	✓	✓	✓	✓	✓
<b>Decorative Stacker Wall Cabinets with Single Glass Door</b>										
W1212PG	12 x 12	✓	✓	✓	✓	✓	✓	✓	✓	✓
W1512PG	15 x 12	✓	✓	✓	✓	✓	✓	✓	✓	✓
W1812PG	18 x 12	✓	✓	✓	✓	✓	✓	✓	✓	✓
W2112PG	21 x 12	✓	✓	✓	✓	✓	✓	✓	✓	✓
<b>Decorative Stacker Wall Cabinets with Double Glass Doors</b>										
W2412PG	24 x 12	✓	✓	✓	✓	✓	✓	✓	✓	✓
W2712PG	27 x 12	✓	✓	✓	✓	✓	✓	✓	✓	✓
W3012PG	30 x 12	✓	✓	✓	✓	✓	✓	✓	✓	✓
W3312PG	33 x 12	✓	✓	✓	✓	✓	✓	✓	✓	✓
W3612PG	36 x 12	✓	✓	✓	✓	✓	✓	✓	✓	✓
<b>Bridge Wall Cabinets</b>										
W3012	30 x 12	✓	✓	✓	✓	✓	✓	✓	✓	✓
W3312	33 x 12	✓	✓	✓	✓	✓	✓	✓	✓	✓
W3612	36 x 12	✓	✓	✓	✓	✓	✓	✓	✓	✓
W3015	30 x 15	✓	✓	✓	✓	✓	✓	✓	✓	✓
W3315	33 x 15	✓	✓	✓	✓	✓	✓	✓	✓	✓
W3615	36 x 15	✓	✓	✓	✓	✓	✓	✓	✓	✓
W3018	30 x 18	✓	✓	✓	✓	✓	✓	✓	✓	✓
W3318	33 x 18	✓	✓	✓	✓	✓	✓	✓	✓	✓
W3618	36 x 18	✓	✓	✓	✓	✓	✓	✓	✓	✓

**Wall Cabinets** (Continued ...)

ITEM #	SIZE	ASP	WS	PS	WPG	WIN	HS	MBS	FS	CS
<b>Bridge Wall Cabinets</b>										
W3618	36 x 18	✓	✓	✓	✓	✓	✓	✓	✓	✓
W3021	30 x 21	✓	✓	✓	✓	✓	✓	✓	✓	✓
W3321	33 x 21	✓	✓	✓	✓	✓	✓	✓	✓	✓
W3621	36 x 21	✓	✓	✓	✓	✓	✓	✓	✓	✓
W3024	30 x 24	✓	✓	✓	✓	✓	✓	✓	✓	✓
W3324	33 x 24	✓	✓	✓	✓	✓	✓	✓	✓	✓
W3624	36 x 24	✓	✓	✓	✓	✓	✓	✓	✓	✓
<b>Diagonal Corner Wall Cabinets</b>										
WDC2430	24 x 30	✓	✓	✓	✓	✓	✓	✓	✓	✓
WDC2436	24 x 36	✓	✓	✓	✓	✓	✓	✓	✓	✓
WDC2442	24 x 42	✓	✓	✓	✓	✓	✓	✓	✓	✓
<b>Diagonal Corner Wall Cabinets with Glass Door</b>										
WDC42PG	24 x 42	✓	✓	✓	✓	✓	✓	✓	✓	✓
<b>Easy Reach Wall Cabinets</b>										
WER2430	24 x 30	✗	✓	✓	✓	✓	✓	✓	✓	✓
WER2436	24 x 36	✗	✓	✓	✓	✓	✓	✓	✓	✓
WER2442	24 x 42	✗	✓	✓	✓	✓	✓	✓	✓	✓
<b>Microwave Wall Cabinets</b>										
MW3030	30 x 30	✓	✓	✓	✓	✓	✓	✓	✓	✓
MW3036	30 x 36	✓	✓	✓	✓	✓	✓	✓	✓	✓
MW3042	30 x 42	✓	✓	✓	✓	✓	✓	✓	✓	✓
<b>Refrigerator Wall Cabinets</b>										
WR3315	33 x 15	✓	✓	✓	✓	✓	✓	✓	✓	✓
WR3324	33 x 24	✓	✓	✓	✓	✓	✓	✓	✓	✓
WR3612	36 x 12	✓	✓	✓	✓	✓	✓	✓	✓	✓
WR3615	36 x 15	✓	✓	✓	✓	✓	✓	✓	✓	✓
WR3618	36 x 18	✓	✓	✓	✓	✓	✓	✓	✓	✓
WR3621	36 x 21	✓	✓	✓	✓	✓	✓	✓	✓	✓
WR3624	36 x 24	✓	✓	✓	✓	✓	✓	✓	✓	✓
<b>Spice Drawers Wall Cabinets</b>										
WSC30	6 x 30	✓	✓	✓	✓	✓	✓	✓	✓	✓

**Base Cabinets**

ITEM #	SIZE	ASP	WS	PS	WPG	WIN	HS	MBS	FS	CS
<b>Single Door &amp; Drawer Base Cabinets</b>										
B12	12 x 34.5	✓	✓	✓	✓	✓	✓	✓	✓	✓
B15	15 x 34.5	✓	✓	✓	✓	✓	✓	✓	✓	✓
B18	18 x 34.5	✓	✓	✓	✓	✓	✓	✓	✓	✓
B21	21 x 34.5	✓	✓	✓	✓	✓	✓	✓	✓	✓



## Base Cabinets

ITEM #	SIZE	ASP	WS	PS	WPG	WIN	HS	MBS	FS	CS
Double Doors & Single Drawer Base Cabinets										
B24	24 x 34.5	✓	✓	✓	✓	✓	✓	✓	✓	✓
B27	27 x 34.5	✓	✓	✓	✓	✓	✓	✓	✓	✓
Double Doors & Drawers Base Cabinets										
B30	30 x 34.5	✓	✓	✓	✓	✓	✓	✓	✓	✓
B33	33 x 34.5	✓	✓	✓	✓	✓	✓	✓	✓	✓
B36	36 x 34.5	✓	✓	✓	✓	✓	✓	✓	✓	✓
B39	39 x 34.5	✓	✓	✓	✓	✓	✓	✓	✓	✓
B42	42 x 34.5	✓	✓	✓	✓	✓	✓	✓	✓	✓
B48	48 x 34.5	✓	✓	✓	✓	✓	✓	✓	✓	✓
Two Drawers Base Cabinets										
2DB24	24 x 34.5	✗	✓	✓	✓	✓	✓	✓	✓	✓
2DB27	27 x 34.5	✗	✓	✓	✓	✓	✓	✓	✓	✓
2DB30	30 x 34.5	✗	✓	✓	✓	✓	✓	✓	✓	✓
2DB33	33 x 34.5	✗	✓	✓	✓	✓	✓	✓	✓	✓
2DB36	36 x 34.5	✗	✓	✓	✓	✓	✓	✓	✓	✓
Three Drawers Base Cabinets										
DB12	12 x 34.5	✓	✓	✓	✓	✓	✓	✓	✓	✓
DB15	15 x 34.5	✓	✓	✓	✓	✓	✓	✓	✓	✓
DB18	18 x 34.5	✓	✓	✓	✓	✓	✓	✓	✓	✓
DB21	21 x 34.5	✓	✓	✓	✓	✓	✓	✓	✓	✓
DB24	24 x 34.5	✓	✓	✓	✓	✓	✓	✓	✓	✓
DB30	30 x 34.5	✓	✓	✓	✓	✓	✓	✓	✓	✓
DB36	36 x 34.5	✓	✓	✓	✓	✓	✓	✓	✓	✓
Corner Three Drawers Base Cabinets										
CDB36	36 x 34.5	✓	✓	✓	✓	✓	✓	✓	✓	✓
Easy Reach Base Cabinets										
BER33	33 x 34.5	✗	✓	✓	✓	✓	✓	✓	✓	✓
BER36	36 x 34.5	✗	✓	✓	✓	✓	✓	✓	✓	✓
Lazy Susan Base Cabinets										
LS3312	33 x 34.5	✓	✓	✓	✓	✓	✓	✓	✓	✓
LS3612	36 x 34.5	✓	✓	✓	✓	✓	✓	✓	✓	✓
Microwave Base Cabinets										
BMC27	27 x 34.5	✓	✓	✓	✓	✓	✓	✓	✓	✓
BMC30	30 x 34.5	✓	✓	✓	✓	✓	✓	✓	✓	✓
Farm Sink Base Cabinets										
FSB36	27 x 34.5	✓	✓	✓	✓	✓	✓	✓	✓	✓
Sink Base Cabinets										
SB33	33 x 34.5	✓	✓	✓	✓	✓	✓	✓	✓	✓
SB36	36 x 34.5	✓	✓	✓	✓	✓	✓	✓	✓	✓

**Base Cabinets** (Continued ...)

ITEM #	SIZE	ASP	WS	PS	WPG	WIN	HS	MBS	FS	CS
<b>Corner Sink Base Cabinets</b>										
DCSB36	36 x 34.5	✓	✓	✓	✓	✓	✓	✓	✓	✓
<b>Tray Base Cabinets</b>										
TB09	9 x 34.5	✓	✓	✓	✓	✓	✓	✓	✓	✓
<b>Blind Corner Base Cabinets</b>										
BBC36	36 x 34.5	✓	✓	✓	✓	✓	✓	✓	✓	✓
<b>Angled End Base Cabinets</b>										
BA24	12 x 34.5	✓	✓	✓	✓	✓	✓	✓	✓	✓
<b>Five Drawer Spice Base Cabinets</b>										
BSD6	6 x 34.5	✓	✓	✓	✓	✓	✓	✓	✓	✓
<b>Spice Pull Out Base Cabinets</b>										
BSR6	6 x 34.5	✗	✓	✓	✓	✓	✓	✓	✓	✓
BSR9	9 x 34.5	✗	✓	✓	✓	✓	✓	✓	✓	✓

**Tall Cabinets**

ITEM #	SIZE	ASP	WS	PS	WPG	WIN	HS	MBS	FS	CS
<b>18" Height Split Pantry Wall Cabinets</b>										
SDW183024	18 x 30	✗	✓	✓	✓	✓	✓	✓	✓	✓
SDW183624	18 x 36	✗	✓	✓	✓	✓	✓	✓	✓	✓
SDW184224	18 x 42	✗	✓	✓	✓	✓	✓	✓	✓	✓
<b>18" Height Split Pantry Base Cabinets</b>										
UCB1854	18 x 54	✗	✓	✓	✓	✓	✓	✓	✓	✓
<b>24" Height Split Pantry Wall Cabinets</b>										
DDW243024	24 x 30	✗	✓	✓	✓	✓	✓	✓	✓	✓
DDW243624	24 x 36	✗	✓	✓	✓	✓	✓	✓	✓	✓
DDW244224	24 x 42	✗	✓	✓	✓	✓	✓	✓	✓	✓
<b>24" Height Split Pantry Base Cabinets</b>										
UCB2454	24 x 54	✗	✓	✓	✓	✓	✓	✓	✓	✓
<b>30" Height Split Pantry Wall Cabinets</b>										
DDW303024	30 x 30	✗	✓	✓	✓	✓	✓	✓	✓	✓
DDW303624	30 x 36	✗	✓	✓	✓	✓	✓	✓	✓	✓
DDW304224	30 x 42	✗	✓	✓	✓	✓	✓	✓	✓	✓
<b>30" Height Split Pantry Base Cabinets</b>										
UCB3054	30 x 54	✗	✓	✓	✓	✓	✓	✓	✓	✓
<b>36" Height Split Pantry Wall Cabinets</b>										
DDW363024	36 x 30	✗	✓	✓	✓	✓	✓	✓	✓	✓
DDW363624	36 x 36	✗	✓	✓	✓	✓	✓	✓	✓	✓
DDW364224	36 x 42	✗	✓	✓	✓	✓	✓	✓	✓	✓
<b>36" Height Split Pantry Base Cabinets</b>										
UCB3654	36 x 54	✗	✓	✓	✓	✓	✓	✓	✓	✓

**Tall Cabinets** (Continued ...)

ITEM #	SIZE	ASP	WS	PS	WPG	WIN	HS	MBS	FS	CS
<b>18" Wide Pantry / Utility Tall Cabinets</b>										
UC1884	18 x 84	✓	✓	✓	✓	✓	✓	✓	✓	✓
UC1890	18 x 90	✓	✓	✓	✓	✓	✓	✓	✓	✓
UC1896	18 x 96	✓	✓	✓	✓	✓	✓	✓	✓	✓
<b>24" Wide Pantry / Utility Tall Cabinets</b>										
UC2484	24 x 84	✓	✓	✓	✓	✓	✓	✓	✓	✓
UC2490	24 x 90	✓	✓	✓	✓	✓	✓	✓	✓	✓
UC2496	24 x 96	✓	✓	✓	✓	✓	✓	✓	✓	✓
<b>Universal Oven Tall Cabinets</b>										
UOC3384	33 x 84	✓	✓	✓	✓	✓	✓	✓	✓	✓
UOC3390	33 x 90	✓	✓	✓	✓	✓	✓	✓	✓	✓
UOC3396	33 x 96	✓	✓	✓	✓	✓	✓	✓	✓	✓

**Vanity Cabinets**

ITEM #	SIZE	ASP	WS	PS	WPG	WIN	HS	MBS	FS	CS
<b>Single Door &amp; Drawer Vanity Cabinets</b>										
VB12	12 x 34.5	✗	✓	✓	✓	✓	✓	✓	✓	✓
VB15	15 x 34.5	✗	✓	✓	✓	✓	✓	✓	✓	✓
VB18	18 x 34.5	✗	✓	✓	✓	✓	✓	✓	✓	✓
<b>Three Drawers Vanity Cabinets</b>										
VDB1221	12 x 34.5	✓	✓	✓	✓	✓	✓	✓	✓	✓
VDB1521	15 x 34.5	✓	✓	✓	✓	✓	✓	✓	✓	✓
VDB1821	18 x 34.5	✓	✓	✓	✓	✓	✓	✓	✓	✓
VDB2121	21 x 34.5	✓	✓	✓	✓	✓	✓	✓	✓	✓
VDB2421	24 x 34.5	✓	✓	✓	✓	✓	✓	✓	✓	✓
<b>Sink Base Vanity Cabinets (no drawers)</b>										
V2121	21 x 34.5	✓	✓	✓	✓	✓	✓	✓	✓	✓
V2421	24 x 34.5	✓	✓	✓	✓	✓	✓	✓	✓	✓
V2721	27 x 34.5	✓	✓	✓	✓	✓	✓	✓	✓	✓
V3021	30 x 34.5	✓	✓	✓	✓	✓	✓	✓	✓	✓
V3621	36 x 34.5	✓	✓	✓	✓	✓	✓	✓	✓	✓
<b>Sink Base Vanity Cabinets with Drawers (Left or Right)</b>										
V2421DL	24 x 34.5	✓	✓	✓	✓	✓	✓	✓	✓	✓
V2421DR	24 x 34.5	✓	✓	✓	✓	✓	✓	✓	✓	✓
V3021DL	30 x 34.5	✓	✓	✓	✓	✓	✓	✓	✓	✓
V3021DR	30 x 34.5	✓	✓	✓	✓	✓	✓	✓	✓	✓
V3621DL	36 x 34.5	✓	✓	✓	✓	✓	✓	✓	✓	✓
V3621DR	36 x 34.5	✓	✓	✓	✓	✓	✓	✓	✓	✓
V4221DL	42 x 34.5	✗	✓	✓	✓	✓	✓	✓	✓	✓
V4221DR	42 x 34.5	✗	✓	✓	✓	✓	✓	✓	✓	✓

## Vanity Cabinets *(Continued ...)*

ITEM #	SIZE	ASP	WS	PS	WPG	WIN	HS	MBS	FS	CS
Sink Base Vanity Cabinets with Double Drawers										
V4821DD	48 x 34.5	✓	✓	✓	✓	✓	✓	✓	✓	✓
V6021DD	60 x 34.5	✓	✓	✓	✓	✓	✓	✓	✓	✓
Double Sink Base Cabinets										
VSDB60	60 x 34.5	✓	✓	✓	✓	✓	✓	✓	✓	✓

## Accessories

ITEM #	SIZE	ASP	WS	PS	WPG	WIN	HS	MBS	FS	CS
Appliance Garage Cabinets										
AG2418	24 x 18	✓	✓	✓	✓	✓	✓	✓	✓	✓
Finished Floating Shelves										
FFS24	24 x 2.5	✗	✓	✓	✓	✓	✓	✓	✓	✓
FFS30	30 x 2.5	✗	✓	✓	✓	✓	✓	✓	✓	✓
FFS36	36 x 2.5	✗	✓	✓	✓	✓	✓	✓	✓	✓
FFS42	42 x 2.5	✗	✓	✓	✓	✓	✓	✓	✓	✓
Plate Rack Cabinets										
PR3015	30 x 15	✓	✓	✓	✓	✓	✓	✓	✓	✓
Range Hood Fronts										
RHF30	30 x 23.5	✓	✓	✓	✓	✓	✓	✓	✓	✓
RHF36	36 x 23.5	✓	✓	✓	✓	✓	✓	✓	✓	✓
Toilet Topper Cabinets										
TT2436	24 x 36	✗	✓	✓	✓	✓	✓	✓	✓	✓
Under Counter Drawers										
UCD30	30 x 7	✓	✓	✓	✓	✓	✓	✓	✓	✓
UCD36	36 x 7	✓	✓	✓	✓	✓	✓	✓	✓	✓
Universal Roll Out Trays										
ROT15	15 x 3.5	✓	✓	✓	✓	✓	✓	✓	✓	✓
ROT18	18 x 3.5	✓	✓	✓	✓	✓	✓	✓	✓	✓
ROT21	21 x 3.5	✓	✓	✓	✓	✓	✓	✓	✓	✓
ROT24	24 x 3.5	✓	✓	✓	✓	✓	✓	✓	✓	✓
ROT27	27 x 3.5	✓	✓	✓	✓	✓	✓	✓	✓	✓
ROT30	30 x 3.5	✓	✓	✓	✓	✓	✓	✓	✓	✓
ROT33	33 x 3.5	✓	✓	✓	✓	✓	✓	✓	✓	✓
ROT36	36 x 3.5	✓	✓	✓	✓	✓	✓	✓	✓	✓

**Accessories** (Continued ...)

ITEM #	SIZE	ASP	WS	PS	WPG	WIN	HS	MBS	FS	CS
<b>Glass Panel Doors for Single Door Wall Cabinets</b>										
PG1530	15 x 30	✗	✓	✓	✗	✓	✓	✓	✓	✓
PG1536	15 x 36	✗	✓	✓	✗	✓	✓	✓	✓	✓
PG1542	15 x 42	✗	✓	✓	✗	✓	✓	✓	✓	✓
PG1830	18 x 30	✗	✓	✓	✗	✓	✓	✓	✓	✓
PG1836	18 x 36	✗	✓	✓	✗	✓	✓	✓	✓	✓
PG1842	18 x 42	✗	✓	✓	✗	✓	✓	✓	✓	✓
PG2130	21 x 30	✗	✓	✓	✗	✓	✓	✓	✓	✓
PG2136	21 x 36	✗	✓	✓	✗	✓	✓	✓	✓	✓
PG2142	21 x 42	✗	✓	✓	✗	✓	✓	✓	✓	✓
<b>Glass Panel Doors For Double Doors Wall Cabinets</b>										
PG2430	24 x 30	✗	✓	✓	✗	✓	✓	✓	✓	✓
PG2436	24 x 36	✗	✓	✓	✗	✓	✓	✓	✓	✓
PG2442	24 x 42	✗	✓	✓	✗	✓	✓	✓	✓	✓
PG3030	30 x 30	✗	✓	✓	✗	✓	✓	✓	✓	✓
PG3036	30 x 36	✗	✓	✓	✗	✓	✓	✓	✓	✓
PG3042	30 x 42	✗	✓	✓	✗	✓	✓	✓	✓	✓
PG3630	36 x 30	✗	✓	✓	✗	✓	✓	✓	✓	✓
PG3636	36 x 36	✗	✓	✓	✗	✓	✓	✓	✓	✓
PG3642	36 x 42	✗	✓	✓	✗	✓	✓	✓	✓	✓
<b>Glass Panel Doors for Diagonal Corner Wall Cabinets</b>										
PGWDC30	24 x 30	✓	✓	✓	✓	✓	✓	✓	✓	✓
PGWDC36	24 x 36	✓	✓	✓	✓	✓	✓	✓	✓	✓
PGWDC42	24 x 42	✓	✓	✓	✓	✓	✓	✓	✓	✓
<b>Three Drawers Wall Cabinets</b>										
W3DR18	18 x 18	✗	✓	✓	✓	✓	✓	✓	✓	✓
W3DR24	24 x 18	✗	✓	✓	✓	✓	✓	✓	✓	✓
<b>Stem Glass Holders</b>										
SGH	30 x 2	✓	✓	✓	✓	✓	✓	✓	✓	✓
<b>Lattice Wine Rack Cabinets</b>										
LWR3015	15 x 30	✓	✓	✓	✓	✓	✓	✓	✓	✓
<b>Wine Storage Cubes</b>										
WINEESC1515	15 x 15	✗	✓	✓	✓	✓	✓	✓	✓	✓
WINEESC1818	18 x 18	✗	✓	✓	✓	✓	✓	✓	✓	✓



## Panels

ITEM #	SIZE	ASP	WS	PS	WPG	WIN	HS	MBS	FS	CS
Decorative End Panels for Wall Cabinets										
DP1230	12 x 30	✓	✓	✓	✓	✓	✓	✓	✓	✓
DP1236	12 x 36	✓	✓	✓	✓	✓	✓	✓	✓	✓
DP1242	12 x 42	✓	✓	✓	✓	✓	✓	✓	✓	✓
Decorative End Panels for Base Cabinets										
DP2430	24 x 30	✓	✓	✓	✓	✓	✓	✓	✓	✓
Decorative End Panels for Tall Cabinets										
MTEP84	23.5 x 79	✗	✓	✓	✓	✓	✓	✓	✓	✓
MTEP90	23.5 x 85	✗	✓	✓	✓	✓	✓	✓	✓	✓
MTEP96	23.5 x 91	✗	✓	✓	✓	✓	✓	✓	✓	✓
Decorative End Panels for Vanity Cabinets										
MVEPBH	20 x 29	✗	✓	✓	✓	✓	✓	✓	✓	✓
Cabinet End Panels										
WEP1542	36 x 34.5	✓	✓	✓	✓	✓	✓	✓	✓	✓
BEP3	36 x 34.5	✓	✓	✓	✓	✓	✓	✓	✓	✓
REP9624	36 x 34.5	✓	✓	✓	✓	✓	✓	✓	✓	✓
Cabinet Skins										
WS1542	36 x 34.5	✓	✓	✓	✓	✓	✓	✓	✓	✓
TS2496	42 x 34.5	✗	✗	✗	✗	✓	✓	✗	✗	✗
BS2435	42 x 34.5	✗	✗	✗	✗	✓	✓	✗	✗	✗
Island Panels										
IS3696	36" x 96"	✓	✓	✓	✓	✓	✓	✓	✓	✓
Stained Plywood Panels										
SPW	36" x 96"	✓	✓	✓	✓	✓	✓	✓	✓	✓
Edgebanded Plywood Panels										
PLYEB42	42" x 96"	✗	✓	✓	✓	✓	✓	✓	✓	✓
Bead Board Panels										
BBFBP4896	48" x 96"	✗	✓	✓	✓	✓	✓	✓	✓	✓

## Fillers

ITEM #	SIZE	ASP	WS	PS	WPG	WIN	HS	MBS	FS	CS
Wall Fillers										
WF342	3" x 42"	✓	✓	✓	✓	✓	✓	✓	✓	✓
WF642	6" x 42"	✓	✓	✓	✓	✓	✓	✓	✓	✓
Fluted Wall Fillers										
WFF342	3" x 42"	✓	✓	✓	✓	✓	✓	✓	✓	✓
WFF642	6" x 42"	✓	✓	✓	✓	✓	✓	✓	✓	✓
Base Fillers										
BF3	3" x 34.5"	✓	✓	✓	✓	✓	✓	✓	✓	✓
BF6	6" x 34.5"	✓	✓	✓	✓	✓	✓	✓	✓	✓

**Fillers** (Continued ...)

ITEM #	SIZE	ASP	WS	PS	WPG	WIN	HS	MBS	FS	CS
<b>Fluted Base Fillers</b>										
<b>BFF3</b>	3" x 34.5"	✓	✓	✓	✓	✓	✓	✓	✓	✓
<b>BFF6</b>	6" x 34.5"	✓	✓	✓	✓	✓	✓	✓	✓	✓
<b>Tall Fillers</b>										
<b>WF396</b>	3" x 96"	✓	✓	✓	✓	✓	✓	✓	✓	✓
<b>TF396</b>	3" x 96"	✓	✓	✓	✓	✓	✓	✓	✓	✓
<b>Fluted Tall Fillers</b>										
<b>WFF396</b>	3" x 96"	✓	✓	✓	✓	✓	✓	✓	✓	✓
<b>TFF396</b>	3" x 96"	✓	✓	✓	✓	✓	✓	✓	✓	✓

**Moldings & Trim**

ITEM #	SIZE	ASP	WS	PS	WPG	WIN	HS	MBS	FS	CS
<b>Corbels</b>										
<b>CBLPN2</b>	small	✓	✓	✓	✓	✓	✓	✗	✓	✓
<b>CBLPN3</b>	large	✓	✓	✓	✓	✓	✓	✓	✓	✓
<b>Toe Kicks</b>										
<b>TK8</b>	96" L	✓	✓	✓	✓	✓	✓	✓	✓	✓
<b>Crown Moldings</b>										
<b>LCM8</b>	96" L	✓	✓	✓	✓	✓	✓	✓	✓	✓
<b>LVC</b>	96" L	✗	✓	✓	✗	✓	✓	✓	✓	✓
<b>Batten Moldings</b>										
<b>BM8</b>	96" L	✓	✓	✓	✓	✓	✓	✓	✓	✓
<b>Light Rail Moldings</b>										
<b>LRM8</b>	96" L	✓	✓	✓	✓	✓	✓	✓	✓	✓
<b>Scribe Moldings</b>										
<b>SM8</b>	96" L	✓	✓	✓	✓	✓	✓	✓	✓	✓
<b>Shoe Moldings</b>										
<b>SHM8</b>	96" L	✓	✓	✓	✓	✓	✓	✓	✓	✓
<b>Outside Corner Moldings</b>										
<b>OCS8</b>	96" L	✓	✓	✓	✓	✓	✓	✓	✓	✓
<b>Rope Insert Moldings</b>										
<b>ROPE8</b>	96" L	✓	✓	✓	✓	✓	✓	✓	✓	✓
<b>Arched Valances</b>										
<b>VA48</b>	48" L	✓	✓	✓	✓	✓	✓	✓	✓	✓
<b>Decorative Base Moldings</b>										
<b>DEC004</b>	96" L	✓	✓	✓	✓	✓	✓	✓	✓	✓
<b>Decorative Split Leg Moldings</b>										
<b>SCDL</b>	3"W x 42"H	✓	✓	✓	✓	✓	✓	✓	✓	✓

2DB24.....	26	BSD6.....	32	FFS42.....	41
2DB27.....	26	BSR9.....	32	FSB36.....	27
2DB30.....	26	BSR12.....	32	IS3696.....	45
2DB33.....	26	CBLPN2.....	47	LCM8.....	47
2DB36.....	26	CBLPN3.....	47	LRM8.....	47
AG2418.....	41	CDB36.....	31	LS3312.....	30
B12.....	25	DB12.....	26	LS3612.....	30
B15.....	25	DB15.....	26	LVC.....	47
B18.....	25	DB18.....	26	LWR3015.....	43
B21.....	25	DB21.....	26	MTEP84.....	44
B24.....	25	DB24.....	26	MTEP90.....	44
B27.....	25	DB30.....	26	MTEP96.....	44
B30.....	25	DB36.....	26	MVEPBH.....	44
B33.....	25	DCSB36.....	28	MW3030.....	20
B36.....	25	DD.....	48	MW3036.....	20
B39.....	25	DDW243024.....	21, 36	MW3042.....	20
B42.....	25	DDW243624.....	21, 36	OCS8.....	48
B48.....	25	DDW244224.....	21, 36	PG1530.....	42
BA24.....	30	DDW303024.....	21, 36	PG1536.....	42
BBC36.....	29	DDW303624.....	21, 36	PG1542.....	42
BBFBP4896.....	45	DDW304224.....	21, 36	PG1830.....	42
BEP3.....	44	DDW363024.....	21, 36	PG1836.....	42
BER33.....	28	DDW363624.....	21, 36	PG1842.....	42
BER36.....	28	DDW364224.....	21, 36	PG2130.....	42
BF3.....	46	DEC004.....	48	PG2136.....	42
BF6.....	46	DP1230.....	44	PG2142.....	42
BFF3.....	46	DP1236.....	44	PG2430.....	43
BFF6.....	46	DP1242.....	44	PG2436.....	43
BM8.....	47	DP2430.....	44	PG2442.....	43
BMC27.....	29	FFS24.....	41	PG3030.....	43
BMC30.....	29	FFS30.....	41	PG3036.....	43
BS2435.....	44	FFS36.....	41	PG3042.....	43

PG3630.....	43	SPW .....	45	VA48 .....	48
PG3036.....	43	TB09 .....	31	VB12 .....	37
PG3042.....	43	TF396.....	46	VB15 .....	37
PGWDC30 .....	42	TFF396.....	46	VB18.....	37
PGWDC36 .....	42	TT2436.....	46	VDB1221.....	37
PGWDC42 .....	42	TUK .....	48	VDB1521.....	37
PLYEB42 .....	45	UC1884.....	33	VDB1821 .....	37
PR3015.....	41	UC1890.....	33	VDB2121 .....	37
REP9624.....	44	UC1896.....	33	VDB2421.....	37
RHF30.....	41	UC2484 .....	34	VSDB60.....	40
RHF36.....	41	UC2490 .....	34	W0930 .....	15
ROPE8 .....	48	UC2496.....	34	W0936.....	16
ROT15 .....	42	UCB1854.....	36	W0942.....	17
ROT18 .....	42	UCB2454 .....	36	W1512PG .....	23
ROT21 .....	42	UCB3054 .....	36	W1230.....	15
ROT24.....	42	UCB3654 .....	36	W1236.....	16
ROT27 .....	42	UCD30 .....	41	W1242.....	17
ROT30.....	42	UCD36 .....	41	W1512PG .....	23
ROT33.....	42	UOC3384.....	35	W1530.....	15
ROT36.....	42	UOC3390.....	35	W1536.....	16
SB33.....	27	UOC3396.....	35	W1542.....	17
SB36.....	27	V2121.....	38	W1812PG .....	23
SCDL .....	48	V2421 .....	38	W1830 .....	15
SDW1218 .....	21, 36	V2421D (L/R) .....	39	W1836 .....	16
SDW1518 .....	21, 36	V2721 .....	38	W1842.....	17
SDW1818 .....	21, 36	V3021.....	38	W2112PG .....	23
SDW183024 .....	21, 36	V3021D (L/R) .....	39	W2130.....	15
SDW183624 .....	21, 36	V3621 .....	38	W2136.....	16
SDW184224 .....	21, 36	V3621D (L/R) .....	39	W2142.....	17
SGH.....	43	V4221D (L/R) .....	39	W2412PG.....	23
SHM8 .....	47	V4821DD .....	40	W2430 .....	15
SM8 .....	47	V6021DD .....	40	W2436 .....	16

W2442.....17	W3930.....15	WR3612.....24
W2712PG.....23	W3936.....16	WR3615.....24
W2730.....15	W3942.....17	WR3618.....24
W2736.....16	W3DR18.....22, 43	WR3621.....24
W2742.....17	W3DR24.....22, 43	WR3624.....24
W3012.....22	W4230.....15	WS1542.....44
W3012PG.....23	W4236.....16	WSC30.....20
W3015.....22	W4242.....17	
W3018.....22	WBC2730.....18	
W3021.....22	WBC2736.....18	
W3024.....22	WBC2742.....18	
W3030.....15	WCA1230.....18	
W3036.....16	WCA1236.....18	
W3042.....17	WCA1242.....18	
W3312.....22	WDC2430.....19	
W3312PG.....23	WDC2436.....19	
W3315.....22	WDC2442.....19	
W3318.....22	WDC42PG.....19	
W3321.....22	WEP1542.....44	
W3324.....22	WER2430.....24	
W3330.....15	WER2436.....24	
W3336.....16	WER2442.....24	
W3342.....17	WF342.....46	
W3612.....22	WF396.....46	
W3612PG.....23	WF642.....46	
W3615.....22	WFF342.....46	
W3618.....22	WFF396.....46	
W3621.....22	WFF642.....46	
W3624.....22	WINESC1515.....43	
W3630.....15	WINSC1818.....43	
W3636.....16	WR3315.....24	
W3642.....17	WR3324.....24	



Pair Your Kitchen or Bathroom  
with more from some of our AMAZING suppliers.

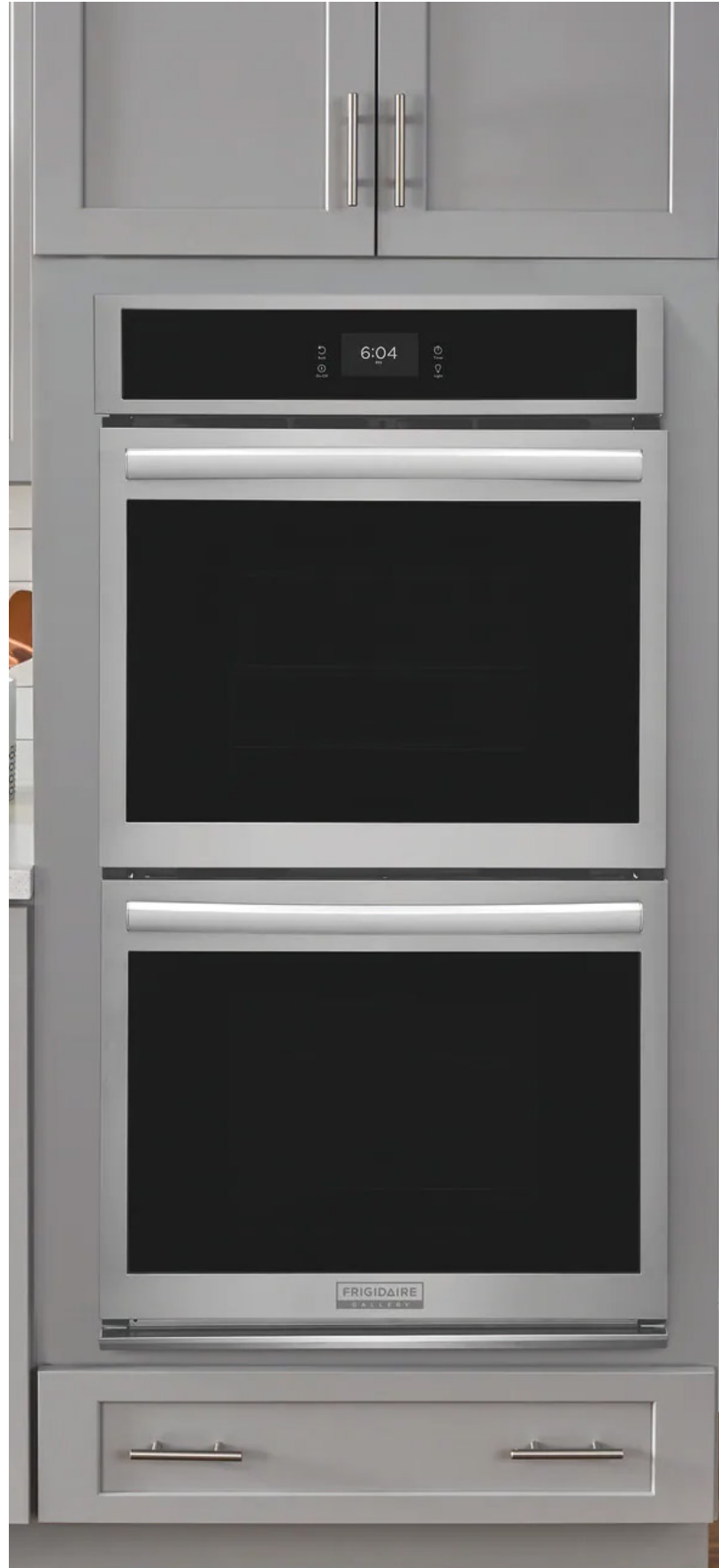



**MANUFACTURING  
HERITAGE HARDWOODS**

4227 Whiting Rd.  
Marshall, VA 20115  
(540) 364-4321

**MARYLAND**

9327-A Washington Blvd N  
Laurel, MD 20723  
(703) 256-5800

**KNOXVILLE**

6602 Deanne Hill Dr.  
Knoxville, TN 37921  
(865) 558-3599

**ATLANTA**

1451 Cobb Industrial Dr.  
Marietta, GA 30066  
(770) 428-9900

**RICHMOND**

3010 Impala Pl.  
Henrico, VA 23228  
(804) 553-1997

**CHARLOTTE**

3300-H Woodpark Blvd.  
Charlotte, NC 28206  
(704) 598-7272

**JACKSONVILLE**

1720 Lewis Industrial Dr., Suite 2  
Jacksonville, FL 32254  
(904) 786-8314

**TAMPA BAY**

6701 90th Ave. N.  
Pinellas Park, FL 33782  
(727) 541-6631

**FT. MYERS**

1850 Ortiz Ave., Suite 160  
Ft. Myers, FL 33905  
(239) 274-1220

**ORLANDO**

1090 Gills Dr.  
Orlando, FL 32824  
(407) 578-1300



Toll-Free: (800) 877-8551 | [amcabinets@amsupply.com](mailto:amcabinets@amsupply.com)